

PER: Sumish Azheekkalkadavil

Series

OAC

Commercial Wall Fan Heater

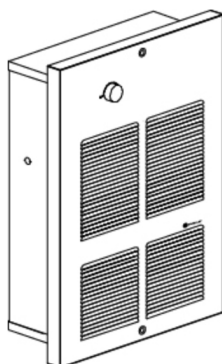

Features

Color

- Standard: white, almond.
- Optional (upcharge applicable): metallic silver, bronze, metallic charcoal, aluminum, semi-gloss black, sand.
- Custom colors available upon request.

Finish

Voltage

Construction

- Standard: epoxy/polyester powder paint.
- 120V, 208V, 240/208V, 277V, 347V, 480V, 600V, 1 or 3-phase.
- 18-gauge steel front cover.
- Bottom air outlet.

Fan

- High-limit temperature control with automatic reset.
- Closed, factory-lubricated motor.
- 160 cfm fan (single unit: 55 dBA); 2 X 160 cfm fan (double unit: 58 dBA); 3 X 160 cfm fan (triple unit: 61 dBA).
- Fan delay purges heater of residual heat.
- Durable tubular heating element with fins.
- Built-in thermostat included with control knob or tamperproof.
- 24V relay, with or without transformer available.

Heating element Control

Note: Thermostat is not included in heater with factory installed relay.

Any remote thermostat or relay must be connected to the heater control terminal block.

Installation

- Minimum clearance from the floor and adjacent walls: 10 in. (25.4 cm).
- Adaptor for surface mounting available.

Warranty

Application

- **3-year warranty against defects.**
- Apartment building, commercial building, entrance way, stairwell, garage.

Project :	Engineering seal
Consulting Engineer :	
Electrical Contractor :	
Distributor : B-Safe Electric Ltd-Glenview School Gym	
Date : 2024-10-09	
Manufacturer Contact : Meenabahen Nepalee	

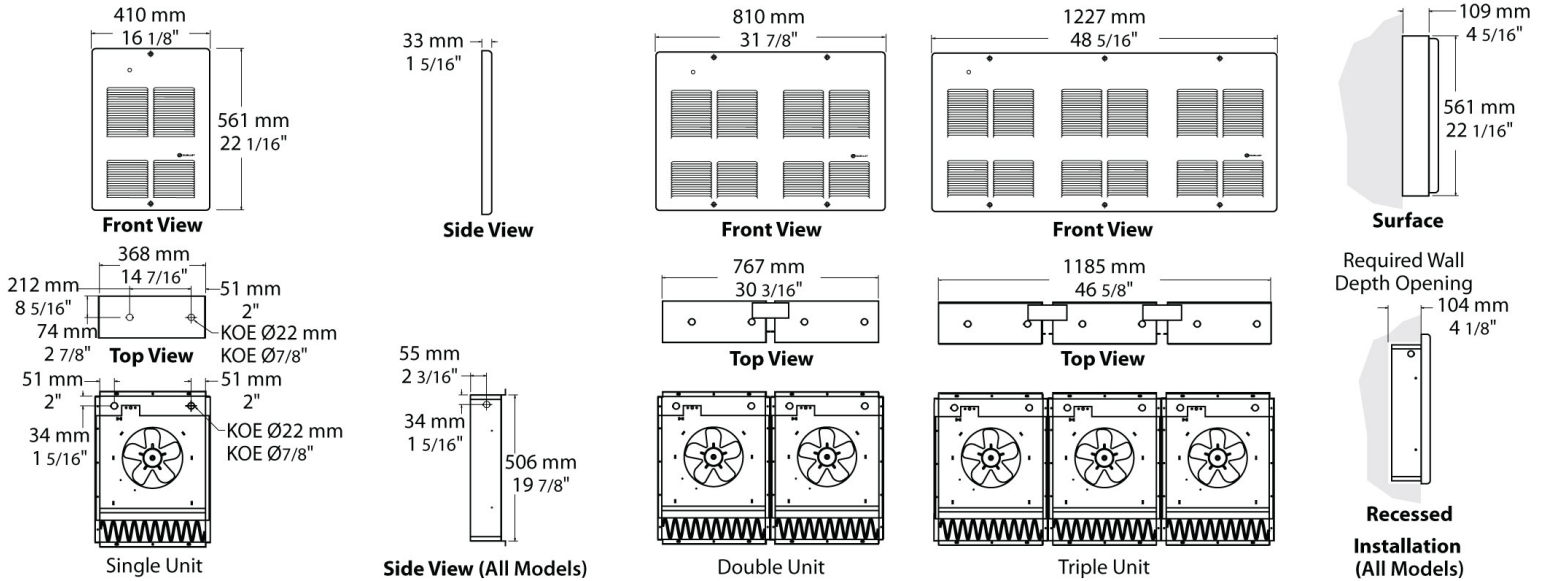

Qty	Tag	Product	Volts	Watts	Phases	Length	Description	Colour
1		OAC02000BL-RT-T	240	2000	1	0410mm	Commercial wall fan heater 2000/1500W 240/208V 1ph white, 24V relay c/w transfo., stat 1P	BL



This review by DEI Consulting Engineers Inc. is for the sole purpose of ascertaining conformance with the general design concept. This review shall not mean that DEI Consulting Engineers Inc. approves the detail design inherent in the shop drawings, responsibility for which shall remain with the contractor submitting same, and such review shall not relieve the contractor of his responsibility for errors or omissions in the shop drawings or his responsibility for meeting all requirements of the construction and contract documents.

☐ Reviewed ☒ Reviewed As Noted
☐ Not Reviewed ☐ Revise and Resubmit

PROVIDE WHITE FINISH AS PER ARCHITECT/BOARD.

Project :	Engineering seal
Consulting Engineer :	
Electrical Contractor :	
Distributor : B-Safe Electric Ltd-Glenview School Gym	
Date : 2024-10-09	
Manufacturer Contact : Meenabahen Nepalee	

Series

OAS

Commercial Industrial Suspended Unit Heater

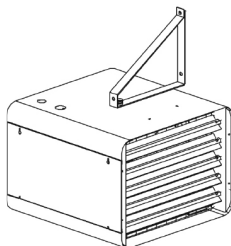

Features

Color Finish Voltage

Construction

Fan

Heating element

Control

Installation

- Standard: almond.
- Standard: epoxy/polyester powder paint.
- 208V, 240V, 277V, 347V, 480V, 600V, 1 or 3-phase.
- Some units may be field converted from 3 to 1-phase.
- 18 and 20-gauge steel.
- Adjustable louvers to direct air flow.
- High-limit temperature control with automatic reset.
- Totally enclosed factory-lubricated ball bearing motor (except for 15 to 25kW at 208/240V).
- 58 dBA fan (2 to 10kW), 67 dBA fan (15 to 30kW) and 77 dBA fan (40 to 60kW).
- Thermally-protected motor mounted in cold compartment.
- Fan delay purges heater of residual heat.
- Tubular heating elements; stainless steel (2 to 10kW); finned steel (15 to 60kW).
- Concentric disposition of heating elements.
- Factory sealed element upon request.
- Factory-installed contactor and 240/208V control circuit standard (with transformer if necessary).
- 24V relay, with or without transformer available.
- 120V control circuit available.
- Built-in thermostat available.

Ouellet highly recommends to use a wall thermostat for greater comfort.

Any remote thermostat or relay must be connected to the heater control terminal block.

- Not for residential use in the United States.
- Horizontal mounting:
 - 2 to 30kW: wall or ceiling using the supplied brackets which allow 360° rotation.
 - 40 to 60kW: ceiling only secured by the supplied 4 hooks of suspension.
- Vertical mounting (except option -MD):
 - 2 to 60kW: using 4 threaded rods 1/2 in. X 13 UNC (not included).
- Diffuser cones available (except option -MD).
- Maximum recommended height (horizontal): 2 to 10kW: 8 ft. (2.4 m), 15 to 30kW: 10 ft. (3 m), 40 to 60kW: 15 ft. (4.5 m).
- Protective screen allows minimum horizontal mounting height:
 - Canada 2 to 30 kW: 24 in. (610 mm), 40 to 60kW: 8 ft. (2.4 m).
 - United States 2 to 30 kW 6 ft. (1.8 m), 40 to 60kW: 8 ft. (2.4 m).
- 30 °C (85 °F) maximum operating ambient temperature.
- **3-year warranty against defects.**
- Commercial hall, warehouse, stairwell, factory.

Warranty Application

Project :	Engineering seal
Consulting Engineer :	
Electrical Contractor :	
Distributor : B-Safe Electric Ltd-Glenview School Gym	
Date : 2024-10-09	
Manufacturer Contact : Meenabahen Nepalee	

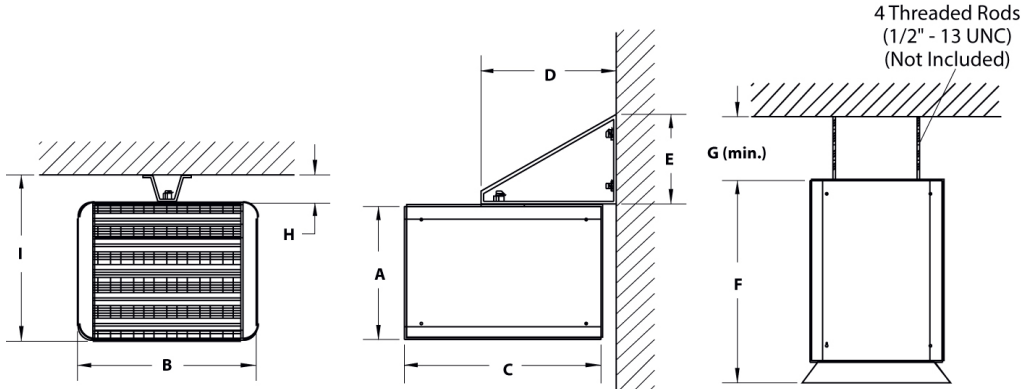

	2 to 10kW		15 to 30kW		40 to 60kW	
	mm	in.	mm	in.	mm	in.
A	309	12 1/8	444	17 1/2	585	23
B	419	16 1/2	556	21 7/8	641	25 1/4
C	432	17	572	22 1/2	870	34 1/4
D	357	14 1/16	470	18 1/2	-	-
E	290	11 7/16	407	16	-	-
F	490	19 5/16	630	24 13/16	924	36 3/8
G	305	12	305	12	305	12
H	123	4 7/8	148	5 13/16	305	12
I	428	16 7/8	592	23 5/16	890	35
Weight	kg	lb	kg	lb	kg	lb
	20	45	39	85	68	150

Qty	Tag	Product	Volts	Watts	Phases	Length	Description	Colour
1		OAS05008AM-RT-T	208	5000	1		Commercial industrial suspended unit heater 5000W 208V 1ph almond, 24V relay c/w transfo., stat 1P	AM



This review by DEI Consulting Engineers Inc. is for the sole purpose of ascertaining conformance with the general design concept. This review shall not mean that DEI Consulting Engineers Inc. approves the detail design inherent in the shop drawings, responsibility for which shall remain with the contractor submitting same, and such review shall not relieve the contractor of his responsibility for errors or omissions in the shop drawings or his responsibility for meeting all requirements of the construction and contract documents.

☒ Reviewed
 ☐ Reviewed As Noted
☐ Not Reviewed
 ☐ Revise and Resubmit

Project :	Engineering seal
Consulting Engineer :	
Electrical Contractor :	
Distributor : B-Safe Electric Ltd-Glenview School Gym	
Date : 2024-10-09	
Manufacturer Contact : Meenabahen Nepalee	

Series

OFM

Standard Baseboard Heater

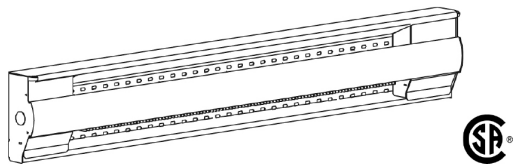

Features

Color

- Standard: white, almond.
- Optional (upcharge applicable): metallic silver, bronze, metallic charcoal, aluminum, semi-gloss black, sand.
- Custom colors available upon request.

Finish

- Standard: epoxy/polyester powder paint.
- May be repainted with any interior paint.

Voltage

- 120V, 208V, 240/208V, 277V, 347V, 480V, 600V, 1-phase.

Construction

- 20-gauge steel connection box.
- 22-gauge steel body.
- 20-gauge steel front panel.
- Rounded upper corners.

Heating element

- Linear high-limit temperature control with automatic reset.
- Stainless steel tubular heating element with aluminum fins.
- Floating heating element on high-temperature nylon bushings reducing expansion noises.

Watt density

- Average standard watt density of 275W/ft.
- Average low watt density of 200W/ft.

Control

- Built-in electronic thermostat installed in the right-hand junction box only. Only compatible with devices manufactured after 14-10-2019.
- Built-in thermostat kit can be installed at either end.
- Baseboard section with built-in electronic thermostat can be installed at left end only (240V only).
- Built-in relay kit fits in the right end box only.
- A compartment for low voltage connections (located directly under the junction box) facilitates the installation of low voltage relay in electric baseboard.

Ouellet highly recommends to use an electronic wall thermostat for greater comfort.

Installation

- Installation directly on the floor.
- Connection box at both ends of the heater.
- Single-screw built-in wire holder.
- Optional kit for installing an AC90 type electrical cable (BX).
- Raceway for ease of installation.
- Two rows of mounting holes spaced on 1 in. (25.4 mm) intervals for ease of installation.
- Variety of accessories available for wall-to-wall installation.

Warranty

- **5-year warranty against defects.**
- **Heating element has a lifetime warranty for the initial end user.**

Application

- Kitchen, living room, family room, bedroom, bay window, basement.

Project :	Engineering seal
Consulting Engineer :	
Electrical Contractor :	
Distributor : B-Safe Electric Ltd-Glenview School Gym	
Date : 2024-10-09	
Manufacturer Contact : Meenabahen Nepalee	

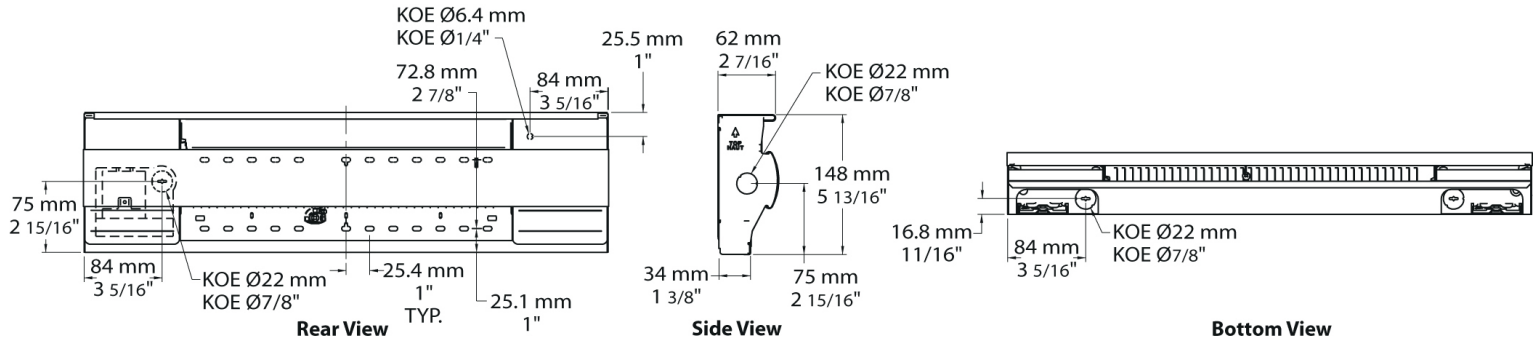

Qty	Tag	Product	Volts	Watts	Phases	Length	Description	Colour
2		OFM1008BL-RTCD-TB6CG	208	1000	1	1206mm	Standard baseboard heater 1000W 208V white, 24V relay c/w transfo., stat 1P, 1206mm	BL



This review by DEI Consulting Engineers Inc. is for the sole purpose of ascertaining conformance with the general design concept. This review shall not mean that DEI Consulting Engineers Inc. approves the detail design inherent in the shop drawings, responsibility for which shall remain with the contractor submitting same, and such review shall not relieve the contractor of his responsibility for errors or omissions in the shop drawings or his responsibility for meeting all requirements of the construction and contract documents.

☐ Reviewed ☒ Reviewed As Noted
☐ Not Reviewed ☐ Revise and Resubmit

PROVIDE WHITE FINISH AS PER ARCHITECT/BOARD.

Project :	Engineering seal
Consulting Engineer :	
Electrical Contractor :	
Distributor : B-Safe Electric Ltd-Glenview School Gym	
Date : 2024-10-09	
Manufacturer Contact : Meenabahen Nepalee	

Series

OAC

Commercial Wall Fan Heater

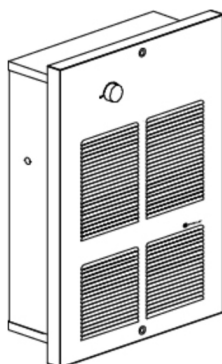

Features

Color

- Standard: white, almond.
- Optional (upcharge applicable): metallic silver, bronze, metallic charcoal, aluminum, semi-gloss black, sand.
- Custom colors available upon request.

Finish

Voltage

Construction

- Standard: epoxy/polyester powder paint.
- 120V, 208V, 240/208V, 277V, 347V, 480V, 600V, 1 or 3-phase.
- 18-gauge steel front cover.
- Bottom air outlet.

Fan

- High-limit temperature control with automatic reset.
- Closed, factory-lubricated motor.
- 160 cfm fan (single unit: 55 dBA); 2 X 160 cfm fan (double unit: 58 dBA); 3 X 160 cfm fan (triple unit: 61 dBA).
- Fan delay purges heater of residual heat.
- Durable tubular heating element with fins.
- Built-in thermostat included with control knob or tamperproof.
- 24V relay, with or without transformer available.

Heating element Control

Note: Thermostat is not included in heater with factory installed relay.

Any remote thermostat or relay must be connected to the heater control terminal block.

Installation

- Minimum clearance from the floor and adjacent walls: 10 in. (25.4 cm).
- Adaptor for surface mounting available.

Warranty

Application

- **3-year warranty against defects.**
- Apartment building, commercial building, entrance way, stairwell, garage.

Project :	Engineering seal
Consulting Engineer :	
Electrical Contractor :	
Distributor : B-Safe Electric Ltd-Glenview School Gym	
Date : 2024-10-09	
Manufacturer Contact : Meenabahen Nepalee	

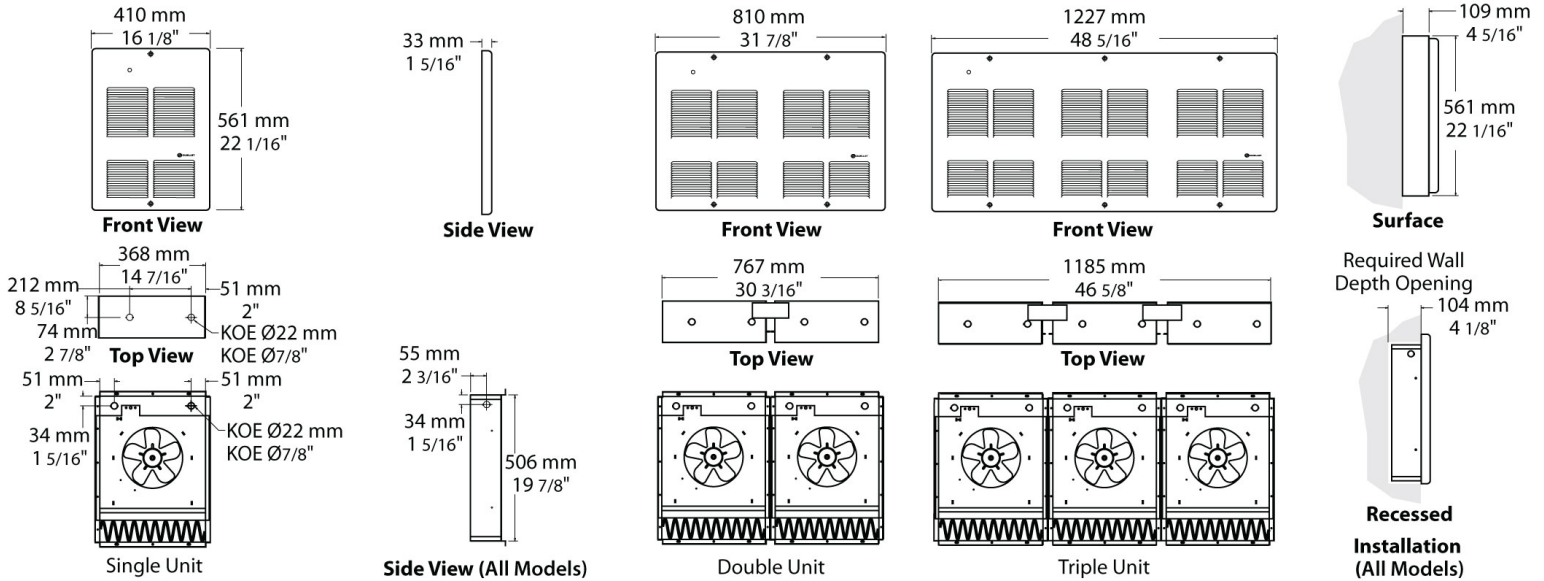

Qty	Tag	Product	Volts	Watts	Phases	Length	Description	Colour
1		OAC02000BL-RT-T	240	2000	1	0410mm	Commercial wall fan heater 2000/1500W 240/208V 1ph white, 24V relay c/w transfo., stat 1P	BL



This review by DEI Consulting Engineers Inc. is for the sole purpose of ascertaining conformance with the general design concept. This review shall not mean that DEI Consulting Engineers Inc. approves the detail design inherent in the shop drawings, responsibility for which shall remain with the contractor submitting same, and such review shall not relieve the contractor of his responsibility for errors or omissions in the shop drawings or his responsibility for meeting all requirements of the construction and contract documents.

☐ Reviewed ☒ Reviewed As Noted
☐ Not Reviewed ☐ Revise and Resubmit

PROVIDE WHITE FINISH AS PER ARCHITECT/BOARD.

Project :	Engineering seal
Consulting Engineer :	
Electrical Contractor :	
Distributor : B-Safe Electric Ltd-Glenview School Gym	
Date : 2024-10-09	
Manufacturer Contact : Meenabahen Nepalee	

Series

OAS

Commercial Industrial Suspended Unit Heater

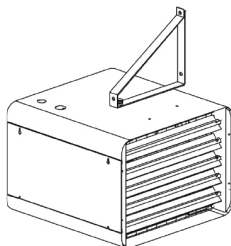

Features

Color Finish Voltage

Construction

Fan

Heating element

Control

Installation

Warranty Application

- Standard: almond.
- Standard: epoxy/polyester powder paint.
- 208V, 240V, 277V, 347V, 480V, 600V, 1 or 3-phase.
- Some units may be field converted from 3 to 1-phase.
- 18 and 20-gauge steel.
- Adjustable louvers to direct air flow.
- High-limit temperature control with automatic reset.
- Totally enclosed factory-lubricated ball bearing motor (except for 15 to 25kW at 208/240V).
- 58 dBA fan (2 to 10kW), 67 dBA fan (15 to 30kW) and 77 dBA fan (40 to 60kW).
- Thermally-protected motor mounted in cold compartment.
- Fan delay purges heater of residual heat.
- Tubular heating elements; stainless steel (2 to 10kW); finned steel (15 to 60kW).
- Concentric disposition of heating elements.
- Factory sealed element upon request.
- Factory-installed contactor and 240/208V control circuit standard (with transformer if necessary).
- 24V relay, with or without transformer available.
- 120V control circuit available.
- Built-in thermostat available.

Ouellet highly recommends to use a wall thermostat for greater comfort.

Any remote thermostat or relay must be connected to the heater control terminal block.

- Not for residential use in the United States.
- Horizontal mounting:
 - 2 to 30kW: wall or ceiling using the supplied brackets which allow 360° rotation.
 - 40 to 60kW: ceiling only secured by the supplied 4 hooks of suspension.
- Vertical mounting (except option -MD):
 - 2 to 60kW: using 4 threaded rods 1/2 in. X 13 UNC (not included).
- Diffuser cones available (except option -MD).
- Maximum recommended height (horizontal): 2 to 10kW: 8 ft. (2.4 m), 15 to 30kW: 10 ft. (3 m), 40 to 60kW: 15 ft. (4.5 m).
- Protective screen allows minimum horizontal mounting height:
 - Canada 2 to 30 kW: 24 in. (610 mm), 40 to 60kW: 8 ft. (2.4 m).
 - United States 2 to 30 kW 6 ft. (1.8 m), 40 to 60kW: 8 ft. (2.4 m).
- 30 °C (85 °F) maximum operating ambient temperature.
- **3-year warranty against defects.**
- Commercial hall, warehouse, stairwell, factory.

Project :	Engineering seal
Consulting Engineer :	
Electrical Contractor :	
Distributor : B-Safe Electric Ltd-Glenview School Gym	
Date : 2024-10-09	
Manufacturer Contact : Meenabahen Nepalee	

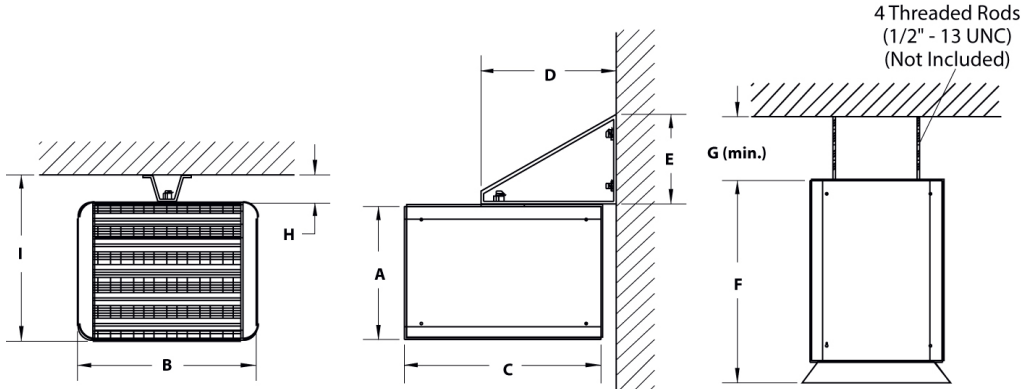

	2 to 10kW		15 to 30kW		40 to 60kW	
	mm	in.	mm	in.	mm	in.
A	309	12 1/8	444	17 1/2	585	23
B	419	16 1/2	556	21 7/8	641	25 1/4
C	432	17	572	22 1/2	870	34 1/4
D	357	14 1/16	470	18 1/2	-	-
E	290	11 7/16	407	16	-	-
F	490	19 5/16	630	24 13/16	924	36 3/8
G	305	12	305	12	305	12
H	123	4 7/8	148	5 13/16	305	12
I	428	16 7/8	592	23 5/16	890	35
Weight	kg	lb	kg	lb	kg	lb
	20	45	39	85	68	150

Qty	Tag	Product	Volts	Watts	Phases	Length	Description	Colour
1		OAS05008AM-RT-T	208	5000	1		Commercial industrial suspended unit heater 5000W 208V 1ph almond, 24V relay c/w transfo., stat 1P	AM



This review by DEI Consulting Engineers Inc. is for the sole purpose of ascertaining conformance with the general design concept. This review shall not mean that DEI Consulting Engineers Inc. approves the detail design inherent in the shop drawings, responsibility for which shall remain with the contractor submitting same, and such review shall not relieve the contractor of his responsibility for errors or omissions in the shop drawings or his responsibility for meeting all requirements of the construction and contract documents.

☒ Reviewed
 ☐ Reviewed As Noted
☐ Not Reviewed
 ☐ Revise and Resubmit

Project :	Engineering seal
Consulting Engineer :	
Electrical Contractor :	
Distributor : B-Safe Electric Ltd-Glenview School Gym	
Date : 2024-10-09	
Manufacturer Contact : Meenabahen Nepalee	

Series

OFM

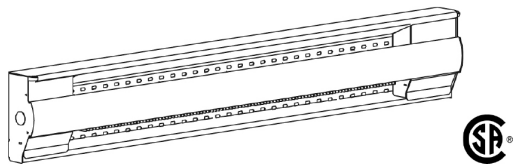
Standard Baseboard Heater

Features
Color

- Standard: white, almond.
- Optional (upcharge applicable): metallic silver, bronze, metallic charcoal, aluminum, semi-gloss black, sand.
- Custom colors available upon request.

Finish

- Standard: epoxy/polyester powder paint.
- May be repainted with any interior paint.

Voltage

- 120V, 208V, 240/208V, 277V, 347V, 480V, 600V, 1-phase.

Construction

- 20-gauge steel connection box.
- 22-gauge steel body.
- 20-gauge steel front panel.
- Rounded upper corners.

Heating element

- Linear high-limit temperature control with automatic reset.
- Stainless steel tubular heating element with aluminum fins.
- Floating heating element on high-temperature nylon bushings reducing expansion noises.

Watt density

- Average standard watt density of 275W/ft.
- Average low watt density of 200W/ft.

Control

- Built-in electronic thermostat installed in the right-hand junction box only. Only compatible with devices manufactured after 14-10-2019.
- Built-in thermostat kit can be installed at either end.
- Baseboard section with built-in electronic thermostat can be installed at left end only (240V only).
- Built-in relay kit fits in the right end box only.
- A compartment for low voltage connections (located directly under the junction box) facilitates the installation of low voltage relay in electric baseboard.

Ouellet highly recommends to use an electronic wall thermostat for greater comfort.

Installation

- Installation directly on the floor.
- Connection box at both ends of the heater.
- Single-screw built-in wire holder.
- Optional kit for installing an AC90 type electrical cable (BX).
- Raceway for ease of installation.
- Two rows of mounting holes spaced on 1 in. (25.4 mm) intervals for ease of installation.
- Variety of accessories available for wall-to-wall installation.

Warranty

- **5-year warranty against defects.**
- **Heating element has a lifetime warranty for the initial end user.**

Application

- Kitchen, living room, family room, bedroom, bay window, basement.

Project :	Engineering seal
Consulting Engineer :	
Electrical Contractor :	
Distributor : B-Safe Electric Ltd-Glenview School Gym	
Date : 2024-10-09	
Manufacturer Contact : Meenabahen Nepalee	

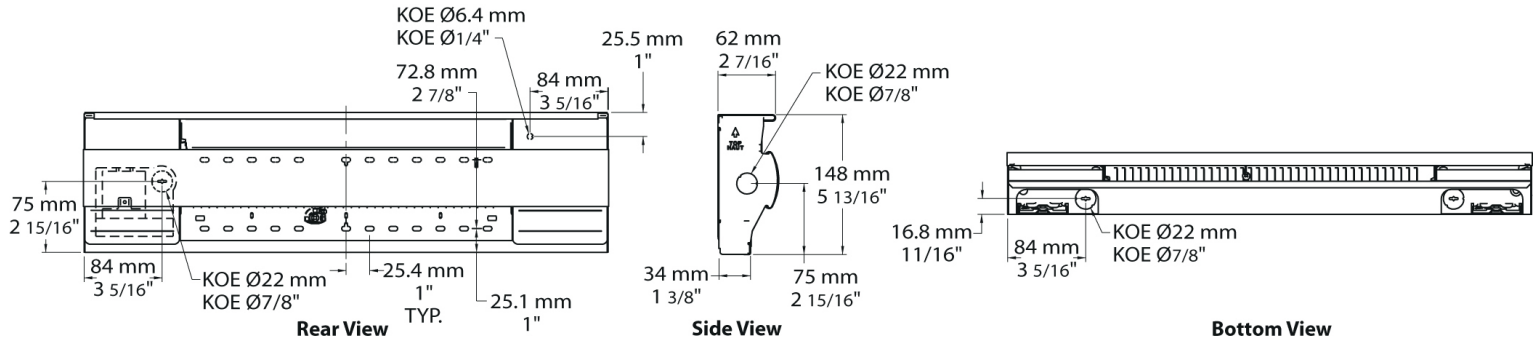

Qty	Tag	Product	Volts	Watts	Phases	Length	Description	Colour
2		OFM1008BL-RTCD-TB6CG	208	1000	1	1206mm	Standard baseboard heater 1000W 208V white, 24V relay c/w transfo., stat 1P, 1206mm	BL



This review by DEI Consulting Engineers Inc. is for the sole purpose of ascertaining conformance with the general design concept. This review shall not mean that DEI Consulting Engineers Inc. approves the detail design inherent in the shop drawings, responsibility for which shall remain with the contractor submitting same, and such review shall not relieve the contractor of his responsibility for errors or omissions in the shop drawings or his responsibility for meeting all requirements of the construction and contract documents.

☐ Reviewed ☒ Reviewed As Noted
☐ Not Reviewed ☐ Revise and Resubmit

PROVIDE WHITE FINISH AS PER ARCHITECT/BOARD.

Project :	Engineering seal
Consulting Engineer :	
Electrical Contractor :	
Distributor : B-Safe Electric Ltd-Glenview School Gym	
Date : 2024-10-09	
Manufacturer Contact : Meenabahen Nepalee	



Submittal Records

Architect: Snyder Architects Inc.	Date: 2024-07-24
Attention: Amit Patel, Anil Gokarn, Avinash Garde, Mike Wilding, Roberto Vasquez, Jamie Leach	Project: Gymnasium Addition at Glenview PS
Subcontractor: B-Safe Electric	Shop Drawings Electrical

Copies	Title /Description	# Pages
1	Panel & Heater	9

Method of Delivery: Electronic

The Architect's review is for the sole purpose of ascertaining conformance with the general design concept and for the general arrangement. This review shall not mean approval of the detail design inherent in the shop drawings, responsibility for which shall remain with the Contractor and such review shall not relieve the Contractor of their responsibility for errors or omissions in the shop drawings or of their responsibility for meeting all requirements of the Contract Documents. The Contractor is responsible for dimensions to be confirmed and correlated at the job site, for information that pertains solely to fabrication processes, quantities or to techniques of construction and installation and for coordination of related work.

sn/der
architects

Date Aug 26 2024
 By AP
 Proj. No. 2314
 No exceptions taken
 Comply with notations ✓
 Revise & Resubmit
 Not reviewed



5080 Timberlea Blvd. Unit #1
Mississauga, Ontario
L4W 4M2
Phone: 905-872-7233
Fax: 905-624-6012

Commercial

Industrial

Plant Maintenance

Date: Jul 23, 2024

Shop Drawing Transmittal

To: Golden Gate Contracting

Project Name: Gymnasium Addition at Glenview P S

Project No: #12402

Submittal drawings issued for:

☒ For Approval

☐ For Record / Info Only

Copies	Supplier	Description
	Siemens	42CCT 120/208v Panelboard 1
	Ouellet	ACG02000BL-RT-T
	Ouellet	ASG05008AM-RT-T
	Ouellet	PEG1008BL-RTCD-T1CG
Notes:	*MATERIAL ON HOLD PENDING APPROVAL AND RELEASE *	

PER: Sumish Azheekkalkadavil

Bill of Material Summary

Quote No: rosekx000_05312400_00_00_M00

Line#: 20000

Qty: 1

Designation: PANEL G

Overall Configuration for P1 panel:

42 CCTs Tin Plated Copper (STD) Top Entry
120/208V 3PH 4W 125A SC=10 KA Surface Mounting

Tub : DSB52044
Trim : S44B
Interior : PlC42ML125CTST

Main Device: MLO
Mechanical Aluminum 350MCM
(1) #6 awg to 350 kcmil (Al/Cu)

Branch Devices:

14 X BL 1 Pole 15A (B115)
4 X BLF 1 Pole 15A (BF115A)
3 X BL 2 Pole 15A (B215)
1 X BL 2 Pole 30A (B230)
14 X BL 1 Pole 20A (B120)

Specifications:

Enclosure type: Type 2
Copper Ground Bus 44 Connections
Subfeed Area Provided

Modifications:

Number Strips 1 To 42 Cct's

Std Lead Time = 30 Days

SC : Abbreviation for Short Circuit Level

Note: BL,BLE,BLF,BLH,BLHF or HBL are new Bolt-on Breaker Type(not BlueLine Type)

Panel Box Size: Height: 44.0" Width: 20.0" Depth: 5.75"



MECHANICAL | ELECTRICAL | AQUATIC

This review by DEI Consulting Engineers Inc. is for the sole purpose of ascertaining conformance with the general design concept. This review shall not mean that DEI Consulting Engineers Inc. approves the detail design inherent in the shop drawings, responsibility for which shall remain with the contractor submitting same, and such review shall not relieve the contractor of his responsibility for errors or omissions in the shop drawings or his responsibility for meeting all requirements of the construction and contract documents.

☒ Reviewed☐ Reviewed As Noted☐ Not Reviewed☐ Revise and Resubmit

125A MLO 3Ø 4W

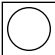
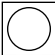
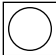
					
1	◀	BL, 2P, 30A		▶	2
3	◀		BL, 2P, 15A	▶	4
5	◀	BL, 2P, 15A		▶	6
7	◀		BL, 2P, 15A	▶	8
9	◀	BL, 1P, 20A	BL, 1P, 20A	▶	10
11	◀	BL, 1P, 20A	BL, 1P, 20A	▶	12
13	◀	BL, 1P, 20A	BL, 1P, 20A	▶	14
15	◀	BL, 1P, 20A	BL, 1P, 20A	▶	16
17	◀	BL, 1P, 20A	BL, 1P, 20A	▶	18
19	◀	BL, 1P, 20A	BL, 1P, 20A	▶	20
21	◀	BL, 1P, 20A	BL, 1P, 20A	▶	22
23	◀	BLF, 1P, 15A	BLF, 1P, 15A	▶	24
25	◀	BLF, 1P, 15A	BLF, 1P, 15A	▶	26
27	◀	BL, 1P, 15A	BL, 1P, 15A	▶	28
29	◀	BL, 1P, 15A	BL, 1P, 15A	▶	30
31	◀	BL, 1P, 15A	BL, 1P, 15A	▶	32
33	◀	BL, 1P, 15A	BL, 1P, 15A	▶	34
35	◀	BL, 1P, 15A	BL, 1P, 15A	▶	36
37	◀	BL, 1P, 15A	BL, 1P, 15A	▶	38
39	◀	BL, 1P, 15A	BL, 1P, 15A	▶	40
41	◀	PROV	PROV	▶	42
Subfeed Area Provided					

Panel Designation: PANEL G

Line#: 20000 Qty: 1

Panel type: # of circuits: Catalog #: Enclosure type: Voltage: System: (IC) Series Combination: (IC) Branch Breakers: Main bus: Cables entry: Panel mounting: Service entrance: Main connections sizes: Main type: Sub-feed type: Ground bus: Neutral: Trim & door finish: Enclosure finish:	P1 42 ccts P1C42ML125CTST Type 2 120/208V 3PH 4W None 10KA 125A Tin Plated Copper (STD) Top Surface None (1) #6 awg to 350 kcmil (Al/Cu) MLO on Top None Copper Ground Bus 44 Connections Standard Painted grey ASA-61 (std) Galvanized steel unpainted
---	---

Breaker listing:
No Sub Device
14 X BL 1 Pole 15A
4 X BLF 1 Pole 15A
3 X BL 2 Pole 15A
1 X BL 2 Pole 30A
14 X BL 1 Pole 20A

Modifications:
Number Strips 1 To 42 Ccts
Standard Door

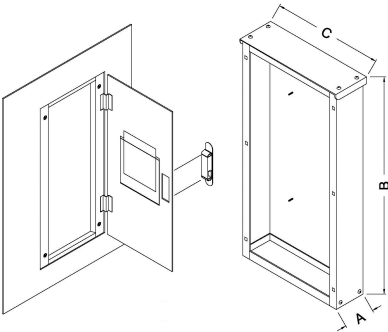

Dimensions : A=5.75" [146mm] B=44.00" [1118mm] C=20.00" [508mm]

Project Name GLENVIEW PUBLIC SCHOOL	Sales Order No.:	Quote No.:
	Purchase Order No.:	DATE 31May2024

Customer

Series

ACG

Commercial Wall Fan Heater

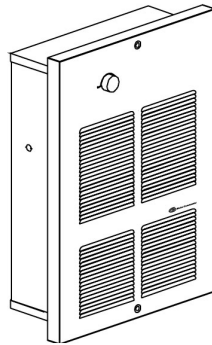

Features

Color

- Standard: white  almond.
- Optional (upcharge applicable): metallic silver, bronze, metallic charcoal, aluminum, semi-gloss black, sand.

Finish

Voltage

Construction

- Custom colors available upon request.
- Standard: epoxy/polyester powder paint.
- 120V, 208V, 240/208V, 277V, 347V, 480V, 600V, 1 or 3-phase.
- 18-gauge steel front cover.
- Bottom air outlet.

Fan

- High-limit temperature control with automatic reset.
- Closed, factory-lubricated motor.
- 160 cfm fan (single unit: 55 dBA); 2 X 160 cfm fan (double unit: 58 dBA); 3 X 160 cfm fan (triple unit: 61 dBA).

Heating element

Control

- Fan delay purges heater of residual heat.
- Durable tubular heating element with fins.
- Built-in thermostat included with control knob or tamperproof.
- 24V relay, with or without transformer available.

Note: Thermostat is not included in heater with factory installed relay.

Any remote thermostat or relay must be connected to the heater control terminal block.

Installation

- Minimum clearance from the floor and adjacent walls: 10 in. (25.4 cm).
- Surface mounting box available.

Warranty

Application

- 3-year warranty against defects.
- Apartment building, commercial building, entrance way, stairwell, garage.

Project :	Engineering seal
Consulting Engineer :	
Electrical Contractor :	
Distributor : B-Safe Electric Ltd-Glenview School Gym	
Date : 2024-07-22	
Manufacturer Contact : Meenabahen Nepalee	

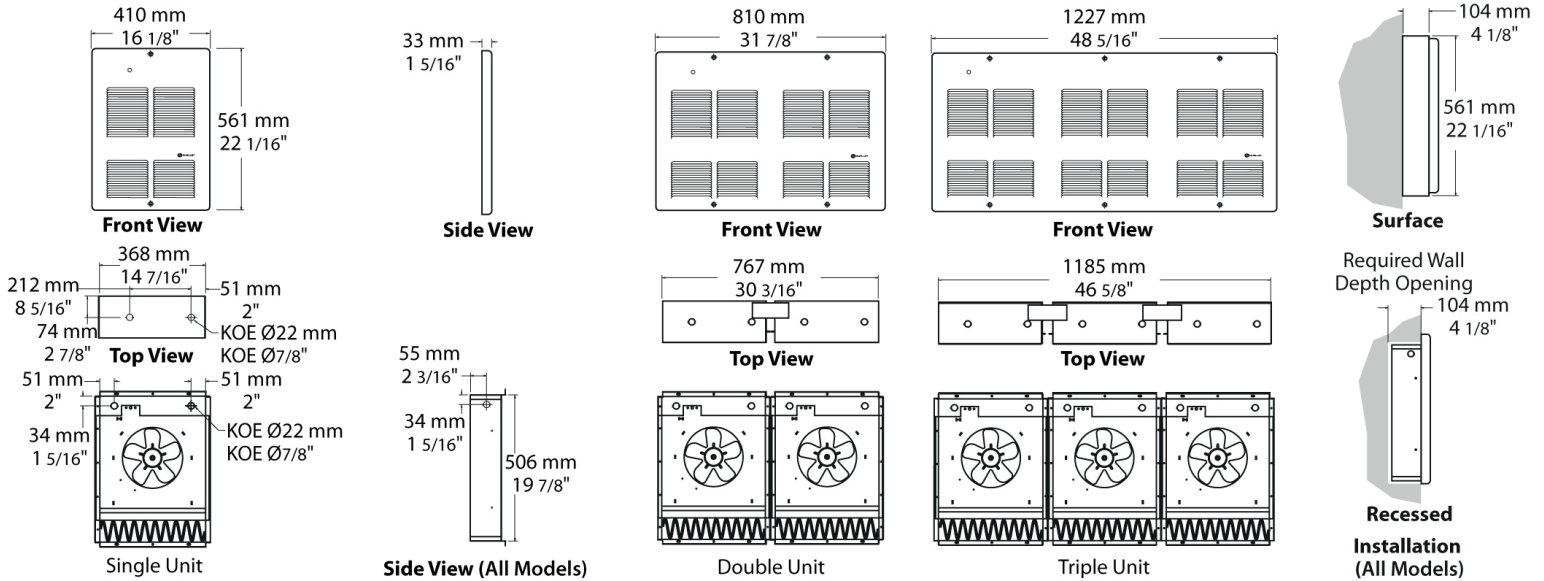

Qty	Tag	Product	Volts	Watts	Phases	Length	Description	Colour
1		ACG02000BL-RT-T	240	2000	1	0410mm	Commercial wall fan heater 2000/1500W 240/208V 1ph white, 24V relay c/w transfo., stat 1P	BL



This review by DEI Consulting Engineers Inc. is for the sole purpose of ascertaining conformance with the general design concept. This review shall not mean that DEI Consulting Engineers Inc. approves the detail design inherent in the shop drawings, responsibility for which shall remain with the contractor submitting same, and such review shall not relieve the contractor of his responsibility for errors or omissions in the shop drawings or his responsibility for meeting all requirements of the construction and contract documents.

☐ Reviewed ☒ Reviewed As Noted
☐ Not Reviewed ☐ Revise and Resubmit

Note: Colour by architect/board

Project :	Engineering seal
Consulting Engineer :	
Electrical Contractor :	
Distributor : B-Safe Electric Ltd-Glenview School Gym	
Date : 2024-07-22	
Manufacturer Contact : Meenabahen Nepalee	

Series

ASG

Commercial Industrial Suspended Unit Heater

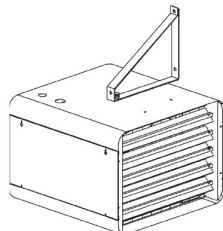

Features

Color Finish Voltage

Construction

Fan

Heating element

Control

Installation

Warranty Application

- Standard: almond.
- Standard: epoxy/polyester powder paint.
- 208V, 240V, 277V, 347V, 480V, 600V, 1 or 3-phase.
- Some units may be field converted from 3 to 1-phase.
- 18 and 20-gauge steel.
- Adjustable louvers to direct air flow.
- High-limit temperature control with automatic reset.
- Totally enclosed factory-lubricated ball bearing motor (except for 15 to 25kW at 208/240V).
- 58 dBA fan (2 to 10kW), 67 dBA fan (15 to 30kW) and 77 dBA fan (40 to 60kW).
- Thermally-protected motor mounted in cold compartment.
- Fan delay purges heater of residual heat.
- Tubular heating elements; stainless steel (2 to 10kW); finned steel (15 to 60kW).
- Concentric disposition of heating elements.
- Factory sealed element upon request.
- Factory-installed contactor and 240/208V control circuit standard (with transformer if necessary).
- 24V relay, with or without transformer available.
- 120V control circuit available.
- Built-in thermostat available.

Global Commander highly recommends to use a wall thermostat for greater comfort.

Any remote thermostat or relay must be connected to the heater control terminal block.

- Not for residential use in the United States.
- Horizontal mounting:
 - 2 to 30kW: wall or ceiling using the supplied brackets which allow 360° rotation.
 - 40 to 60kW: ceiling only secured by the supplied 4 hooks of suspension.
- Vertical mounting (except option -MD):
 - 2 to 60kW: using 4 threaded rods 1/2 in. X 13 UNC (not included).
- Diffuser cones available (except option -MD).
- Maximum recommended height (horizontal): 2 to 10kW: 8 ft. (2.4 m), 15 to 30kW: 10 ft. (3 m), 40 to 60kW: 15 ft. (4.5 m).
- Protective screen allows minimum horizontal mounting height:
 - Canada 2 to 30 kW: 24 in. (610 mm), 40 to 60kW: 8 ft. (2.4 m).
 - United States 2 to 30 kW 6 ft. (1.8 m), 40 to 60kW: 8 ft. (2.4 m).
- 30 °C (85 °F) maximum operating ambient temperature.
- **3-year warranty against defects.**
- Commercial hall, warehouse, stairwell, factory.

Project :	Engineering seal
Consulting Engineer :	
Electrical Contractor :	
Distributor : B-Safe Electric Ltd-Glenview School Gym	
Date : 2024-07-22	
Manufacturer Contact : Meenabahen Nepalee	

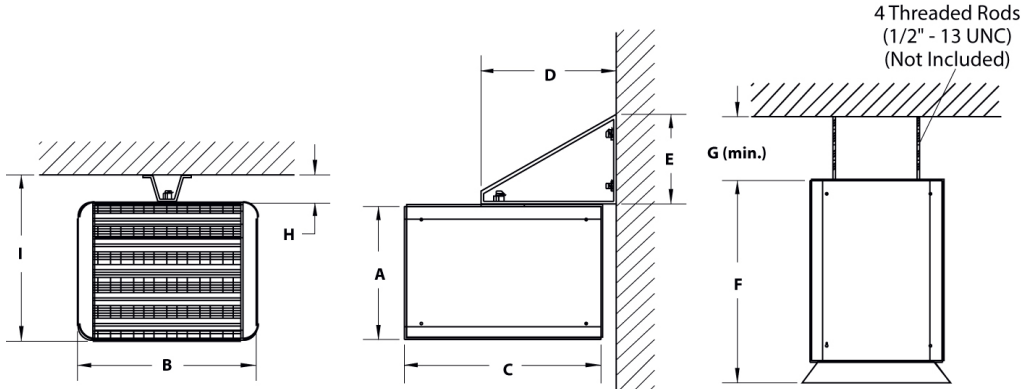

	2 to 10kW		15 to 30kW		40 to 60kW	
	mm	in.	mm	in.	mm	in.
A	309	12 1/8	444	17 1/2	585	23
B	419	16 1/2	556	21 7/8	641	25 1/4
C	432	17	572	22 1/2	870	34 1/4
D	357	14 1/16	470	18 1/2	-	-
E	290	11 7/16	407	16	-	-
F	490	19 5/16	630	24 13/16	924	36 3/8
G	305	12	305	12	305	12
H	123	4 7/8	148	5 13/16	305	12
I	428	16 7/8	592	23 5/16	890	35
Weight	kg	lb	kg	lb	kg	lb
	20	45	39	85	68	150

Qty	Tag	Product	Volts	Watts	Phases	Length	Description	Colour
1		ASG05008AM-RT-T	208	5000	1		Commercial industrial suspended unit heater 5000W 208V 1ph almond, 24V relay c/w transfo., stat 1P	AM



This review by DEI Consulting Engineers Inc. is for the sole purpose of ascertaining conformance with the general design concept. This review shall not mean that DEI Consulting Engineers Inc. approves the detail design inherent in the shop drawings, responsibility for which shall remain with the contractor submitting same, and such review shall not relieve the contractor of his responsibility for errors or omissions in the shop drawings or his responsibility for meeting all requirements of the construction and contract documents.

☒ Reviewed
 ☐ Reviewed As Noted
☐ Not Reviewed
 ☐ Revise and Resubmit

Project :	Engineering seal
Consulting Engineer :	
Electrical Contractor :	
Distributor : B-Safe Electric Ltd-Glenview School Gym	
Date : 2024-07-22	
Manufacturer Contact : Meenabahen Nepalee	

Series

PEG

Traditional Style Baseboard Heater

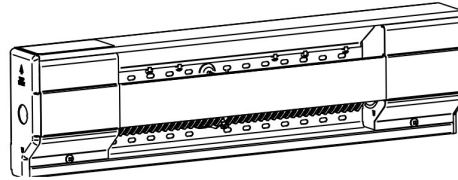

Features

Color

- Standard: white almond.
- Optional (upcharge applicable): metallic silver, bronze, metallic charcoal, aluminum, semi-gloss black, sand.
- Custom colors available upon request.

Finish

- Standard: epoxy/polyester powder paint.
- May be repainted with any interior paint.

Voltage

Construction

- 120V, 208V, 240/208V, 277V, 347V, 480V, 600V, 1-phase.
- Robust 22-gauge steel body.
- Sturdy 20-gauge steel front panel.
- Welded 20-gauge steel connection box.
- Rounded corners.

Heating element

- Linear high-limit temperature control with automatic reset.
- Stainless steel tubular heating element with aluminum fins.
- Floating heating element on high-temperature nylon bushings reducing expansion noises.

Watt density

- Average standard watt density of 275W/ft. (900W/m).
- Average low watt density of 200W/ft. (650W/m).

Control

- A wide selection of built-in controls available.
- Built-in thermostat kit can be installed at either end.
- Built-in relay kit fits in the right end box only.
- A compartment for low voltage connections (located directly under the junction box) facilitates the installation of low voltage relay in electric baseboard.

Global Commander highly recommends using an electronic wall thermostat for greater comfort and efficiency.

Installation

- Installation directly on the floor.
- No need to disassemble for electrical connection or wall attachment.
- Built-in single-screw wire holder on the back for quick connection box access from either end.
- Two rows of oval mounting holes with centering mark for ease of installation.
- Raceway and side knock-outs for baseboard interconnection.

Warranty

- 5-year warranty against defects.
- Heating element has a lifetime warranty for the initial end user.

Application

- Kitchen, living room, family room, bedroom, bay window, commercial building, office building, condo, restaurant.

Project :	Engineering seal
Consulting Engineer :	
Electrical Contractor :	
Distributor : B-Safe Electric Ltd-Glenview School Gym	
Date : 2024-07-22	
Manufacturer Contact : Meenabahen Nepalee	

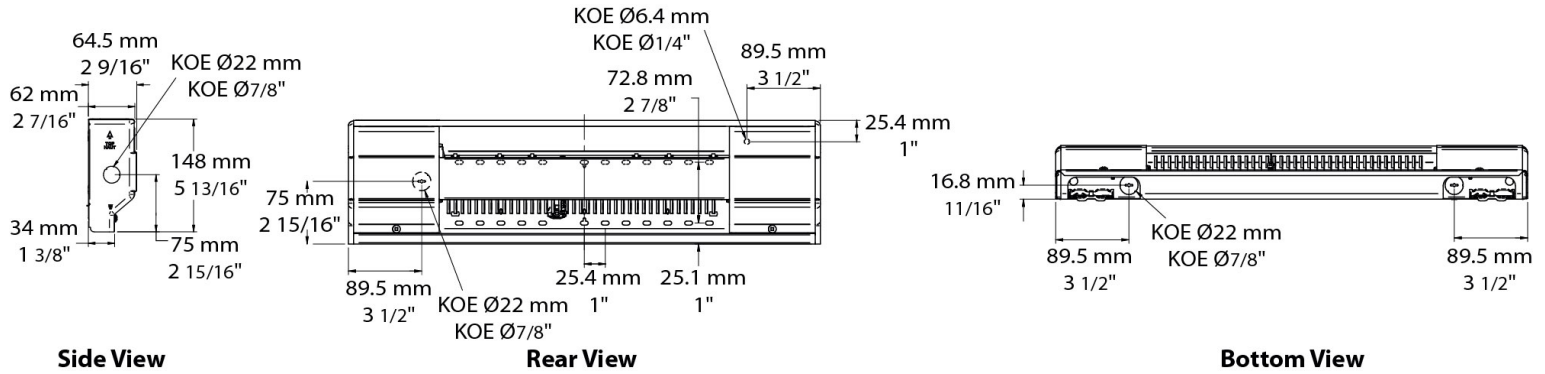

Qty	Tag	Product	Volts	Watts	Phases	Length	Description	Colour
2		PEG1008BL-RTCD-T1CG	208	1000	1	1217mm	Traditional style baseboard heater 1000W 208V white, 24V relay c/w transfo., stat 1P, 1217mm	BL



This review by DEI Consulting Engineers Inc. is for the sole purpose of ascertaining conformance with the general design concept. This review shall not mean that DEI Consulting Engineers Inc. approves the detail design inherent in the shop drawings, responsibility for which shall remain with the contractor submitting same, and such review shall not relieve the contractor of his responsibility for errors or omissions in the shop drawings or his responsibility for meeting all requirements of the construction and contract documents.

☐ Reviewed
 ☒ Reviewed As Noted
 ☐ Not Reviewed
 ☐ Revise and Resubmit

Note: Colour by architect/board

Project :	Engineering seal
Consulting Engineer :	
Electrical Contractor :	
Distributor : B-Safe Electric Ltd-Glenview School Gym	
Date : 2024-07-22	
Manufacturer Contact : Meenabahen Nepalee	