

PART FOUNDATION PLAN
SCALE: 1:100

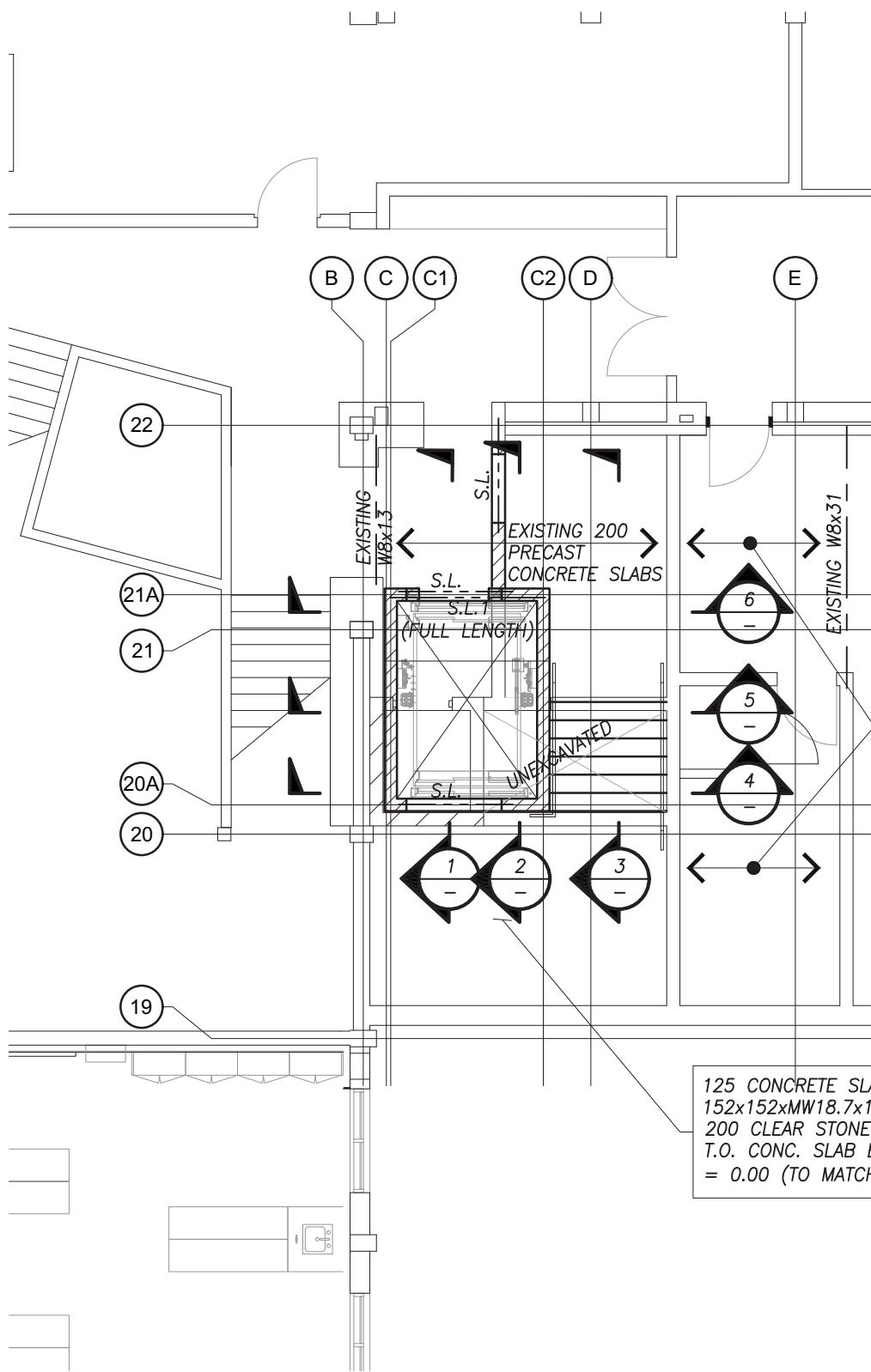

PART GROUND FLOOR FRAMING PLAN
SCALE: 1:100

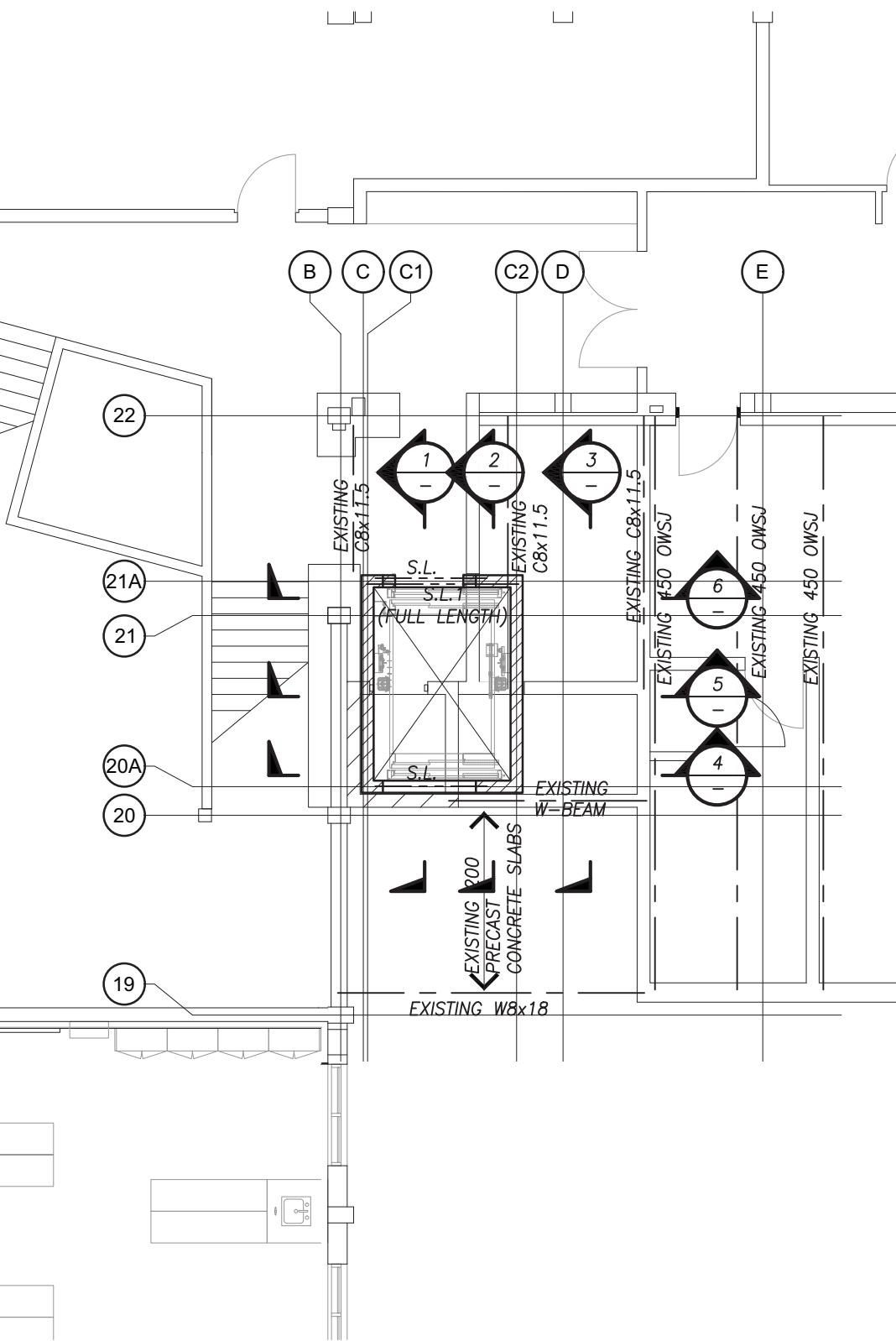

PART SECOND FLOOR FRAMING PLAN
SCALE: 1:100

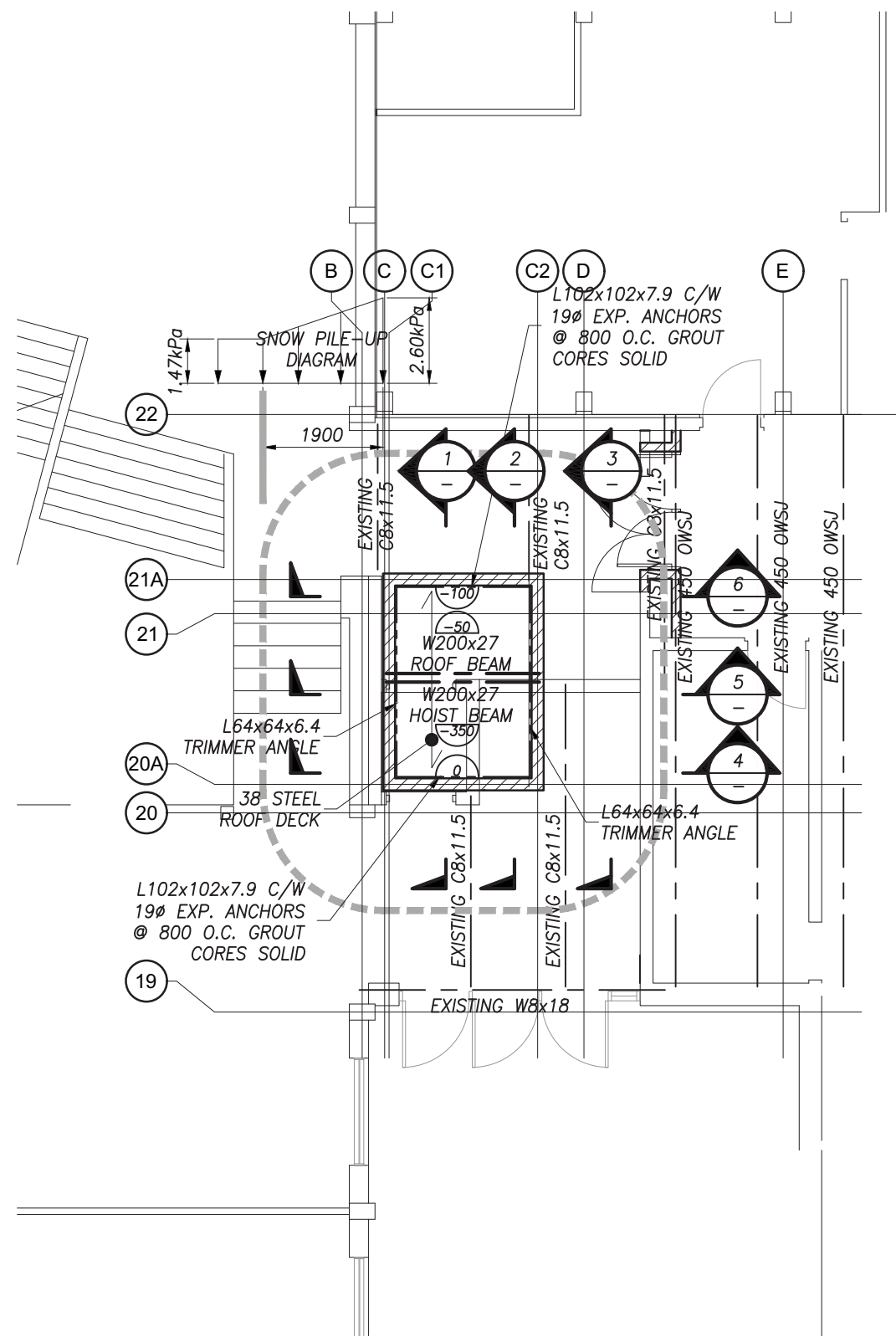

PART ROOF FRAMING PLAN
SCALE: 1:100

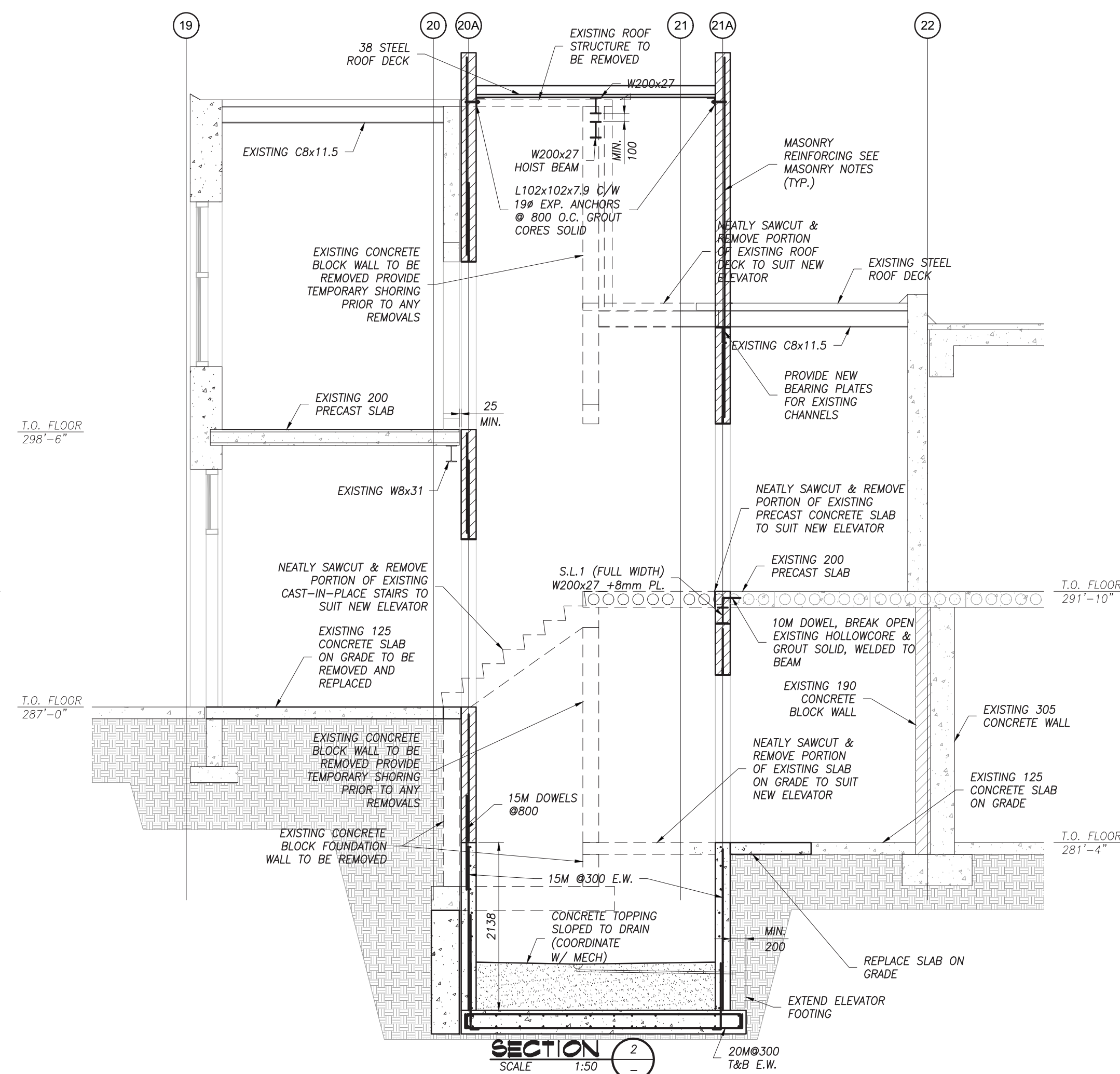
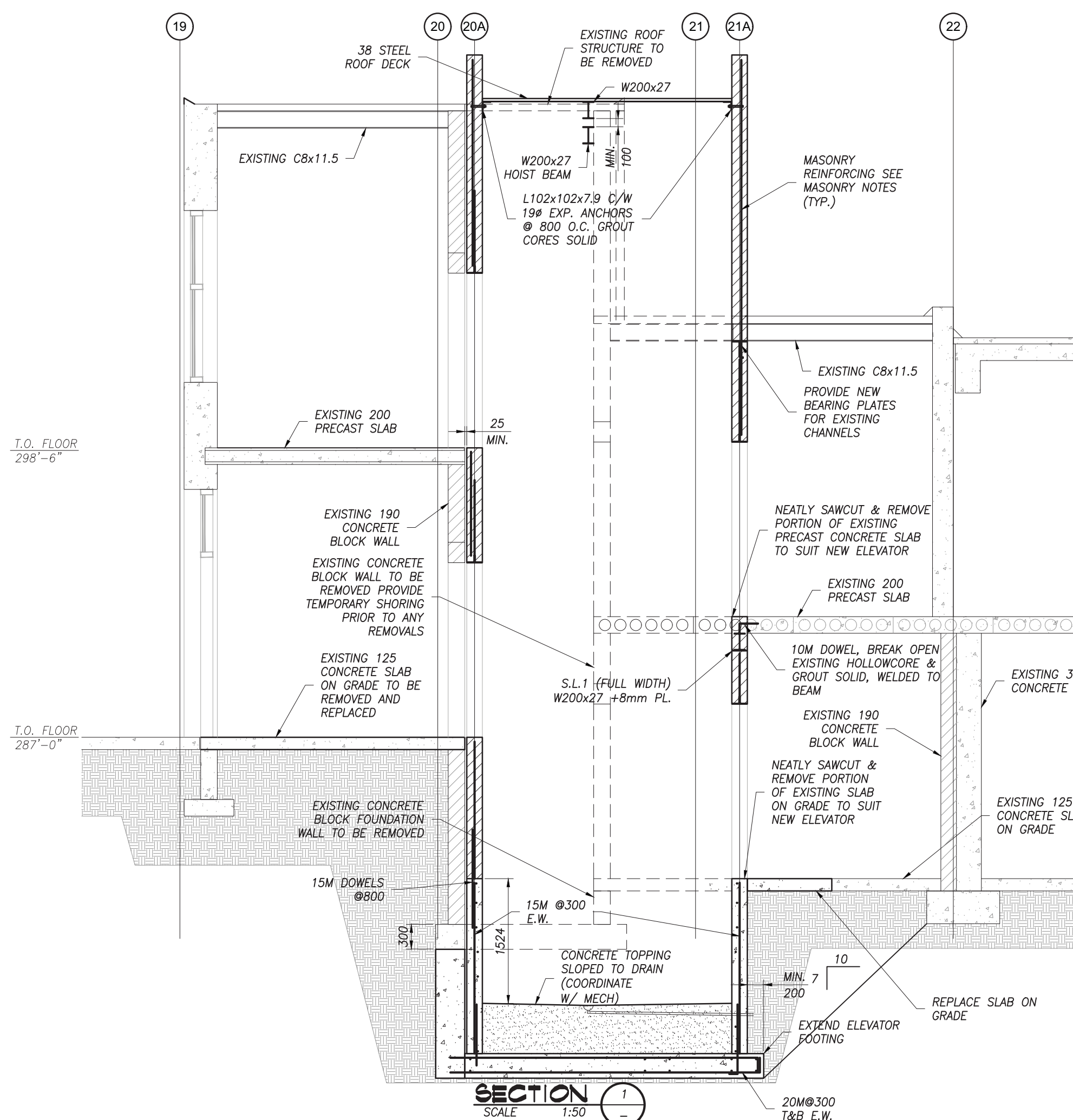
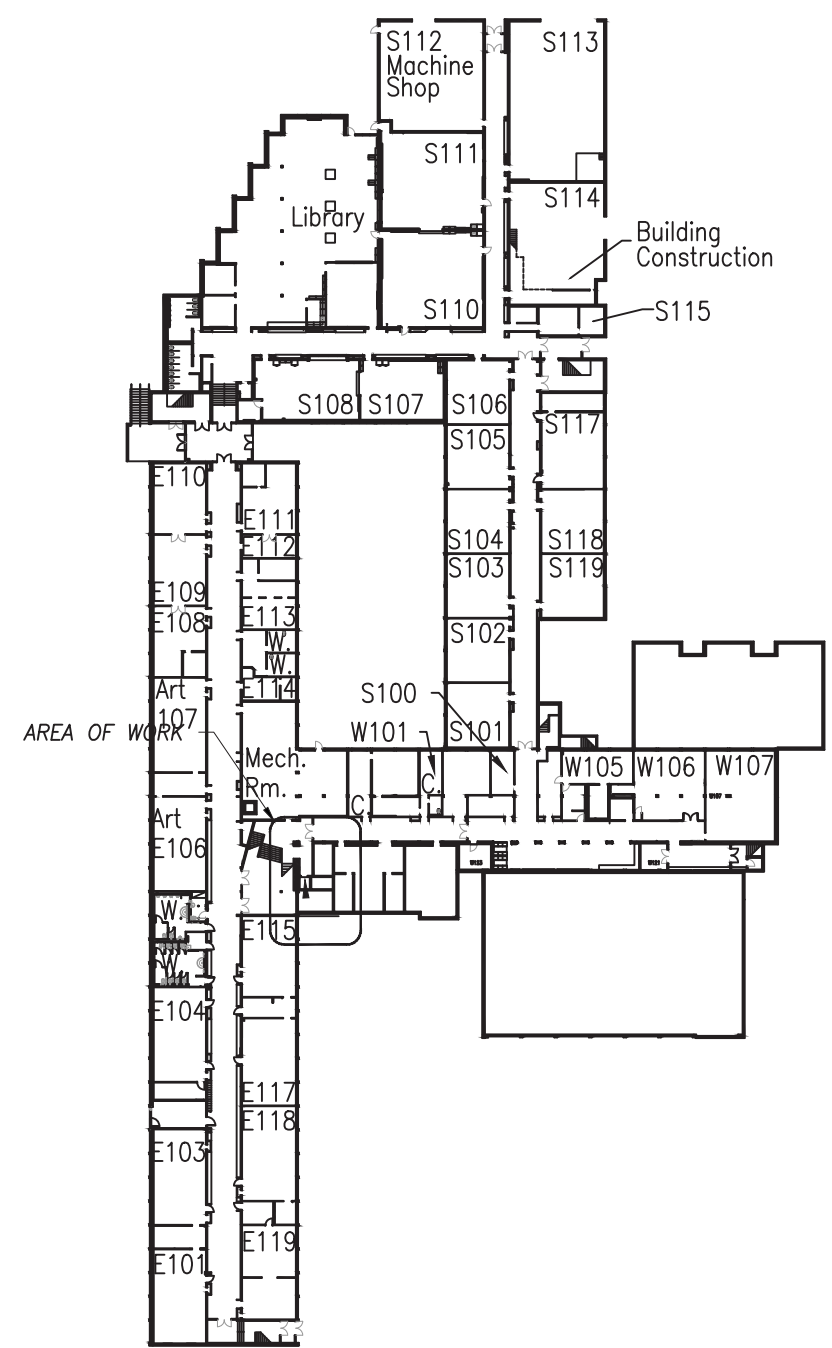

SHORING NOTES

1. ALL FRAMES AND SHORING JACKS TO BE PLUMB AND LEVEL.
 2. SHORING JACKS TO BE DESIGNED BY THE SUPPLIER FOR THE LOADS AND HEIGHTS SHOWN, INCLUDING BRACING.
 3. MAX. EXTENSION OF SCREWS/JACKS WILL BE 400mm UNLESS NOTED.
 4. SCAFFOLDING SHALL BE ERECTED IN ACCORDANCE TO C.S.A. CODE S209.1.
 5. SHORING TO REMAIN IN PLACE UNTIL BEAM AND ALL BRACING IS COMPLETELY INSTALLED.
 6. CONTRACTOR TO PREPARE AND SUBMIT FULL SHORING DRAWINGS FOR APPROVAL FOR ALL TEMPORARY SUPPORTS. PREPARED AND STAMPED BY A PROFESSIONAL ENGINEER, PRIOR TO ANY REMOVALS.
- ADDITIONAL NOTES:
- PROVIDE TEMPORARY SHORING TO STRUCTURE ABOVE PRIOR TO ANY REMOVALS.
 - EXISTING FRAMING SHOWN IS ASSUMED BASED ON SITE REVIEW AND EXISTING DRAWINGS REFERENCED IN NOTES BELOW. CONTRACTOR TO EXPOSE EXISTING STRUCTURE AND REPORT ANY DISCREPANCIES TO THE ENGINEER.

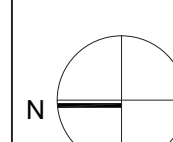
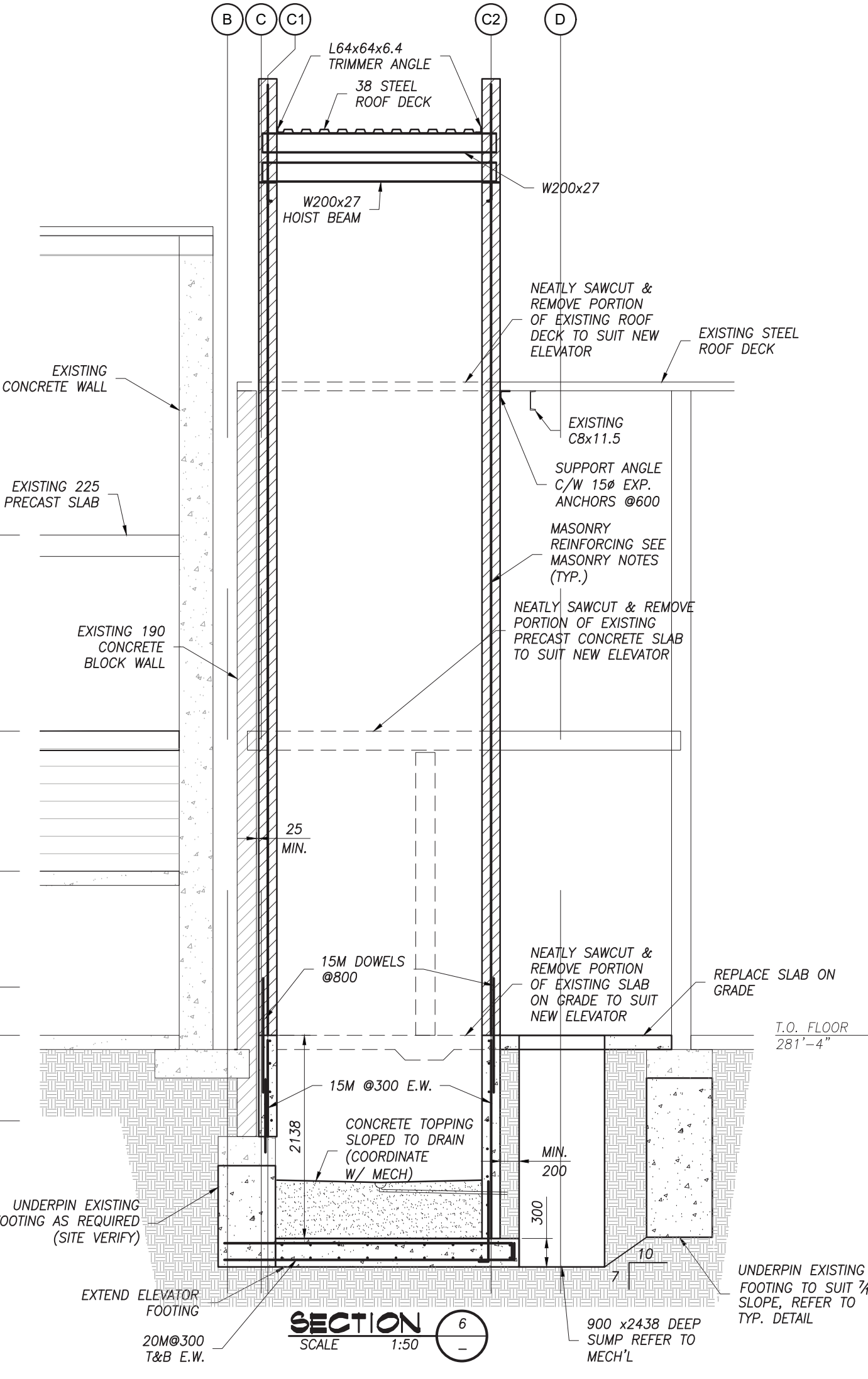
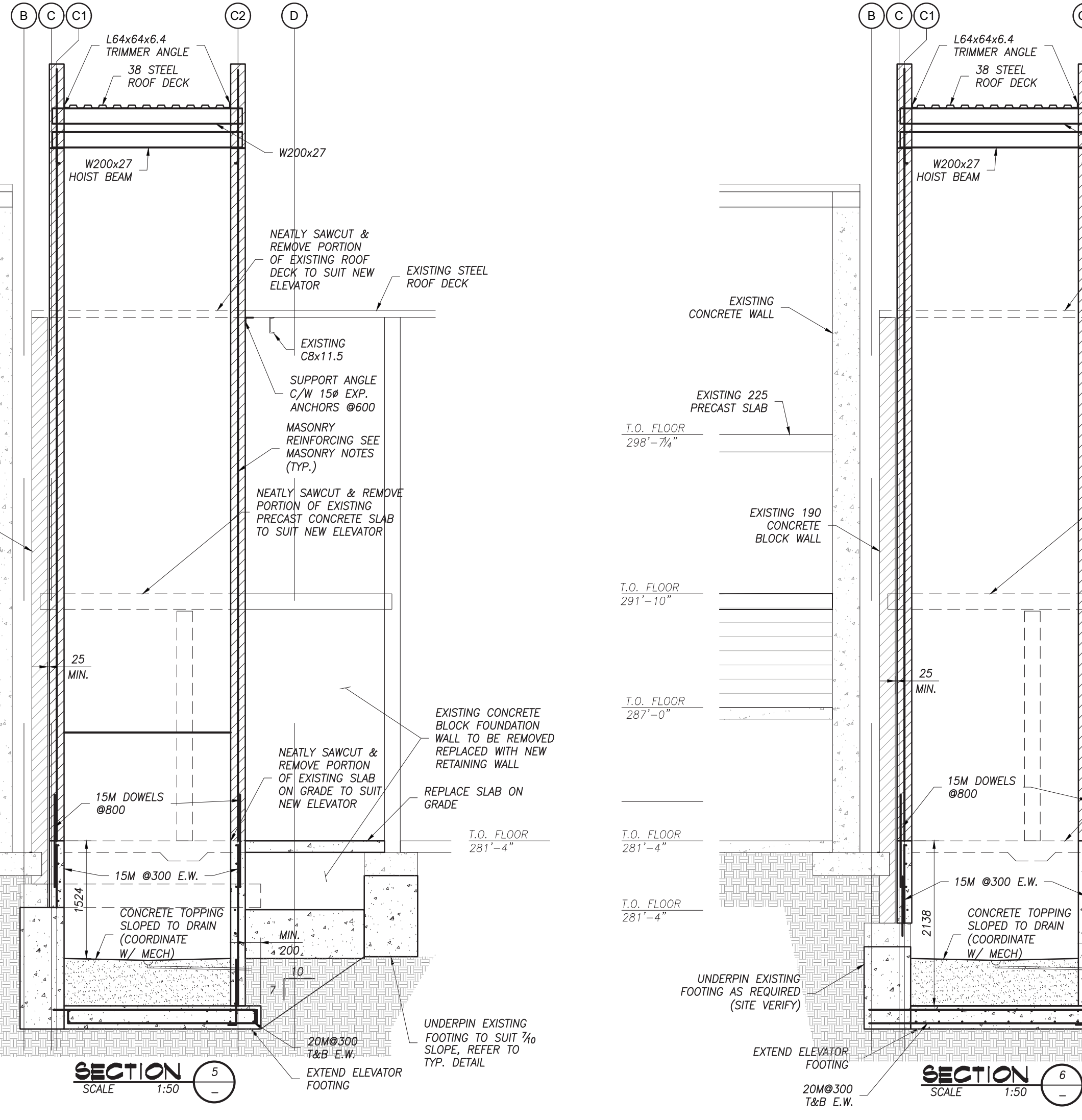
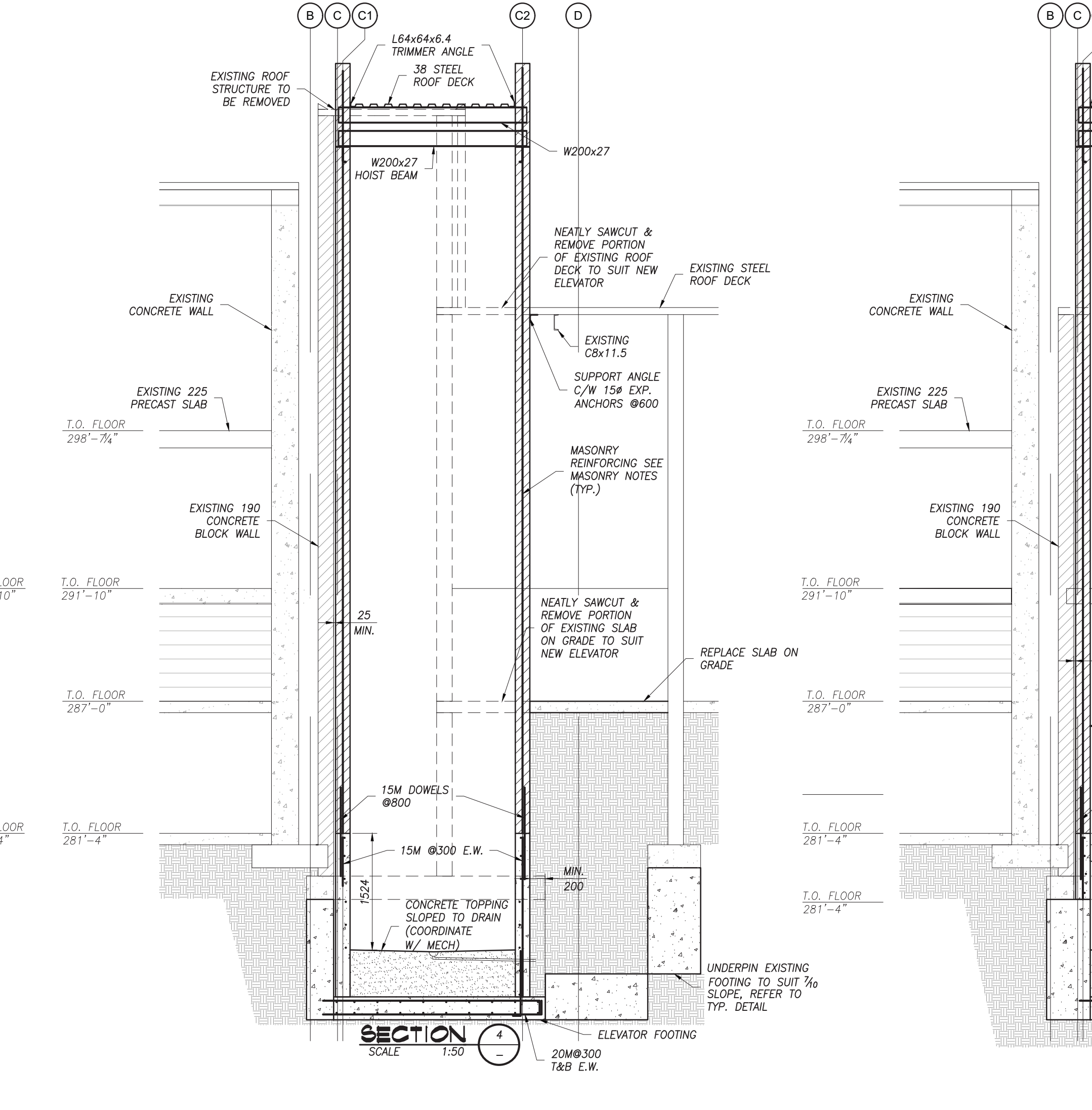
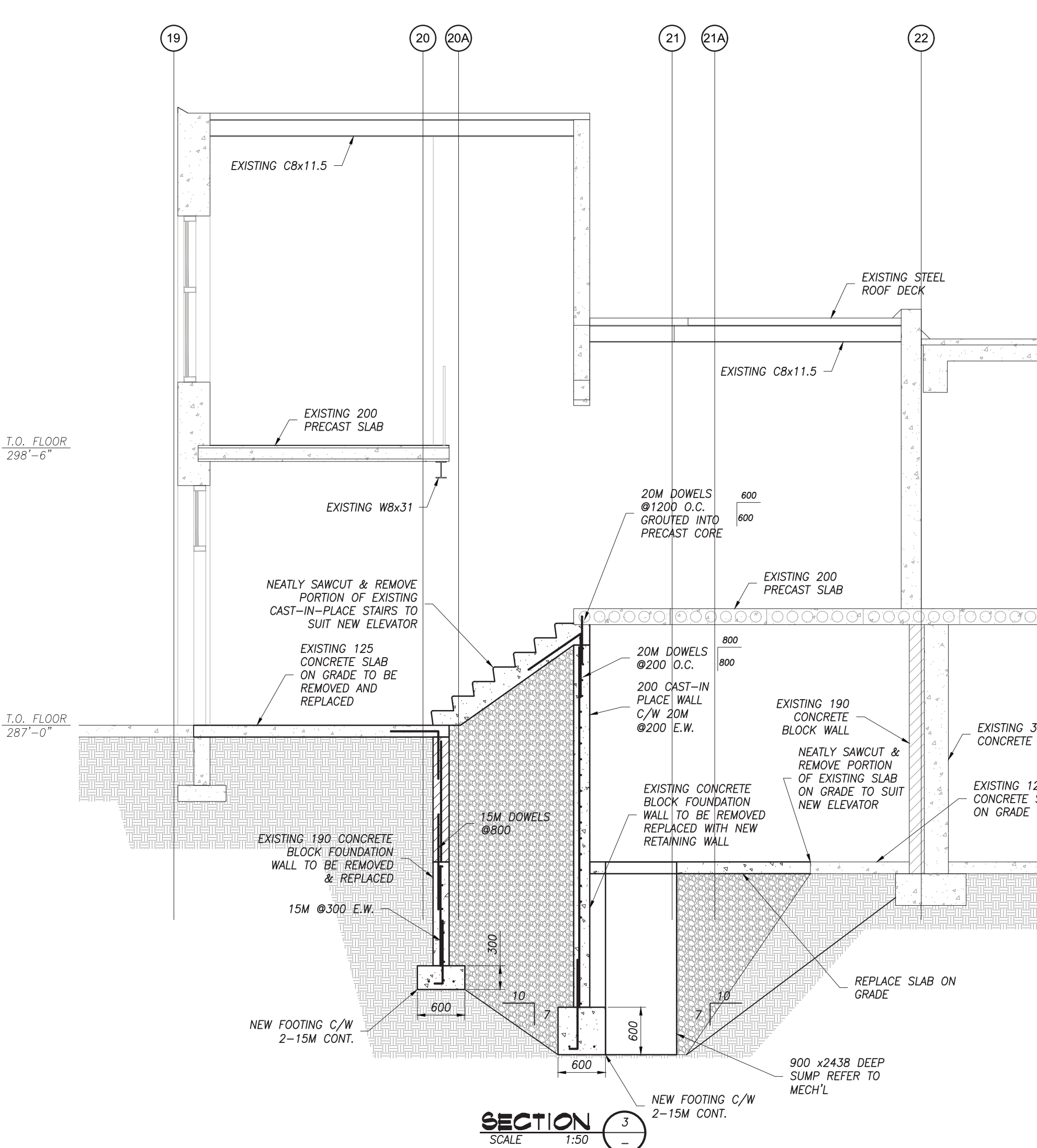

Project North

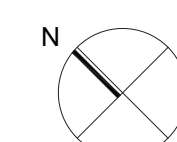

True North

No.	Revisions	Date
2	ISSUED FOR TENDER	2025-04-17
1	ISSUED FOR PERMIT	2025/04/10
No.	Issue	Date

General Contractor shall check and verify all dimensions and report all errors and omissions to the Architect. Do not scale the drawings. Drawings shall not be used for construction purposes until issued by the Architect for construction.

Drawing Title:

WEST ELEVATOR
DETAILS

Scale: AS NOTED Date: MARCH 2025

Drawn by: Checked by:

Job No. Drawing No.

2215-C

S200



