

**PROPOSED CHANGE NO. 16**

---

**To:** Golden Gate Contracting  
 16-2345 Wyecroft Rd.  
 Oakville, ON  
 L6L 6L8  
 P: 905-844-1122  
 F: 905-844-0051

**Date:** November 29, 2023  
**File:** 8.1C-01.4.03  
**Project No.:** 2005  
**Project:** Burlington Central HS Renovation  
**Trade Contract:** General Contractor

Pursuant to paragraph 6.2.1 of GC 6.2 - CHANGE ORDER in CCDC 2 - 2008, indicate within 7 days of the above date the changes to the *Contract Price* and *Contract Time* for the following proposed change in the *Work*. Do **not** proceed with the change without a *Change Order* or *Change Directive* authorizing a change in the *Work*.

**Description: Site Upgrades**

Refer to enclosed A100 Site Plan and A101 Site Plan Enlargement Speed Humps for work which includes;

- Removal of existing sidewalk, curb and railing along the east driveway
- Removal of existing tree stump in the parking lot area
- Removal of existing planter and some lawn areas
- Removal and relocation of 9 armour stones
- Provision of new concrete sidewalk, concrete bike rack pad, and concrete island for garbage bins
- Provision of new concrete curb and repair of existing asphalt driveway and speed humps affected by new work
- Provision of new stainless steel railing along the existing east driveway
- Provision of new asphalt pavement and new painted lines over removed tree stump area
- Provision of soiled area for new butterfly garden (NIC)
- Provision of new speed humps on the existing west driveway

**Prepared by the Consultant**

Alex Jacobi

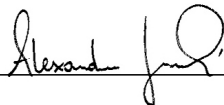

November 29, 2023

---

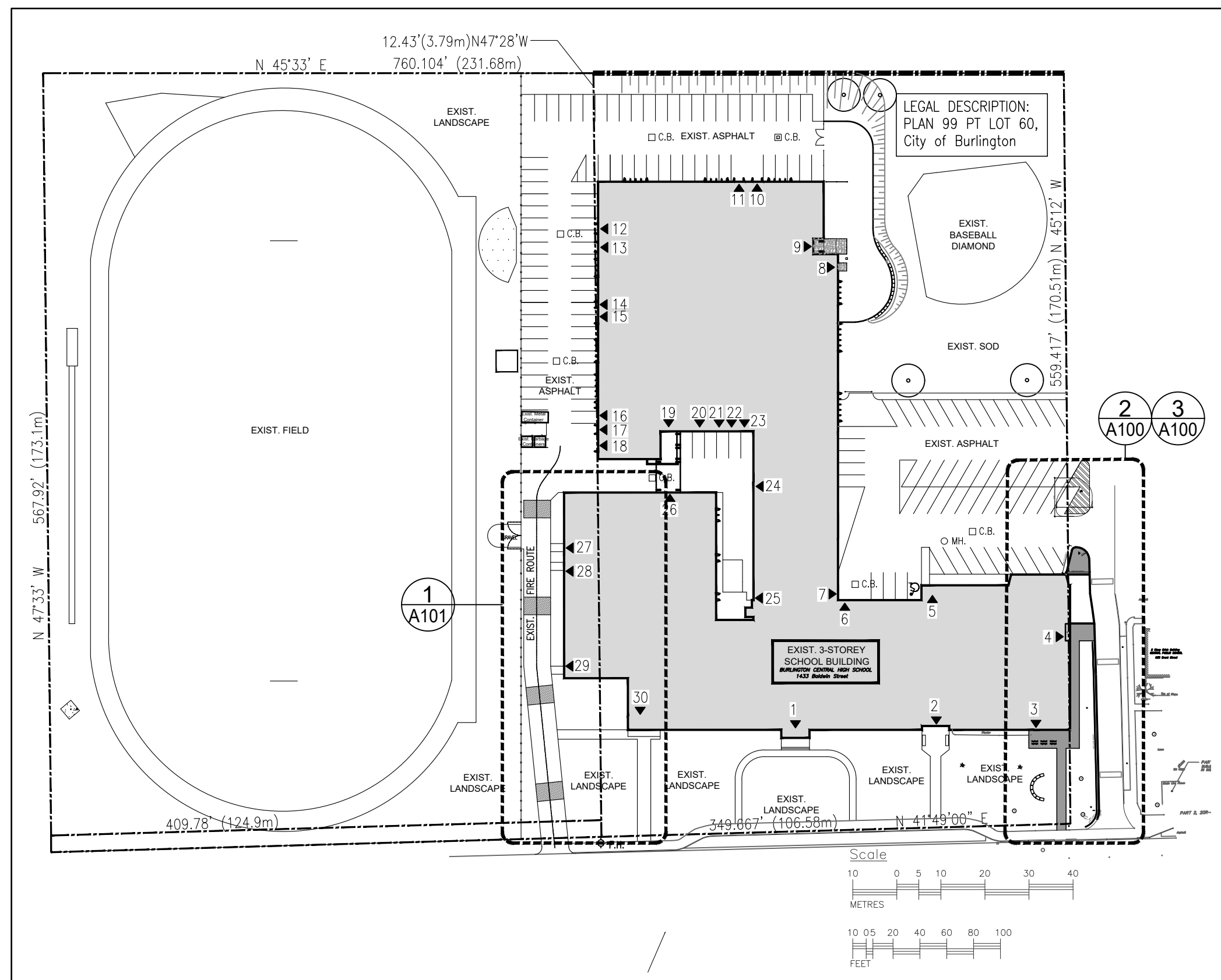

**1 KEY SITE PLAN**  
A100 1:1000

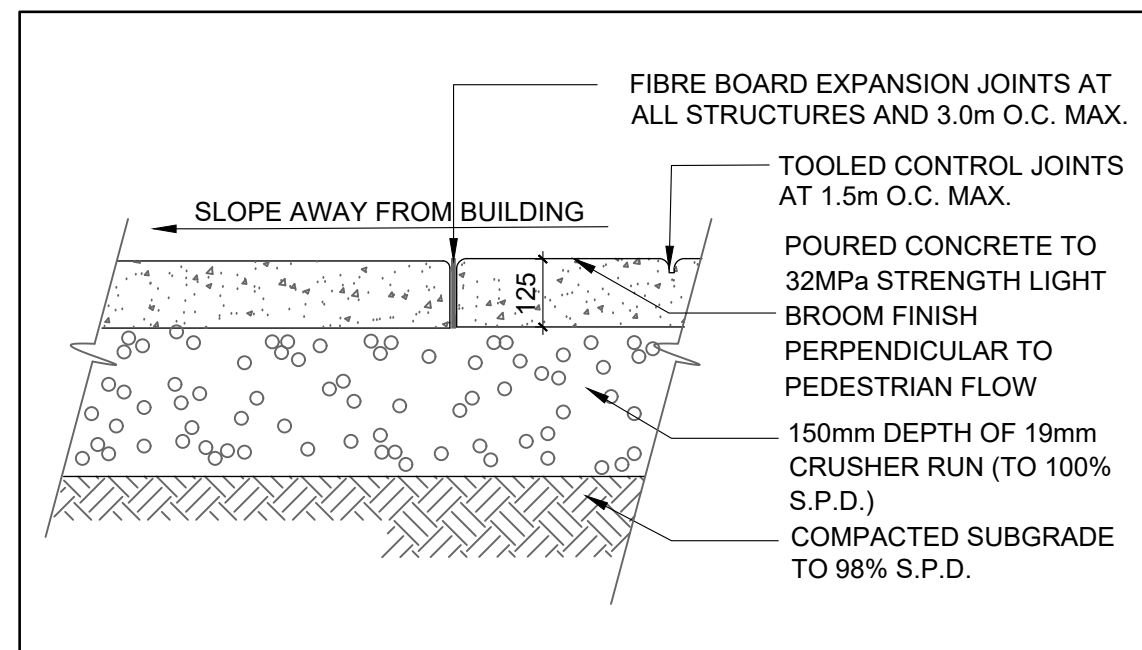

**4 CONCRETE SIDEWALK DETAIL**  
A100 1:10

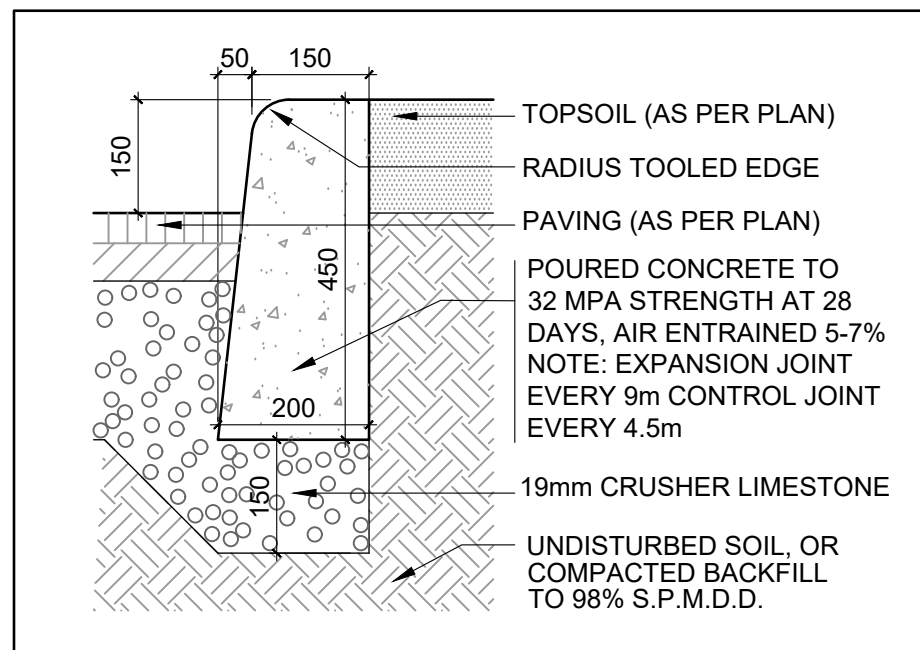

**5 CONCRETE SIDEWALK DETAIL**  
A100 1:10

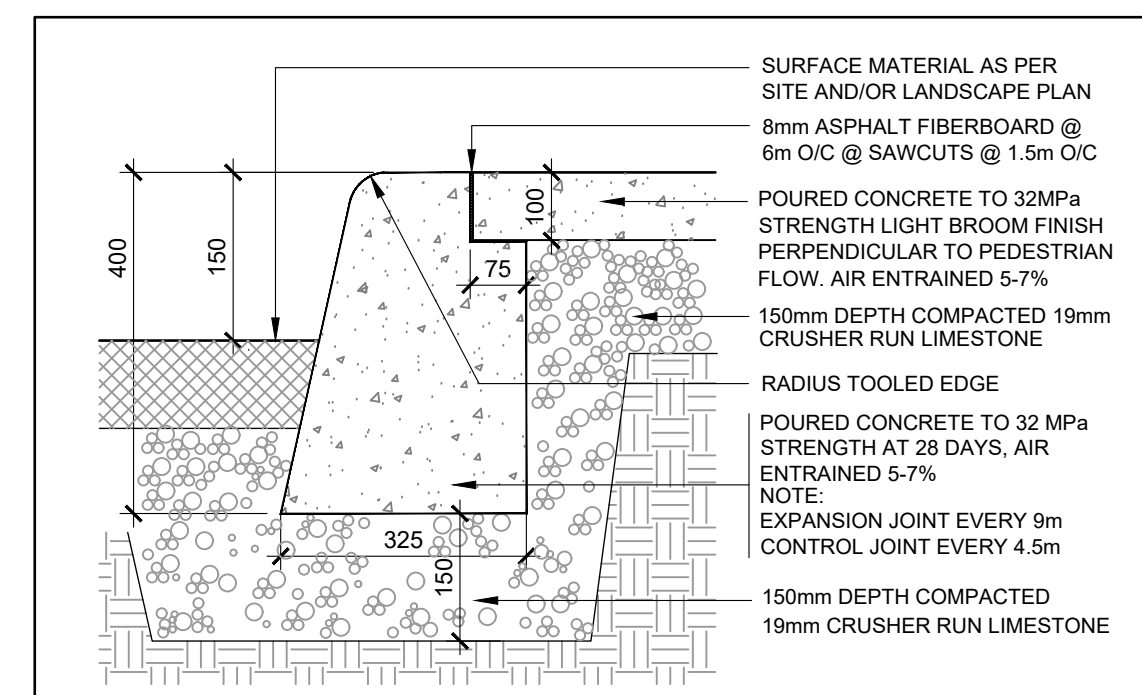

**6 CONCRETE SIDEWALK DETAIL**  
A100 1:10

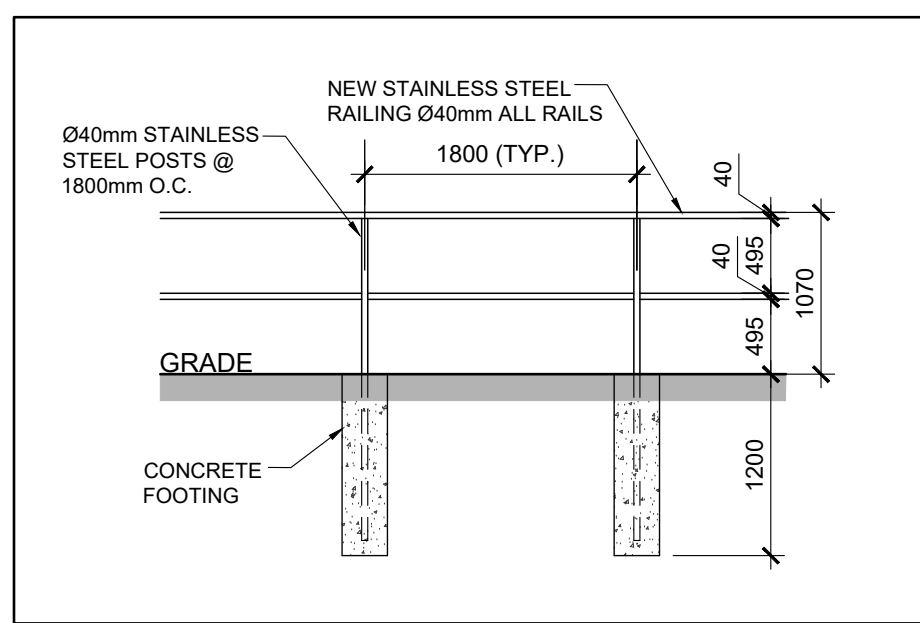

**7 NEW STAINLESS STEEL RAILING DETAIL**  
A100 1:50

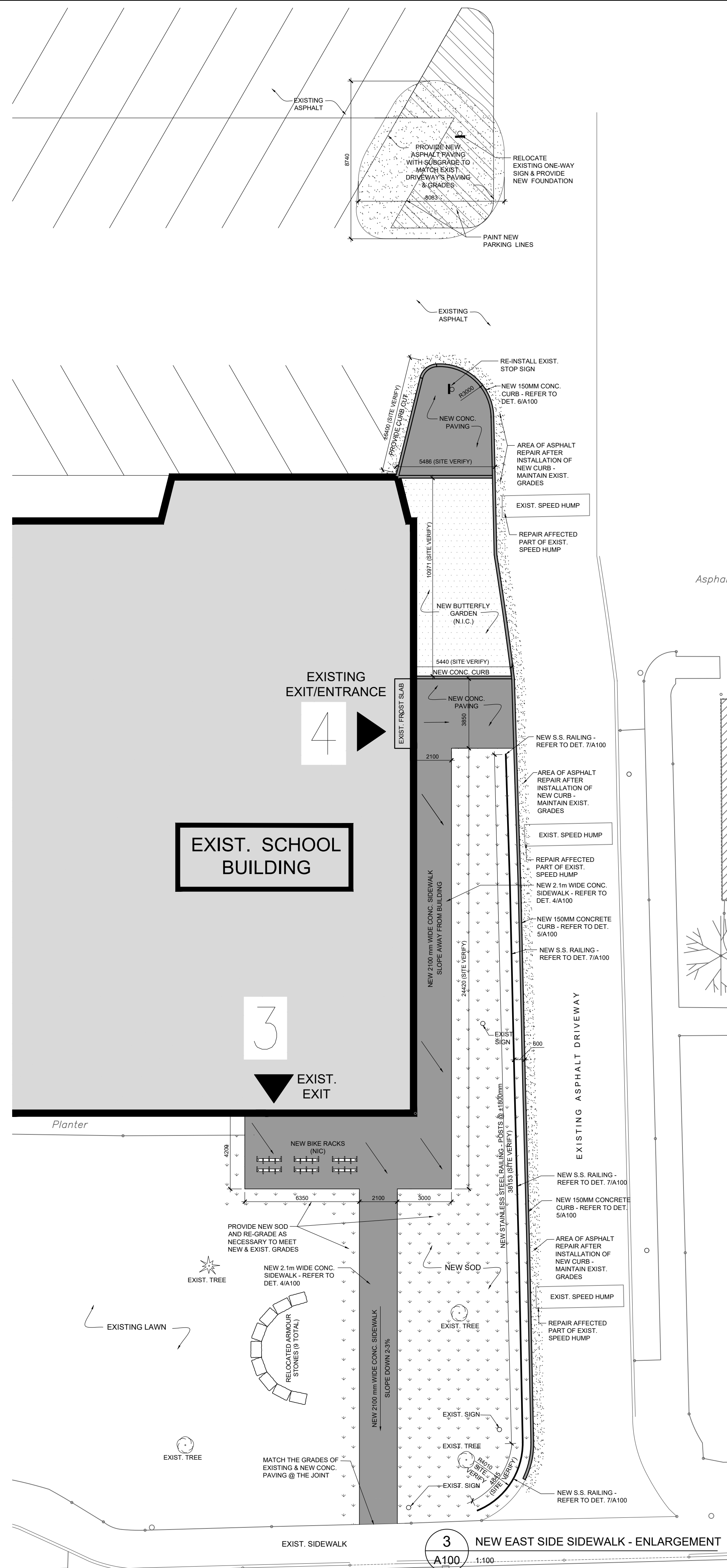

**3 NEW EAST SIDE SIDEWALK - ENLARGEMENT**  
A100 1:100

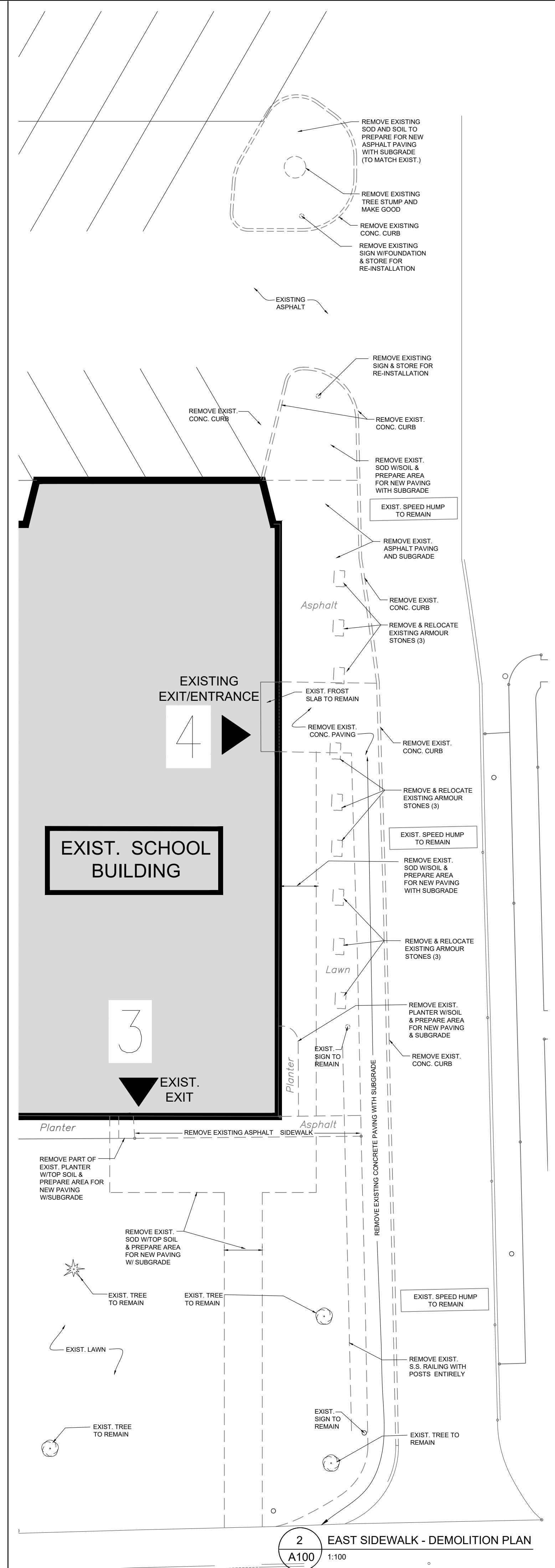

**2 EAST SIDEWALK - DEMOLITION PLAN**  
A100 1:100

Client  
**Halton District School Board**  
2050 Guelph Line  
Burlington, Ontario

**BURLINGTON CENTRAL H.S. RENOVATIONS**

1433 Baldwin Street  
Burlington, ON

Architect  
**sn/der**  
Snyder Architects Inc.  
260 King St. E. Unit A101, Toronto, ON M5A 4L5  
Tel: 416.966.3444 Fax: 416.966.4443  
www.snyderarchitects.ca

Consultants

Structural Consultants  
**Kalos Engineering Inc.**  
300 York Boulevard  
Hamilton, Ontario, L8R 3K6  
Tel: 905-333-9119

Mechanical and Electrical Consultants  
**CK Engineering Inc.**  
2400 Industrial Street  
Burlington, Ontario, L7P 1A5  
Tel: 905-631-1115

Key Plan N.T.S.

Project North True North

No.	Revisions	Date
1	ISSUED FOR PC#16	2023-11-28
No.	Issue	Date

General Contractor shall check and verify all dimensions and report all errors and omissions to the Architect. Do not scale the drawings. Drawings shall not be used for construction purposes until issued by the Architect for construction.



Drawing Title:  
**SITE PLAN**

Scale: AS NOTED Date: 05/26/2023

Drawn by: Checked by:

Job No. Drawing No.

**2005 A100**

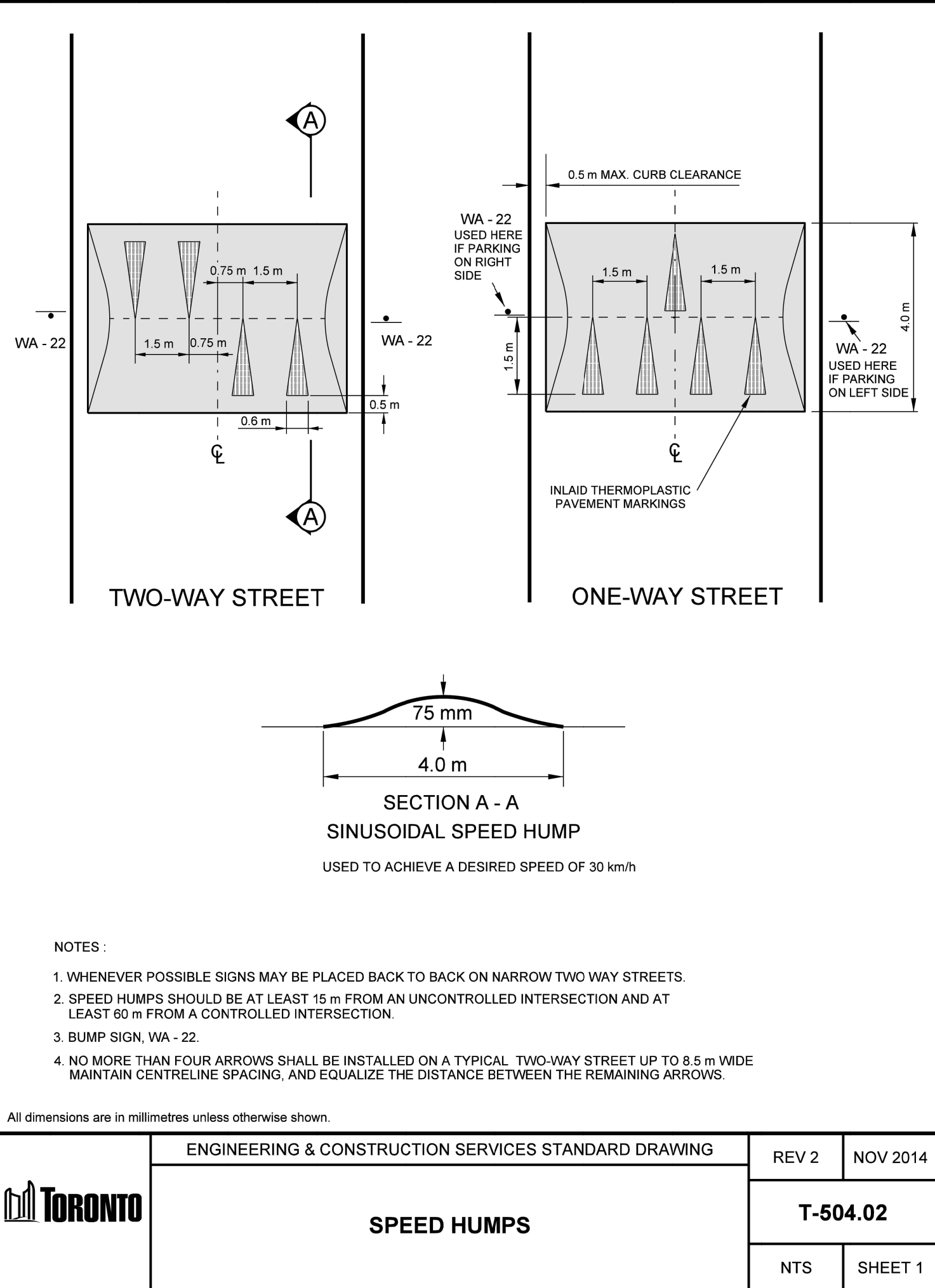

2 SPEED HUMPS DETAIL  
A101 1:100

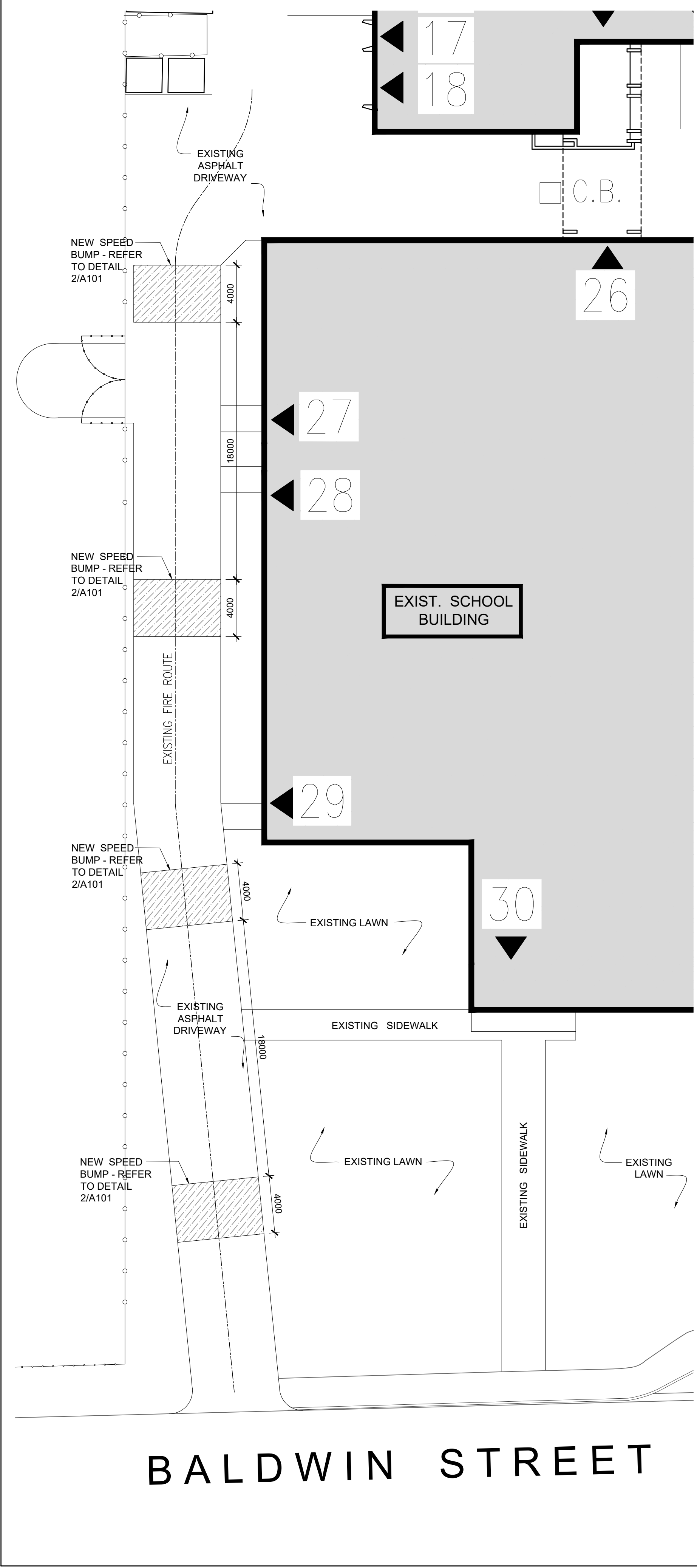

1 NEW SPEED HUMPS AT WEST DRIVEWAY - ENLARGEMENT PLAN  
A101 1:200

Client  
**Halton District School Board**  
2050 Guelph Line  
Burlington, Ontario

**BURLINGTON CENTRAL  
H.S. RENOVATIONS**

1433 Baldwin Street  
Burlington, ON

Architect  
**sn/der**

**Snyder Architects Inc.**  
260 King St. E. Unit A101, Toronto, ON M5A 4L5  
Tel: 416.966.3444 Fax: 416.966.4443  
www.snyderarchitects.ca

Consultants

Structural Consultants  
**Kalos Engineering Inc.**  
300 York Boulevard  
Hamilton, Ontario, L8R 3K6  
Tel: 905-333-9119

Mechanical and Electrical Consultants  
**CK Engineering Inc.**  
2400 Industrial Street  
Burlington, Ontario, L7P 1A5  
Tel: 905-631-1115

Key Plan N.T.S.

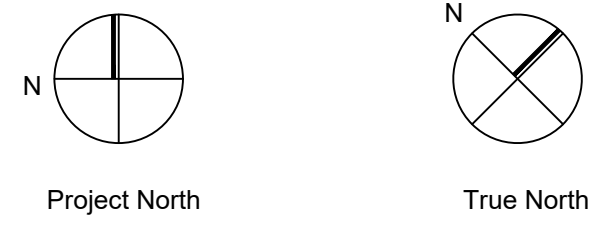

Project North True North

No.	Revisions	Date

1	ISSUED FOR PC#16	2023-11-28
No.	Issue	Date

General Contractor shall check and verify all dimensions and report all errors and omissions to the Architect. Do not scale the drawings. Drawings shall not be used for construction purposes until issued by the Architect for construction.



Drawing Title:  
**SITE PLAN  
ENLARGEMENT  
SPEED HUMPS**

Scale: AS NOTED Date: 10/16/2023

Drawn by: Checked by:

Job No. Drawing No.  
**2005 A101**