



Addendum # 1

Bid Opportunity: 24-7540-RFT - Pioneer Park Public School Interior Renovations

Closing Date: Monday, April 15, 2024 2:00 PM

The following issued by the Board shall form part of the Bid / Proposal Solicitation document. The revisions and additions noted herein along with any attachments shall be read in conjunction with all other related documents. This Addendum shall, take precedence over the previously issued documents where differences occur. Receipt of this addendum must be acknowledged in the Bidding System, bids&tenders.

If you have already submitted a Bid / Proposal, it will be automatically withdrawn as a result of this addendum. You must resubmit the Bid / Proposal acknowledging all addenda and revising your Bid / Proposal to comply with all addenda.

Question 1:

Polyflor would like to respectfully propose our below products to be added to this project on Section 9.65.00 (RFL2) against IQ Optima by Tarkett, Accord by Gerflor, and SPHERA Element by Forbo. Our Polyflor 2000PUR and Classic Mystique adhere to the same performance standards and provides greater colour selection and likely beneficial cost savings. The

school board has had installed our Polyflor 2000PUR on numerous projects and are happy with the performance. Our Classic Mystique offers a non-directional marbled pattern while 2000PUR offers a directional marbled pattern.

Answer 1:

Polyflor 2000 PUR sheets at 2.5mm thickness is accepted. Refer to Clarification Items below.

Question 2:

Drawing 1/A2.1 – Shows demo notes 10 & 28 in the gym.

- I believe that note 10 should read note 11 for removal of asbestos floor tile.
- Please confirm.

Answer 2:

Replace demolition tag 10 with demolition tag 11.

Question 3:

Drawing 3/A2.2 – Partial roof plan.

- Is the existing roof under warranty for patching around (2) exhaust fans?

Answer 3:

The existing roof is not under warranty.

Question 4:

Drawing A5.1 – General door hardware schedule note 3 states “ note that the supply and installation of all door hardware, Including automatic hardware is carried in the project cash allowance.”

- Specification Section (08 71 00) – Item 1.1.5 states “ door hardware including all automatic door hardware is carried in the project cash allowance.”
- Allowances (01 21 00) does not identify a cash allowance for this item.
- Please confirm that door hardware supply and installation is covered under a

cash allowance and update
specification section (01 20 00) accordingly with amount to be included for this
item.

Answer 4:

Refer to Clarification item below.

Question 5:

Drawing A2.1 – general note 5 – States "new interior room signage supply and
installation is carried in the project cash allowance."

- Allowances (01 21 00) does not identify a cash allowance for this item.
- Please confirm if interior room signage is by cash allowance and if so update
specification section (01 20 00) accordingly with amount to be included for this
item.

Answer 5:

Refer to Clarification item below.

Question 6:

Concrete and masonry reinforcement (03 20 00) – Item 1.8.1 – states "include an
allowance of 5 tonnes of additional reinforcing bars in the contract."

- Please confirm that this allowance for additional rebar is not required for this
project.

Answer 6:

Delete paragraph 1.8.1 in Section 03 20 00 – Concrete and Masonry
Reinforcement.

The following clarification items are hereby issued and form an integral part of this addendum:

Revisions to Project Manual Specifications:

- .1 **REFERENCE Section 01 20 00, under the table, 4.1 Allowances Schedule;**
 - .1 Revise number "11" to be number "7".
 - .2 Add the following; ".8 Supply and installation of door hardware including automatic hardware; \$40,000. Clarification Note: all electrical connections to automatic door hardware are carried as part of the base bid contract and not the project cash allowance.
 - .3 Add the following; ".9 Supply and installation of Interior Room Signage; \$1,000."
 - .4 Revise the total of all allowances to be "\$69,000".
- .2 **REFERENCE Section 03 20 00 – Concrete and Masonry Reinforcement;**
 - .1 Delete paragraph 1.8.1 under item 1.8 – Allowance, and replace with "1.8.1. Not Applicable."
- .3 **REFERENCE Section 09 65 00 – RESILIENT FLOORING:**
 - .1 Under Part 2 Materials on page 3 of 8 and 4 of 8, under paragraph .5 Resilient Sheet Flooring (RFL2), under .7 Acceptable Manufacturers and Products, add the following, ".4 Polyflor, 2000PUR 2.5mm thick heavy duty homogeneous sheet flooring".
- .4 **REFERENCE Section 09 90 00 – PAINTING:**
 - .1 Under 2.3 Finishing Systems, under paragraph 2.3.2. Interior Work, add the following sub-paragraph;
".19 Gymnasium Game Lines:
 - .1 Supply and install painted games lines on new resilient sheet sports flooring in Gymnasium 135.
 - .2 Acceptable Manufacturer and Product: Advantage Sport, Gymline Paint, Type 100 Game Line Paint, Parts A and B as required to suit flooring surface.
 - .3 Refer to architectural drawing A5.2 for layout of game lines."

- .5 REFERENCE Section 11 66 00 – Wall and Floor Padding:**
- .1 Revise the Specification Title of Section 11 66 00 to Gymnasium and Sensory Room Equipment.
 - .2 Add the following to Section 1.1, “.2 Gymnasium Floor Sockets”.
 - .3 Revise paragraph 2.1.1. to indicate, “Acceptable Wall Padding Manufacturer”.
 - .4 Add paragraph 2.3 Post Floor Sockets as follows,
 - .1 “2.3 Post Floor Sockets
 - .1 Remove existing gymnasium floor sockets.
 - .2 Supply and install new floor sockets.
 - .3 Standard Floor Applications: brass socket with cover plate.
 - .4 Acceptable Products:
 - .1 Gymnasium and Health Equipment Ltd.: FS-2.
 - .2 Forum Athletic Products: Model F50402 Fixed Floor Sockets with F50410 Sleeve Adapters.

Revisions to Drawings:

- .1 Architectural Drawings:**
 - .1 Drawing A2.1, Drawing 1/A2.1:**
 - .1 Demolition tag 10 in Gymnasium 135 is to be revised to demolition tag 11.
 - .2 In Gym Staff Office 125, add demolition tag 23.
 - .3 In Gym Staff Office 128, revise demolition tag 15 (pointing to the tackboard to be demolished on the east wall) to demolition tag 15a.
 - .4 Revise Demolition Note 27 to read as follows: “Demolish the existing loose carpet flooring and associated adhesives in their entirety , on top of the existing concrete slab-on-grade.”.
 - .2 Drawing A5.2:**
 - .1 Drawing A5.2 is hereby reissued to include the gymnasium painted game lines and forms an integral part of this addendum.

- .2 Structural Drawings:**
 - .1 Drawing S2:**
 - .1 On Drawing 1/S2, add all additional hatched areas to identify concrete slab-on-grade to be demolished and replaced with new concrete slab-on-grade as noted on the architectural drawings. Refer to architectural drawings for additional noted areas.

- .3 Mechanical Addendum M1, prepared by Quasar Consulting Group, is hereby issued and forms an integral part of this addendum.**

- .4 Electrical Addendum E1, prepared by Quasar Consulting Group, is hereby issued and forms an integral part of this addendum.**
 - .1 In addition to the above addendum, note the following additional electrical revisions:**
 - .1 Drawing E101, Drawing 2/E101:**
 - .1 Add demolition note 4 where baseboard heaters are demolished on the south-west wall of Change Room 126, and on the west walls of Washrooms 123 and 122.

END OF ADDENDUM

GENERAL FLOOR FINISHES PLAN NOTES AND LEGEND

- RFL1 - NEW RESILIENT RUBBER SHEET FLOORING IN GYMNASIUM. REFER TO SPECIFICATIONS FOR TYPE.
 - RFL2 - NEW RESILIENT RUBBER SHEET FLOORING. REFER TO SPECIFICATIONS FOR TYPE.
 - POR - PORCELAIN FLOOR TILE (IN WASHROOMS ONLY). SIZE: 305mm X 305mm (12" X 12"). COLOUR: REFER TO SPECIFICATIONS. INSTALLATION: AS SHOWN.
 - ASF = NEW ATHLETIC FLOOR PADDING ON NEW RESILIENT SHEET FLOORING TYPE. RFL2 PROVIDE NINE (9) FLOOR PADS AND SEVEN (7) CUSTOM SIZE OF FLOOR PADS TO SUIT EXTENT OF FLOOR. FOR SIZES, REFER TO FINISHES FLOOR PLAN AND NOTES BELOW. REFER TO FINISHES FLOOR PLAN 1/A5.2.
 - IN SENSORY ROOM 126A, PROVIDE THE FOLLOWING:
 - 1- PROVIDE 16 NEW FLOOR PADS FOR FULL EXTENT OF ROOM.
 - 9 PADS AT 1220mm WIDE X 1800mm LONG.
 - 3 PADS AT 1014mm WIDE X 1800mm LONG.
 - 3 PADS AT 1220mm WIDE X 645mm LONG.
 - 1 PAD AT 1014mm WIDE X 645mm LONG.
 - 2- PROVIDE WALL PADS ON ALL WALLS AS NOTED ON INTERIOR ELEVATIONS 6/A3.1.
- CERAMIC WALL TILE INDICATION**
- CWT LINE TYPE INDICATES LOCATION OF CERAMIC WALL TILE (CWT). PROVIDE CWT1 FIELD TILE AT ALL LOCATIONS. PROVIDE CWT2 VERTICAL ACCENT BAND IN LOCATIONS SHOWN ONLY IN THE BARRIER-FREE WASHROOM.
- NOTE: REFER TO INTERIOR ELEVATIONS DRAWINGS ON DRAWINGS A3.1 AND A3.2 FOR CERAMIC WALL TILE (CWT) LOCATIONS AND LAYOUT.
- TRANSITION STRIP**
- T1 = PROVIDE RESILIENT TRANSITION STRIP AT JUNCTION BETWEEN RESILIENT FLOORING.
 - T2 = PROVIDE METAL TRANSITION STRIP BETWEEN RESILIENT FLOORING AND PORCELAIN FLOORING.
- DISPLAY BOARDS**
- TB = NEW TACK BOARD. REFER TO FLOOR PLANS FOR SIZES OF TB1 AND TB2.
 - TB1 = PROVIDE A QUANTITY OF 1.
 - TB2 = PROVIDE A QUANTITY OF 1.
 - WB = NEW WHITE BOARD. REFER TO FLOOR PLANS FOR SIZE OF WB1.
 - WB1 = PROVIDE A QUANTITY OF 2.
- GYMNASIUM 135:**
- PROVIDE NEW PAINTED GAME LINES BY ADVANTAGE SPORT. GYMLINE PAINT, 1000 GAME LINE PAINT SUITABLE FOR SPORTS FLOORING SURFACES. NOTE THE FOLLOWING GAME LINE COLOURS THAT ARE TO BE PROVIDED:
- 51mm WIDE SOLID YELLOW - VOLLEYBALL
 - 51mm WIDE SOLID BLACK - MAIN COURT BASKETBALL
 - 51mm WIDE SOLID BLUE - SIDE COURT BASKETBALL (FREE THROW LINE ONLY)
 - 51mm WIDE SOLID WHITE - GAME CIRCLES & CREASES
 - 38mm WIDE SOLID RED - BADMINTON
- NOTE THE FOLLOWING:
- DEL - EXISTING TO BE DELETED
 - DBM - BADMINTON
 - MLK - MAIN VOLLEYBALL
 - PV - PRACTICE VOLLEYBALL (NETS ONLY, NO LINES)
- GENERAL NOTES:**
- BASKETBALL COURT LOCATION TO BE DETERMINED BY BACKSTOP LOCATIONS IN EXISTING CONDITIONS.
 - VOLLEYBALL AND BADMINTON LOCATIONS TO BE DETERMINED BY FLOOR SOCKET LOCATIONS.
 - FINAL LAYOUT TO BE APPROVED BY FACILITY SERVICES AND CONSTRUCTION DEPARTMENT AND APPROVED DESIGNATE FROM SCHOOL.
 - GAME LINES TO BE ADJUSTED TO SUIT LAYOUT OF EXISTING FLOOR SOCKETS.
 - GAME LINES TO BE CONTINUOUS.
 - STRIPS OF FLOOR TILE UNDER 1" IN WIDTH SHOULD NOT BE USED. LINES TO BE ADJUSTED TO AVOID USE OF THESE STRIPS. ADJUSTMENTS TO BE APPROVED BY WROSB.
 - PLAY CIRCLE RADIUS MAY VARY TO FIT GYM. DIMENSIONS SHOWN ARE FOR REFERENCE. DO NOT SCALE THESE DRAWINGS.
 - CONTRACTOR SHALL REMOVE EXISTING FLOOR POST SOCKET AND INSTALL NEW POST SOCKETS AFTER FLOOR IS IN PLACE. SITE VERIFY LOCATION AND QUANTITY OF FLOOR SOCKETS.

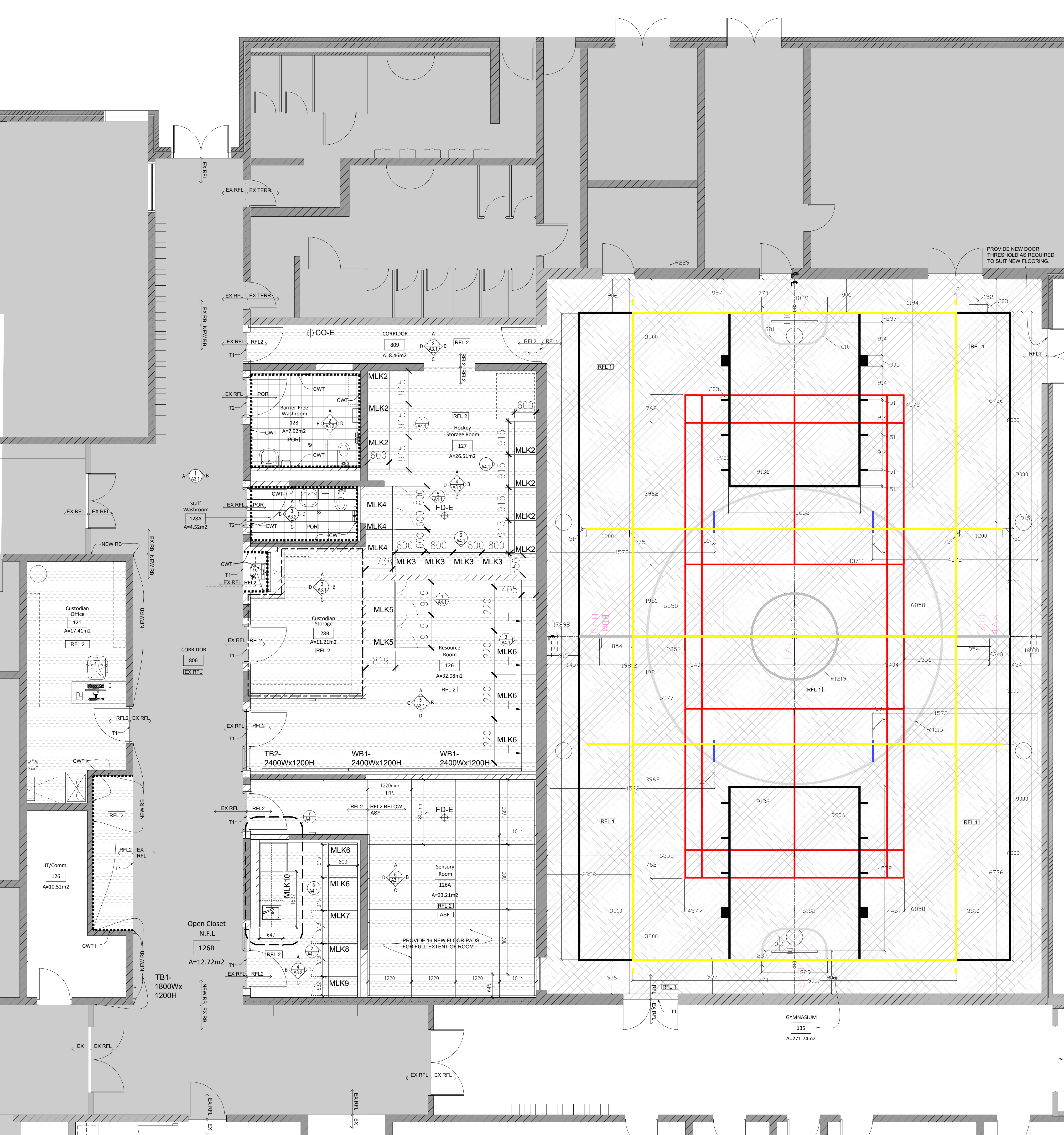
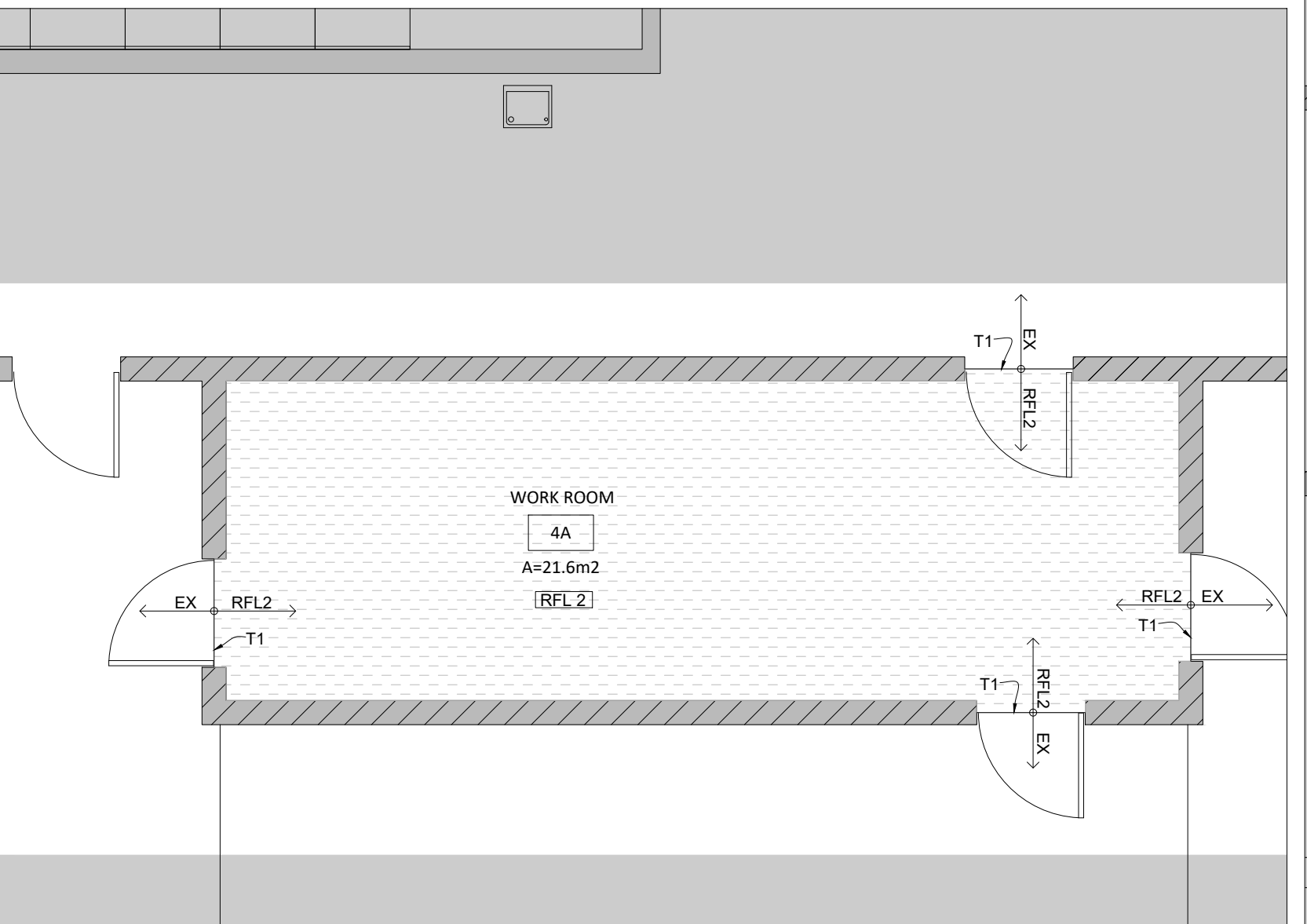
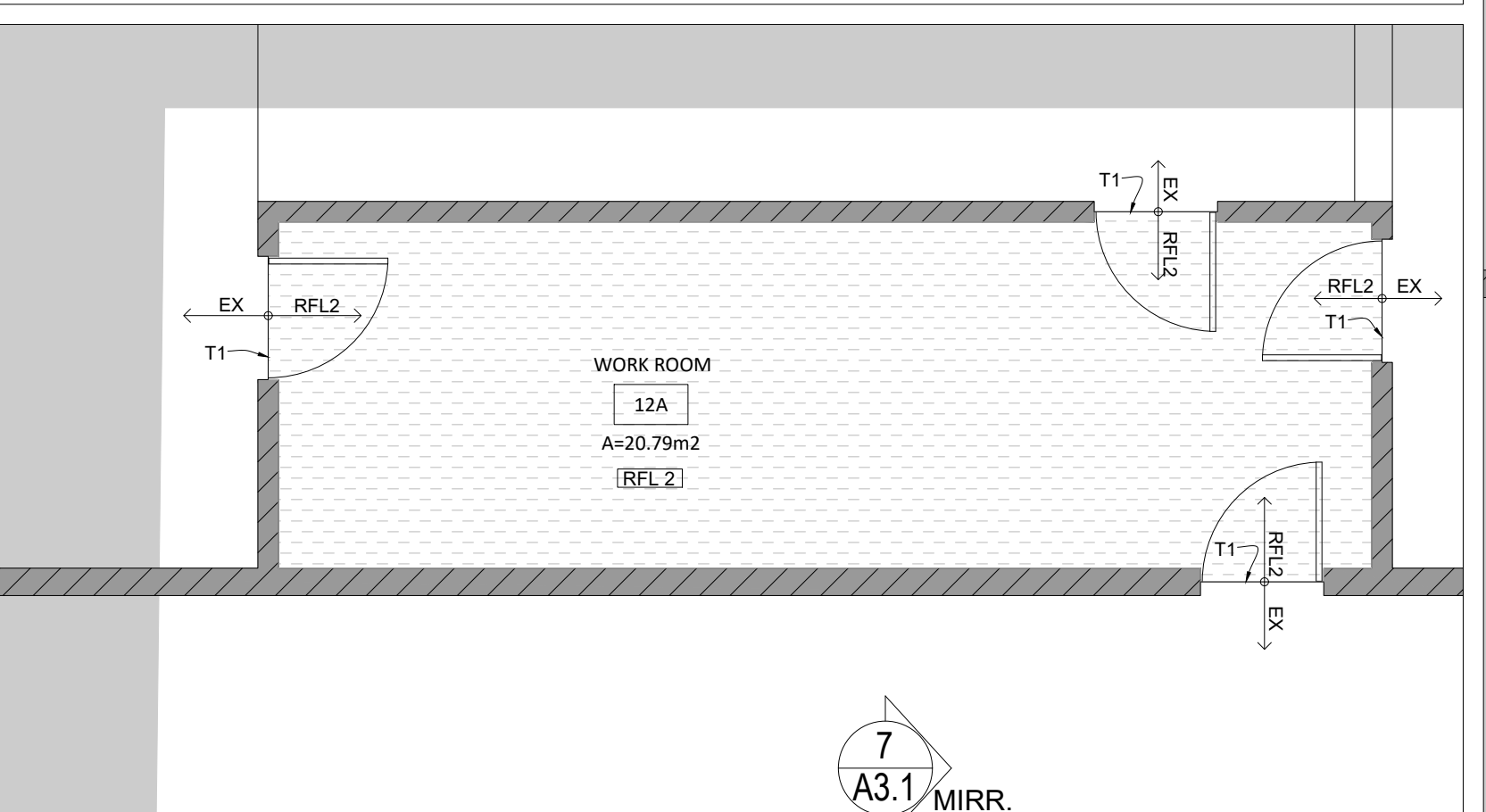

NOTE: THIS DRAWING IS NOT TO BE SCALED. THE CONTRACTOR IS RESPONSIBLE FOR THE VERIFICATION OF ALL SITE DIMENSIONS AND FOR NOTIFYING THE ARCHITECT OF ANY SITE CONDITIONS AND SITE MEASUREMENTS THAT ARE NOT CONSISTENT WITH THE DRAWINGS.

no.	revision	date
1.	ADDENDUM NO.1	2024.04.09

no.	issue	date
1.	Issued for Owner Review	Dec. 5, 2023
2.	Issued for Schematic Design Report	Dec. 21, 2023
3.	Issued for Permit and Tender	March 22, 2024

project
PIONEER PARK PUBLIC SCHOOL INTERIOR RENOVATIONS
 TENDER 24-7540-RFT
 WATERLOO REGION DISTRICT SCHOOL BOARD
 55 UPPER CANADA DRIVE, KITCHENER, ON N2P 1G2
 PARTIAL PROPOSED GROUND FLOOR FINISH PLANS,
 NOTES AND LEGEND

drawing scale
 AS NOTED
 ward99 project number
 23016 - WRDSB PIONEER PARK
 ward99 architects
 drawing no.

Wa RD. 99
 ward99 architects inc.
 7500 Highway 27, Unit 27B
 Vaughan, ON L4H 0J2
 info@ward99architects.com
 416.613.5880 www.ward99architects.com

A5.2

Project Name: WRDSB Pioneer Park PS Renovations **Date Issued:** March 28, 2024
Quasar Project #: CM-19-083

Distribution
Ward99 Tina Ranieri-D'Ovidio tr@ward99architects.com
Quasar Michael Hughes Michael.hughes@quasarcg.com

Addendum #: M1
Revision #: 0

This Addendum forms part of the Contract Specifications and Drawings, and modifies the Bidding Documents, with Amendments and Additions noted below. This Addendum shall be added to the front of the specifications as issued. Bidders shall acknowledge receipt of this Addendum in the space provided in the Bid Form and include in bid amount.

This addendum includes modifications to the drawings as summarized below. Unless otherwise noted, all drawings listed below are attached herewith.

1.0 Specifications:

1. **Section 22 42 00 – Commercial Plumbing Fixtures**

Replace previously issued specification section 22 42 00 with the attached and include for all work show including:

- a. Revised fixtures LAV-1, LAV-2, WC-1, and WC-2 as shown.

Quasar Consulting Group

Michael Hughes, P.Eng.

Team Lead

1 General

1.01 SECTION INCLUDES

- .1 Plumbing fixtures and related components.

1.02 SUBMITTALS

- .1 Submit product data sheets (fixture cuts) for all plumbing fixtures and fittings, including accessories.
- .2 Product Data: Include selected fixture and trim, fittings, accessories, appliances, appurtenances, equipment, and supports and indicate materials and finishes, dimensions, construction details, and flow-control rates for each type of fixture indicated.
- .3 Wiring Diagrams: Power, signal, and control wiring.
- .4 Submit fixture manufacturer's standard colour charts for all fixtures where colours are available but a particular colour is not specified.

1.03 CLOSEOUT SUBMITTALS

- .1 Operation and maintenance data.

2 Products

2.01 GENERAL RE: PLUMBING FIXTURES AND FITTINGS

- .1 Fixtures and fittings, where applicable, are to be in accordance with requirements of CAN/CSA B45 Series, General Requirements for Plumbing Fixtures, including supplements, ASME A112.1.18.1/CSA B125.1, Plumbing Supply Fittings, and CSA B125.3, Plumbing Fittings.
- .2 Barrier-free fixtures and fittings are to be in accordance with governing Code requirements.
- .3 Unless otherwise specified, vitreous china, porcelain enamelled, and acrylic finished fixtures are to be white.
- .4 Unless otherwise specified, fittings and piping exposed to view are to be chrome plated and polished.
- .5 Fittings located in areas other than private washrooms are to be vandal-proof.
- .6 Fixture carriers are to be suitable in all respects for the fixture they support and construction in which they are located.
- .7 Floor flanges for floor mounted water closets are to be cast iron or brass, secured to floor to prevent movement and complete with a wax seal and brass or stainless steel bolts, nuts, and washers. Plastic floor flanges will not be acceptable.
- .8 Proper seal to mate with fixture carrier flange and produce a water-tight installation.
- .9 Exposed traps for fixtures not equipped with integral traps, such as lavatories, are to be adjustable chrome plated cast brass "P" traps with cleanouts, minimum #17 gauge chrome plated tubular extensions, and chrome plated escutcheons, all to suit fixture type and drain connection.
- .10 Concealed traps for fixtures not equipped with integral traps, such as counter sinks, are to be adjustable cast brass with cleanout plugs, all to suit fixture type and drain connection.
- .11 Exposed supplies for fixtures which do not have supply trim/fittings with integral stops, i.e. lavatories, are to be solid chrome plated brass angle vales with screwdriver stops for public areas, wheel handle stops

for private areas, flexible stainless steel risers, and stainless steel or chrome plated steel escutcheons, all arranged and sized to suit fixture.

- .12 Water piping as specified, complete with ball type shut-off valves as specified with water piping, or Dahl Bros. Canada Ltd. ¼ turn Mini Ball Valves.

2.02 PLUMBING FIXTURES AND FITTINGS

- .1 Plumbing fixtures and fittings are to be in accordance with the following:

- .1 LAV-1 Wall Hung Basin – Single Handle Faucet

- .1 American Standard Murro with EverClean #0954.004EC.020 Basin, 3 holes, 4" (102 mm) center, 540 mm x 520 mm x 165 mm (21-1/4" x 20-1/2" x 6-1/2") high, Vitreous china, White Finish, for carrier with concealed arms, Rear overflow, recessed self-draining faucet ledge. American Standard 0059.020EC.020 Semi-pedestal P-trap cover. Complies with ASME A112.19.2 for Vitreous China Fixtures, and ADA and ANSI A117.1 Accessible and usable buildings and facilities.
- .2 Delta 22C151 Single Control Manual Lavatory Faucet. CAST BRASS centerset faucet, Single control, 4" (102mm) centers, Less pop-up, no pop-up hole, Polished chrome-plated finish, Ceramic cartridge with rotational limit stop, Metal hold-down package, Vandal resistant 0.5gpm (1.9 L/min) vandal resistant spray outlet, ADA compliant lever handle with color index.
- .3 McGuire #155A Open Grid Drain, cast brass one piece top, 17 GA. (1.5 mm) tubular 32 mm (1-1/4") tailpiece.
- .4 McGuire #LFH170BVRB Faucet Supplies, Chrome plated finish polished brass, commercial duty 1/4 turn ball valve angle stops, 13 mm (1/2") I.D. Inlet x 127 mm (5") horizontal extension tubes, convertible 1/4 turn/loose key handles, Escutcheon and stainless steel braided flexible risers.
- .5 McGuire #8872C P-Trap, Heavy cast brass adjustable body, with slip nut, 32 mm (1-1/4") size, Shallow wall flange and Seamless tubular wall bend.
- .6 Watts #WCA-411-CA-481 Basin Carrier, concealed arms, wall flanges to attach to backing plate secured in wall with locking device and levelling screws, heavy gauge steel uprights with integral welded feet. For one unit: 102 mm (4") for two to six units in a row: 152 mm (6") finished metal stud wall to back of pipe space.

- .2 LAV-2 Wall Hung Basin – Barrier Free

- .1 American Standard Murro with EverClean #0954.004EC.020 Basin, 3 holes, 4" (102 mm) center, 540 mm x 520 mm x 165 mm (21-1/4" x 20-1/2" x 6-1/2") high, Vitreous china, White Finish, for carrier with concealed arms, Rear overflow, recessed self-draining faucet ledge. American Standard 0059.020EC.020 Semi-pedestal P-trap cover. Complies with ASME A112.19.2 for Vitreous China Fixtures, and ADA and ANSI A117.1 Accessible and usable buildings and facilities.
- .2 Sloan EBF-650-BAT-TEE-CP-0.5GPM-MLM-IR-FCT Faucet - OPTIMA®, Counter mounted, Automatic no-touch, hardwired power (battery as a back-up), 24 VAC power harness connector supplied, Lavatory faucet, Polished chrome finish, 102 mm (4") centerset, Brass spout, 1.9 LPM (0.5 GPM) maximum flowrate, Multi-laminar spray outlet, Fixed spout, 116 mm (4-9/16") spout reach, 92 mm (3-5/8") high, Self-adapting infrared sensor, Dual inlet filter assembly with 9.5 mm (3/8") compression brass cap for tempered water included, Wireless bluetooth status view, setting adjustment and diagnostic via Sloan Connect App®, Integral water supply shut off.

- .3 Sloan SL-EL-154 Faucet Power Kit – for faucet.
 - .4 Lawler TMM-1070-87500 Mixing Valve - The point of use mechanical mixing valve with thermostatic limit stop, MECHANICAL MIXING VALVE, Lead free brass body construction, The temperature adjusting dial is located on the cold inlet. Turning the dial clockwise will lower the outlet temperature, turning the dial counter-clockwise will raise it. The valve cannot be adjusted above its shut-off temperature of 120F, 1.8 LPM (0.5 GPM) tempered flowrate @ 5 PSI pressure drop, Compression Fitting, 84 mm (3-5/16") high, ASSE 1070 approved ASSE lead free Certified for ASSE 1070 applications, 3/8" MNPT (9.5 mm) inlet, 3/8" MNPT (9.5 mm) outlet, Integral rubber duck-bill backflow checks, High temperature limit stop, 125 PSI max supply pressure, Automatically shuts down flow of water when temperature reaches 120 °F, 5 PSI Minimum Operating pressure, 140 °F max, 118 °F ±3 °F, Protects against scalding and chilling, 8 LPM (2.1 GPM) flowrate @ 45 PSI
 - .5 McGuire 155WC Fixture Drain - offset drain, offset lavatory strainer, Lavatory, Cast brass, Chrome-plated finish, Inorganic microbial compound, 7/32" (5.5 mm) Ø holes size, Polished chrome, Cast brass elbow, 17 gauge 32 mm (1-1/4") Ø tailpiece diameter, 146 mm (5-3/4") offset, Brass locknut, Heavy rubber basin washer Fiber friction washer, ADA compliant, ASME A112.18.2 CSA B125.2, CSA compliant
 - .6 McGuire LFH165 Supply - Lead Free, shall be constructed from Cast brass valve, with Chrome-plated finish, Lavatory supply, 10 mm (3/8") I.P.S. inlet, 10 mm (3/8") O.D outlet.
 - .7 McGuire 8872C P-Trap - Heavy cast brass, Adjustable p-trap, 292 mm (11-1/2") distance, With cleanout plug, Steel shallow flange, Neoprene gasket, Slipnuts, 17 gauge seamless tubular wall bend, ASME A112.18.2 CSA B125.2, CSA compliant
 - .8 Watts WCA-411-CA-481 Carrier - WCA-411/WCA-411-WC, Lavatory carrier, Single floor-mounted lavatory carrier with concealed arms, For concealed arm carrier, adjustable arms, epoxy coated cast iron, integral welded feet, upper tie rod, Heavy gauge steel offset uprights, basin locking device, Plated hardware, levelling screws, Wall mounted steel support plate with plated hardware.
- .3 WC-1 Floor Mounted, Flush Tank
- .1 American Standard 215CA174.020 Toilet - CADET® PRO™, Tank type Toilet, Floor mounted with floor outlet, High Efficiency HET 6.0 LPF (1.6 GPF), White finish Vitreous china, EverClean® antimicrobial surface, Elongated bowl, Minimum 305 mm (12") rough-in from wall to the center of waste outlet, Siphon jet flush action, Manual, Polished chrome left-hand trip lever (7381231-200.0020A), Tank with Aquaguard liner, With tank cover locking device, Gravity-assisted flush, Cadet® flushing system, 76 mm (3") flush valve, Tank coupling components, 229 x 203 mm (9" x 8") water surface area, Fully-glazed 54 mm (2-1/8") trapway, PowerWash™ rim scrubs bowl with pressurized water every flush, Includes EZ-Install Tools, Trade exclusive tank, Toilet seat not included, Colour-matched bolt caps, 441 mm (17-3/8") wide, 765 mm (30-1/8") from finished wall, 733 mm (28-7/8") high Compliances: ASME A112.19.2 compliant, CSA B45.1 compliant, EPA WaterSense® compliant.
 - .2 Centoco 820STSFE-001 Seat - FAST-N-LOCK, For elongated bowl, Open front, Heavy-duty, For commercial applications, Polypropylene, Toilet seat, With seat cover, Plastic commercial check hinges, and Stainless steel hinge pin, Specified in White finish, FAST-N-LOCK mounting system takes the guess work out when tightening the hardware. The specially designed fasteners in click" when the appropriate torque is reached. The bolt and nut material shall be stainless steel, Dimensions:25 mm (1") high, 470 mm (18-1/2") long, 362 mm (14-1/4") wide

- .3 McGuire LFBV172 Supply - Lead Free, with Chrome-plated finish, Convertible quarter-turn supply, Toilet, Two 13 mm (1/2") copper sweat x 10 mm (3/8") outer Ø brass ball valve connection, 2 deep bell flange, Convertible loose key handle, extension is 127 mm (5") length, 304 mm (12") copper flexible risers.
- .4 WC-2 Floor Mounted, Flush Valve – Barrier Free
 - .1 American Standard 3461001.020 Toilet - MADERA™ FloWise®, Toilet, Floor mounted with floor outlet, Toilet operates in the range of 4.2 to 6.0 LPF (1.1 - 1.6 GPF), White finish Vitreous china, EverClean® antimicrobial surface, Elongated bowl, 419 mm (16-1/2") rim height, 254 mm (10") to 305 mm (12") rough-in from wall to the center of waste outlet, Direct-fed siphon jet flush action, 38 mm (1-1/2") top spud, Flush valve by others, 254 x 305 mm (10" x 12") water surface area, Fully-glazed 54 mm (2-1/8") trapway, Condensation channel, Toilet seat not included, Two (2) colour-matched bolt caps with retainers (481310-100), 356 mm (14") wide, 718 mm (28-1/4") from finished wall, Compliances: ASME A112.19.2 compliant, CSA B45.1 compliant.
 - .2 Centoco 500STSCCFE-001 Seat - FAST-N-LOCK, For elongated bowl, Open front, Heavy-duty, For commercial applications, Polypropylene, Toilet seat, Less seat cover, Plastic commercial check hinges, and Stainless steel hinge pin, Specified in White finish, FAST-N-LOCK mounting system takes the guess work out when tightening the hardware. The specially designed fasteners "click" when the appropriate torque is reached. The bolt and nut material shall be stainless steel, Dimensions: 25 mm (1") high, 473 mm (18-5/8") long, 371 mm (14-5/8") wide
 - .3 Sloan SL-ROYAL 113-1.6-ESS Flush Valve - ROYAL® Automatic no-touch Exposed Water closet flushometer, Low consumption 6.0 LPF (1.6 GPF), 38 mm (1-1/2") spud coupling For top spud toilet, Hardwired, constructed from Semi-red brass, Polished chrome finish, Chloramine resistant PERMEX® synthetic rubber diaphragm, OPTIMA® EL-1500 self-adaptive infrared sensor, Sensor located on die cast sensor plate with no visible fasteners (for 2-gang electrical box), Courtesy Flush® electrical override button, Flush tube for 406 mm (16") rough-in, 25 mm (1") I.P.S. screwdriver Bak-Chek® angle control stop with free spinning vandal-resistant stop cap, Dual-filtered fixed bypass, Sweat solder adapter kit with cover tube, High back pressure vacuum breaker, 25 mm (1") supply pipe, Cast wall flange with set screw, Non-hold-open, no external volume adjustment, fixed volume accuracy is controlled by CID™ technology, 24 VAC input/output, With indicator light, Requires transformers 0345154 or 0345999, 103 - 552 kPa (15 - 80 PSI) operating water pressure, Compliances: UL listed, cUPC compliant.
 - .4 Sloan SL-EL-154 Faucet and Flush Valve Power Kit - For flush valve
 - .5 Franke Commercial #CM-16104, wall mount back rest, solid core plastic laminate panel back, Antique white, 305 mm (12") wide x 102 mm (4") high x 8" (204 mm), 18 gauge stainless steel bar with gloss with flanges and covers, concealed snap flanges and mounting hardware included, Provide adequate backing in wall for support and comply to local codes for barrier free requirements
- .5 S-1 Single Bowl Stainless Steel Sink
 - .1 Franke Commercial #LBS7310P-1 Single Bowl Countertop Mount Sink, 1 faucet hole, self rimming with faucet ledge, 560 mm (22-1/16") wide x 651 mm (25-5/8") long x 254 mm (10") deep overall, Counter mounted, Grade 18 gauge (1.2 mm) type 304 stainless steel, Satin finish, Mounting kit provided, Fully undercoated to reduce condensation and resonance, factory applied rim seal, 3-1/2" (89 mm) crumb cup waste assembly with 1-1/2" (38 mm) tailpiece. Certified to ASME A112.19.3-2008 and CSA B48.4-08
 - .2 Chicago Faucets #431-E34VPABCP Faucet - Counter mounted, Manual, Single handle, Sink faucet, Polished chrome finish, 203 mm (8") centerset, Lead Free ANSI/NSF 61

compliant, ECAST® brass construction, Less supply, Ceramic cartridge, 5.7 LPM (1.5 GPM) maximum flowrate, Pressure compensating non-aerated laminar spray outlet, Tubular cast brass spout, 241 mm (9-1/2") spout reach, 152 mm (6") high, Lever handle, Less drain, 13 mm (1/2") NPSM supply inlet.

- .3 Lawler #TMM-1070, Below Deck Mechanical Water Mixing Valve, Bronze body, temperature adjusting dial, 10 mm (3/8") inlets and outlet compression fittings, high temperature thermostatic limit stop, shut-off with automatic reset when temperature exceeds 120 °F (48.8 °C), Integral checks, offer temperature range from full cold through 46 °C (114.8 °F). Provide tee, adaptors and flex. copper tubing to suit installation. Provide tempered water to hot side of faucet.
- .4 McGuire #LFCK170 Supply - Lead free, Sweat to compression, Integral check supply kit w/5" sweat extension, Chrome-plated finish, 1/2" Sweat w/5" Sweat extension x 3/8" O.D, 305 mm (12") chrome-plated risers, Wheel handle, Faucet, Deep bell wall flange
- .5 McGuire 8912CB P-Trap - Heavy cast brass, Adjustable p-trap, 292 mm (11-1/2") length, With cleanout plug, Steel box flange, Neoprene gasket, Seamless tubular brass bend, Slipnuts

2.03 MANUFACTURERS

- .1 Subject to compliance with requirements, manufacturers that may be incorporated into the Work include, but are not limited to, following:
 - .1 Flush Valves:
 - .1 Sloan;
 - .2 Delta Commercial;
 - .3 Zurn Industries;
 - .4 Moen Commercial.
 - .2 Plumbing Brass:
 - .1 Sloan;
 - .2 Acorn Engineering;
 - .3 American Standard;
 - .4 Delta Commercial;
 - .5 Chicago Faucet;
 - .6 Moen Commercial.
 - .3 Stainless Steel Sinks:
 - .1 Franke Commercial;
 - .2 Novanni Commercial;
 - .3 Aristaline;
 - .4 Arch Metal Ind.

- .4 Mop Sinks:
 - .1 Stern Williams;
 - .2 Acorn Engineering;
 - .3 Zurn Industries.
- .5 Emergency Eye Wash and Emergency Showers:
 - .1 Haws;
 - .2 Speakman;
 - .3 Bradley.
- .6 Drain Fittings, Angle Supplies, and Traps:
 - .1 McGuire;
 - .2 American Standard;
 - .3 Delta Commercial;
 - .4 Zurn Industries.
- .7 Fixture Carriers:
 - .1 Watts Industries;
 - .2 Jay R. Smith;
 - .3 Zurn Industries.
- .8 Hose Bibbs:
 - .1 Jay R. Smith;
 - .2 Zurn Industries.
- .9 Water Closets, Lavatories, and Urinal:
 - .1 American Standard;
 - .2 Zurn Industries;
 - .3 Kohler.
- .10 Thermostatic Mixing Valves:
 - .1 Lawler;
 - .2 Delta Commercial;
 - .3 Leonard.
- .11 Shower and Associated Trim:
 - .1 American Standard;
 - .2 Delta Commercial;

- .3 Zurn Industries;
- .4 Moen Commercial.
- .12 Toilet Seats:
 - .1 Olsonite;
 - .2 Centoco;
 - .3 Bemis Commercial.
- .13 Electronic “No Touch” Flush Valves:
 - .1 Sloan;
 - .2 Delta Commercial;
 - .3 Zurn Industries;
 - .4 Moen Commercial.
- .14 Electronic “No Touch” Faucets:
 - .1 Sloan;
 - .2 Delta Commercial;
 - .3 Zurn Industries;
 - .4 Moen Commercial.

2.04 CAULKING

- .1 General Electric Series SCS-1200 Silicone Construction Sealant or Dow Corning 780 silicone rubber sealant with primers as recommended by sealant manufacturer. Caulking colour(s) for coloured fixtures other than white, if any, will be selected by the Consultant from sealant manufacturer’s standard colour range.

3 Execution

3.01 DEMOLITION

- .1 Refer to demolition requirements specified in Section 20 05 05 – Selective Demolition for Mechanical.

3.02 INSTALLATION OF PLUMBING FIXTURES AND FITTINGS

- .1 Provide required plumbing fixtures and fittings.
- .2 Where new fixtures and fittings are to be connected to existing piping, include for required piping revisions.
- .3 Connect plumbing fixtures and fittings with piping sized in accordance with drawing schedule. Refer to manufacturer’s published connection (rough-in) requirements. Where manufacturer requires piping connection larger than shown below, provide piping accordingly:

<u>Fixture and/or Fitting</u>	<u>Drain Size mm (IN)</u>	<u>Vent Size mm (in)</u>	<u>DHW Size mm (in)</u>	<u>DCW Size mm (in)</u>	<u>Temp Water Size mm (in)</u>
Water Closets Flush Valve Type	100 (4)	38 (1-½)	-	25 (1)	-
Urinals	75 (3)	38 (1-½)	-	25 (1)	-
Lavatories	32 (1-¼)	32 (1-¼)	12 (½)	12 (½)	-
Lavatories (Electronic Faucet)	32 (1-¼)	32 (1-¼)	12 (½)	12 (½)	12 (½)
Counter Sinks	38 (1-½)	32 (1-¼)	12 (½)	12 (½)	-
Shower Valves and Heads	-	-	12 (½)	12 (½)	12 (½)
Shower Stalls	50 (2)	38 (1-½)	12 (½)	12 (½)	12 (½)
Prefab. Mop Sinks with Drain	75 (3)	38 (1-½)	20 (¾)	20 (¾)	-
Emergency Eye Wash	-	-	-	-	12 (½)
Emergency Shower	-	-	-	-	25 (1)

- .4 Confirm exact location of plumbing fixtures and trim prior to roughing-in. Refer to architectural plan and elevation drawings.
- .5 When installation is complete, check, and test operation of each fixture and fitting. Adjust or repair as required.
- .6 For barrier-free fixtures, comply with mounting height and other requirements of governing Code(s).
- .7 For barrier-free water closets utilizing manual flush controls, controls to be installed so that it is operable from the transfer side of the fixture.
- .8 Supply templates for counter mounted fixtures and trim and hand to trades who will cut the counter. Ensure openings in counter are properly located.
- .9 Locate control panels for electronic faucets under lavatories and recessed into wall. Coordinate panel installations with electrical trade who will provide 115 volt power wiring to panels. Install flexible conduit (supplied with box) and extend cord from faucet through the flexible conduit to control box. Connect hot and cold water piping to mixing valve in each box, and tempered water piping from each mixing valve to faucet. Set mixing valve maximum temperature limit stops to 43°C (110°F) after domestic water systems (hot and cold) are complete. Ensure each programmable controller is properly programmed and water off after deactivation is set for 3 seconds.
- .10 For electronic flush valves, locate transformer in ceiling space above electronic units to be served. Coordinate locations with electrical trade who will provide 120 volt line supply to transformers. Provide low voltage wiring from transformers to each electronic flush valve terminal point. Electrical line supply and low voltage wiring is to be concealed and access to transformer must be provided for servicing.
- .11 Protect baths from damage during construction and finishing work. Unless otherwise specified, pack concealed voids under baths with batt type glass fibre insulation as baths are installed.
- .12 Protect shower bases from damage during construction and finishing work.
- .13 Confirm exact mixing valve and shower head locations prior to roughing-in.
- .14 Install refrigerated drinking fountains in accordance with manufacturer's instructions. Plug into a wall receptacle provided as part of electrical work. Coordinate receptacle installation with electrical trade on site.
- .15 For emergency showers, install so bottom of shower head is approximately 2 m (82") above floor, and approximately 400 mm (16") out from the wall. Wall mount mixing valve approximately 1.5 m (5') above

floor and adjacent shower head. Set valve temperature limit stop to 35°C (95°F). Ensure valve is open and exposed piping is chrome plated or stainless steel.

- .16 Install eye wash fixtures in accordance with manufacturer's instructions. Ensure exposed piping is painted.
- .17 Wall mount mixing valves for emergency fixtures approximately 1.5 m (5') above floor and secure in place. Check and confirm valve operation and temperature of tempered water supply. Provide cabinets. Identify each cabinet and hand 3 identified cabinet keys to Consultant prior to Substantial Performance of the Work.
- .18 Set mop service basins on floor over drain piping and connect to roughed-in service. Install wall supply trim and any accessories specified.

3.03 CAULKING AT PLUMBING FIXTURES AND FITTINGS

- .1 Caulk around plumbing fixtures and fittings where they contact walls, floors, and any other building surface.
- .2 Clean areas/surfaces to be caulked and prime in accordance with sealant manufacturer's instructions. Where damage to a building surface may occur, mask surface to prevent damage and ensure a clean exact edge to the caulking bead.
- .3 Apply caulking using a gun with proper size and shape of nozzle and force sealant into joints to ensure good surface contact and a smooth and even finished bead of sealant.
- .4 If joints have been masked sealant may be tooled in a continuous stroke to obtain complete void filling. Remove masking tape immediately after tooling and before sealant begins to skin.

3.04 DISHWASHER CONNECTIONS

- .1 Provide roughed-in water and drain connections for Owner supplied dishwasher consisting of:
 - .1 15 mm (½") dia. domestic hot water connection with a Dahl "Mini-Ball" valve with hose end and water hammer arrestor;
 - .2 40 mm (1-½") dia. DWV copper drain connection with "P" trap and cleanout plug.

3.05 CLOTHES WASHER CONNECTIONS

- .1 Provide roughed-in water and drain connections for Owner supplied clothes washer consisting of:
 - .1 15 mm (½") dia. piping connection for both hot and cold water, each terminated in a Dahl "Mini-Ball" Valve with hose end and water hammer arrestor;
 - .2 50 mm (2") dia. standing waste with a height to suit the washer drain and complete with a "P" trap.

End of Section

Project Name: WRDSB Pioneer Park PS Renovations **Date Issued:** March 28, 2024
Quasar Project #: ED-20-312

Distribution
Ward99 Tina Ranieri-D'Ovidio tr@ward99architects.com
Quasar Consulting Group Carl Wagstaff carl.wagstaff@quasarcg.com

Addendum #: E1
Revision #: 0

This Addendum forms part of the Contract Specifications and Drawings, and modifies the Bidding Documents, with Amendments and Additions noted below. This Addendum shall be added to the front of the specifications as issued. Bidders shall acknowledge receipt of this Addendum in the space provided in the Bid Form and include in bid amount.

This addendum includes modifications to the drawings as summarized below. Unless otherwise noted, all drawings listed below are attached herewith.

1.0 Drawings:

1. **DRAWING #E201 – GROUND FLOOR NEW WORK PLANS – ELECTRICAL**
 - a. Refer to detail #2 on this drawing and delete the connections to sensor operated plumbing fixtures in Staff Washroom #128A only.
2. **DRAWING #E303 – ELECTRICAL DETAIL SHEET #2**
 - b. Refer to detail #3 on this drawing and delete Bluetooth radio controller device from this detail.

Quasar Consulting Group
Carl Wagstaff
Electrical Project Manager

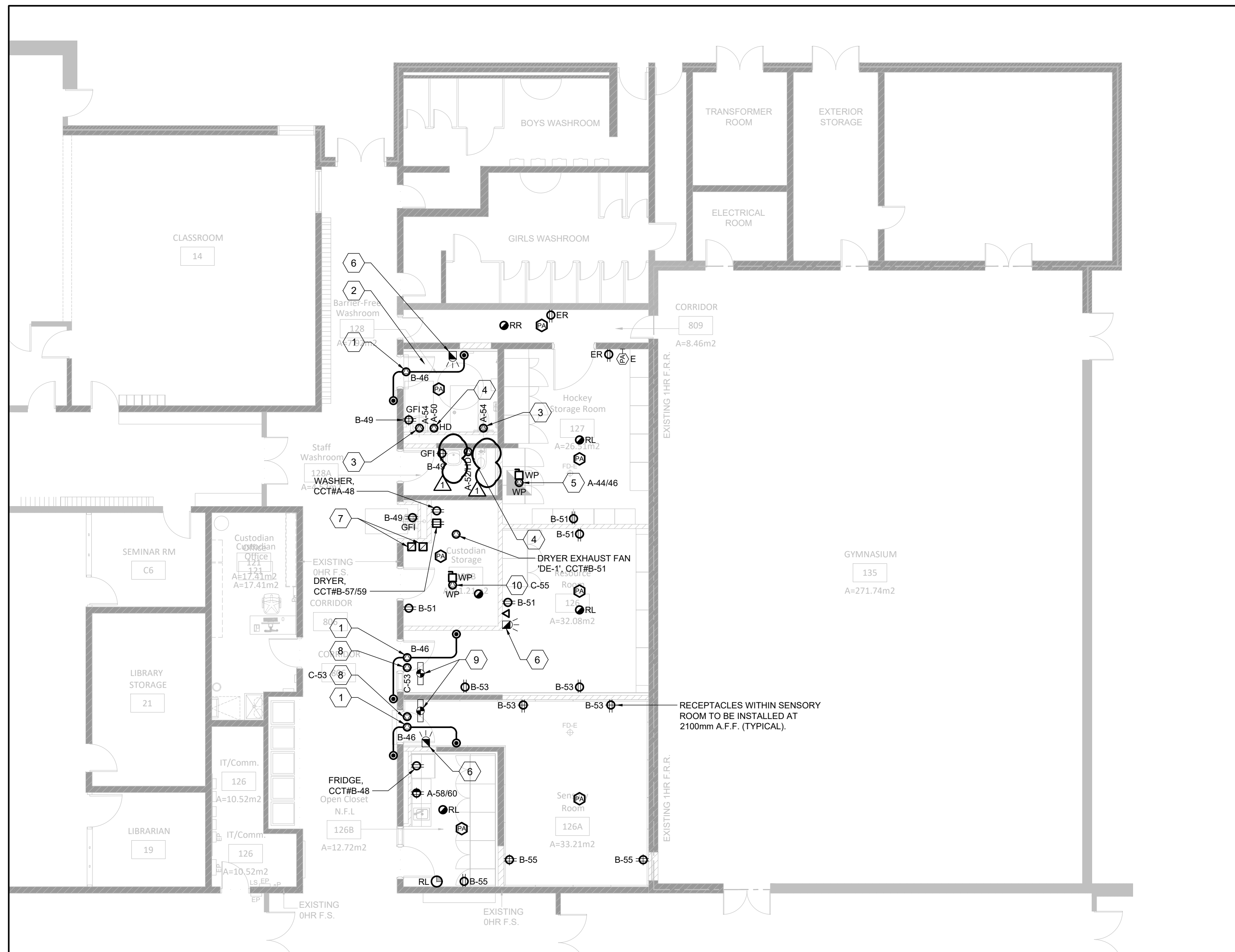

2 PARTIAL GROUND FLOOR NEW WORK PLAN - POWER & SYSTEMS
E201 SCALE: 1:100



1 PARTIAL GROUND FLOOR NEW WORK PLAN - LIGHTING
E201 SCALE: 1:100

PROJECT GENERAL NOTES

- LOCATION OF DEVICES AND LUMINAIRES ARE NOTED FOR DIAGRAMMATIC PURPOSES. CONTRACTOR SHALL BE RESPONSIBLE TO REVIEW ARCHITECTURAL ELEVATIONS AND REFLECTED CEILING PLANS AND SITE CONDITIONS FOR EXACT DEVICE AND LUMINAIRE PLACEMENT.
- BE RESPONSIBLE TO COORDINATE ALL FINAL EQUIPMENT LOCATIONS AND ELECTRICAL CONNECTIONS TO MECHANICAL EQUIPMENT WITH MECHANICAL CONTRACTOR ON SITE.
- BE RESPONSIBLE TO UPDATE ALL EXISTING PANELBOARD DIRECTORIES TO SUIT NEW DEVICE AND LIGHTING CONNECTIONS. PROVIDE NEW DIRECTORIES TO REPLACE EXISTING.
- ALL NEW BRANCH FEEDERS TO NEW WIRING DEVICES SHALL BE 2#10 + GROUND IN 21mm CONDUIT UNLESS NOTED OTHERWISE.
- FOR ALL NEW PUBLIC ADDRESS, TELEPHONE AND DATA CABLING DEVICES NOTED ON THIS DRAWING, ELECTRICAL CONTRACTOR SHALL BE RESPONSIBLE TO PROVIDE THE FOLLOWING:
a) DEVICE BACKBOX, SINGLE GANG UNLESS NOTED OTHERWISE.
b) 21mm (Ø) CONDUIT (UNLESS NOTED OTHERWISE), COMPLETE WITH PULL STRING TO EXTEND FROM DEVICE TO CORRIDOR CEILING SPACE. INCLUDE FOR REQUIRED CORE DRILLING OF EXISTING CORRIDOR WALL AND FIRESTOPPING OF NEW PENETRATION ONCE CONDUIT WORK IS COMPLETE. ALL CABLING AND DEVICES SHALL BE PROVIDED BY A SCHOOL BOARD PREFERRED VENDOR UNDER A PRIME COST ALLOWANCE CARRIED IN DIVISION 1 OF THE CONTRACT.
- DEVICES SHOWN ON NEW WALL CONSTRUCTION SHALL BE INSTALLED FLUSH MOUNTED WITH CONCEALED CONDUITS. DEVICES SHOWN ON EXISTING WALL CONSTRUCTION SHALL BE INSTALLED SURFACE MOUNTED ON FS TYPE BACK BOXES WITH SURFACE RACEWAY (LEGRAND WIREMOLD 400 SERIES OR EQUIVALENT - WHITE), FROM DEVICE UP TO CEILING SPACE. CONDUIT SHALL BE PROVIDED ABOVE CEILING SPACE IN ALL LOCATIONS.

NEW WORK KEY NOTES

LIGHTING:

- PROVIDE NEW BATTERY UNIT BU-4 AND ASSOCIATED RECEPTACLE AND CONNECT TO BRANCH CIRCUIT INDICATED. BATTERY UNIT AND RECEPTACLE TO BE INSTALLED 300mm BELOW FINISHED CEILING.
- NEW LUMINAIRE AND LIGHTING CONTROLS TO BE CONNECTED INTO EXISTING LIGHTING BRANCH CIRCUIT SERVING THIS ROOM. MODIFY EXISTING BRANCH CIRCUIT AS REQUIRED TO ACCOMMODATE NEW LIGHTING AND CONTROLS AND CONNECT COMPLETE.
- NEW ROOM CONTROLLER OR POWER PACK INSTALLED WITHIN CEILING SPACE OF ROOM. CONFIRM EXACT LOCATION ON SITE PRIOR TO INSTALLATION.
- NEW LUMINAIRES TO BE CONNECTED INTO EXISTING LIGHTING BRANCH CIRCUIT AND EXISTING LIGHT SWITCH WITHIN THIS AREA/CORRIDOR.

NEW WORK KEY NOTES

POWER & SYSTEMS:

- PROVIDE CONNECTION TO NEW POWER DOOR OPERATOR AT DOOR HEAD. EXTEND 2#10 + GROUND IN 21mm CONDUIT FROM OPERATOR TO BREAKER IN EXISTING PANEL 'LP-X' AND CONNECT COMPLETE. INCLUDE FOR REQUIRED LINE AND LOAD CONNECTIONS TO ASSOCIATED ACTUATORS.
- REFER TO UNIVERSAL WASHROOM DETAIL ON DRAWING #E302 FOR EXACT REQUIREMENTS AND EQUIPMENT REQUIRED WITHIN THIS SPACE. REFER TO ARCHITECTURAL DETAILS AND INTERIOR ELEVATIONS FOR EXACT PLACEMENT OF DEVICES AND EQUIPMENT.
- CONNECTION TO ELECTRONIC SENSOR OPERATED FAUCET OR WATER CLOSET. EXTEND 2#12 + GROUND IN 21mm CONDUIT FROM BRANCH CIRCUIT INDICATED TO SENSOR LOCATION AND CONNECT COMPLETE. COORDINATE EXACT LOCATION AND FINAL CONNECTIONS WITH PLUMBING CONTRACTOR ON SITE.
- PROVIDE NEW HAND DRYER WITHIN WASHROOM AS INDICATED. FOR BRANCH CIRCUIT NOTED, EXTEND 2#10 + GROUND IN 21mm CONDUIT FROM ASSOCIATED BREAKER TO HAND DRYER LOCATION AND CONNECT COMPLETE. HAND DRYER SHALL BE DYSON AIRBLADE V, MODEL #B07174-01.
- PROVIDE CONNECTION TO NEW ROOF MOUNTED EXHAUST FAN 'EF-2'. FOR BRANCH CIRCUIT INDICATED, EXTEND 2#10 + GROUND IN 21mm CONDUIT FROM ASSOCIATED BREAKER IN PANEL 'LP-X' TO EXHAUST FAN LOCATION AND CONNECT COMPLETE. INCLUDE FOR REQUIRED LINE AND LOAD CONNECTIONS TO ASSOCIATED MOTOR STARTER. COORDINATE EXACT LOCATION AND ALL FINAL CONNECTIONS TO FAN WITH MECHANICAL CONTRACTOR ON SITE.
- PROVIDE NEW FIRE ALARM STROBE LIGHT WITHIN BARRIER-FREE WASHROOM. BE RESPONSIBLE TO MODIFY NEAREST EXISTING ALARM SIGNALING CIRCUIT AS REQUIRED TO ACCOMMODATE NEW STROBE. NEW DEVICE SHALL BE TESTED AND VERIFIED UPON COMPLETION OF WORK.
- APPROXIMATE LOCATION OF LOOSE MOTOR STARTERS FOR NEW ROOF MOUNTED EXHAUST FANS 'EF-2' & 'EF-3'. STARTERS TO BE SUPPLIED BY MECHANICAL CONTRACTOR AND INSTALLED UNDER THIS DIVISION. CONFIRM EXACT LOCATION WITH OWNER ON SITE, PRIOR TO INSTALLATION.
- CONNECTION TO SMOKE/FIRE DAMPER. FOR BRANCH CIRCUIT INDICATED, EXTEND 2#10 + GROUND IN 21mm CONDUIT FROM ASSOCIATED BREAKER IN PANELBOARD TO DAMPER LOCATION AND CONNECT COMPLETE. COORDINATE EXACT LOCATION OF DAMPER AND FINAL CONNECTIONS WITH MECHANICAL CONTRACTOR ON SITE.
- PROVIDE DUCT MOUNTED SMOKE DETECTOR WITHIN SUPPLY AND/OR EXHAUST AIR DUCTWORK WITHIN 1.5M DOWNSTREAM OF THE ASSOCIATED SMOKE DAMPER. DETECTOR SHALL BE INTERCONNECTED WITH DAMPER TO CLOSE DAMPER UPON ACTIVATION OF DETECTOR. ALSO REFER TO DETAIL ON DRAWING #E303. WHERE DUCT MOUNTED SMOKE DETECTORS ARE INSTALLED WITHIN MECHANICAL SHEDS, PROVIDE REMOTE TESTING FEATURE TO BE INSTALLED ADJACENT TO WALL MOUNTED ACCESS PANEL.
- PROVIDE CONNECTION TO NEW ROOF MOUNTED EXHAUST FAN 'EF-3'. FOR BRANCH CIRCUIT INDICATED, EXTEND 2#10 + GROUND IN 21mm CONDUIT FROM ASSOCIATED BREAKER IN PANEL 'LP-X' TO EXHAUST FAN LOCATION AND CONNECT COMPLETE. INCLUDE FOR REQUIRED LINE AND LOAD CONNECTIONS TO ASSOCIATED MOTOR STARTER. COORDINATE EXACT LOCATION AND ALL FINAL CONNECTIONS TO FAN WITH MECHANICAL CONTRACTOR ON SITE.

NOTE: THIS DRAWING IS NOT TO BE SCALED. THE CONTRACTOR IS RESPONSIBLE FOR THE VERIFICATION OF ALL SITE CONDITIONS AND SITE MEASUREMENTS THAT ARE NOT CONSISTENT WITH THE DRAWINGS.

NO.	REVISIONS	DATE
1	ISSUED WITH ADDENDUM E1	2024-MAR-28

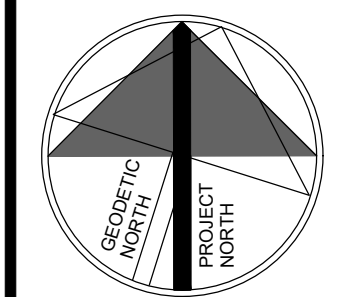

project
PIONEER PARK PUBLIC SCHOOL INTERIOR RENOVATIONS
WATERLOO REGION DISTRICT SCHOOL BOARD
55 UPPER CANADA DRIVE, KITCHENER, ON N2P 1G2
Drawing
GROUND FLOOR NEW WORK PLANS - ELECTRICAL
Drawing Scale
AS SHOWN
ward99 project number
23016 - WRDSB PIONEER PARK
Drawing No.

QUASAR
CONSULTING GROUP
250 ROWNTREE DAIRY RD., WOODBRIDGE, ON
TEL: 905-97-0900
WWW.QUASARGROUP.COM
QUASAR PROJECT No.:
ED-20-312

E201

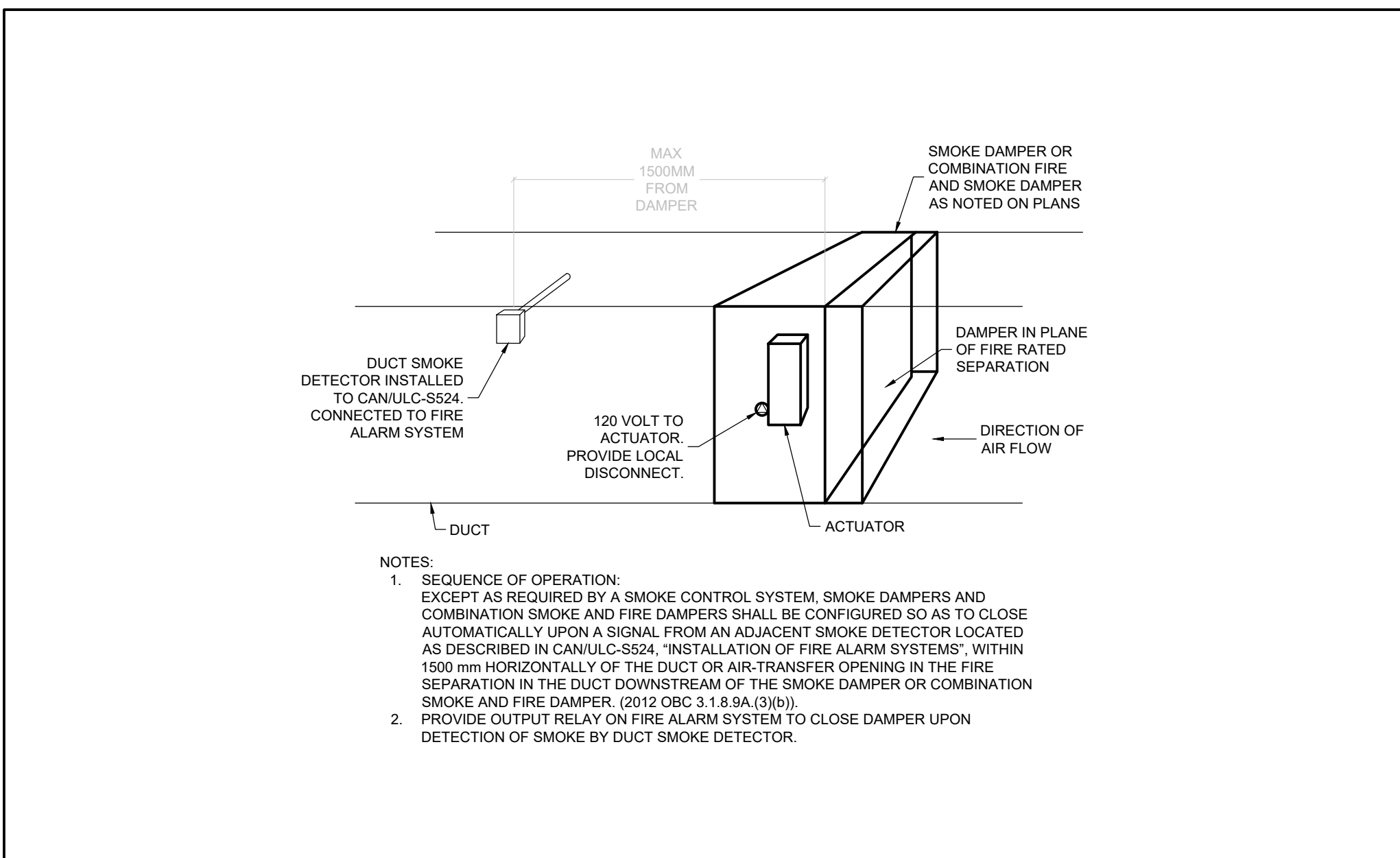

5 SMOKE DAMPER CONNECTION DETAIL
SCALE: NOT TO SCALE

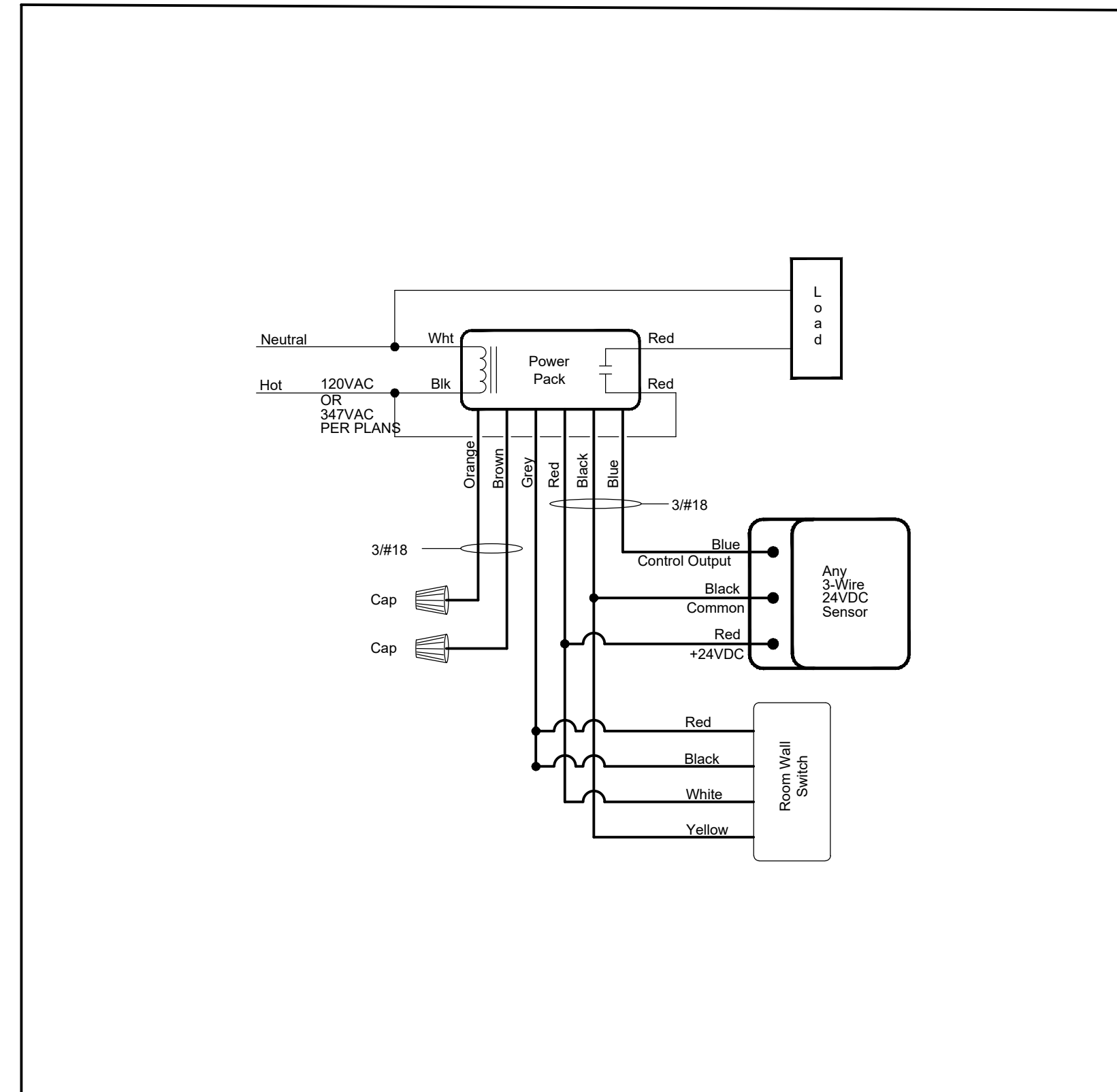

4 TYPICAL NON-DIMMING ROOM LIGHTING CONTROL DETAIL
SCALE: NOT TO SCALE

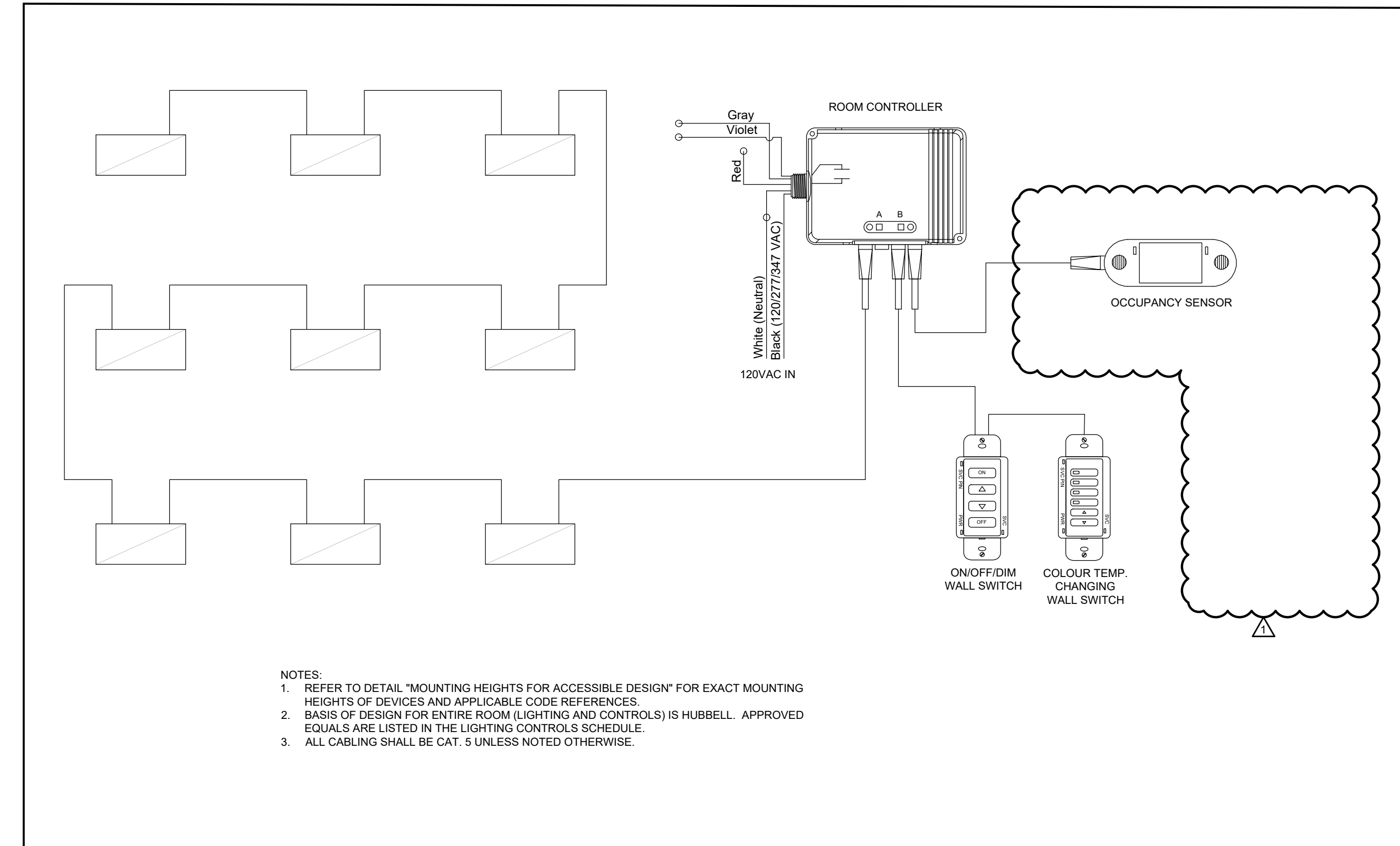

3 SENSORY ROOM LIGHTING CONTROL SCHEMATIC
SCALE: NOT TO SCALE

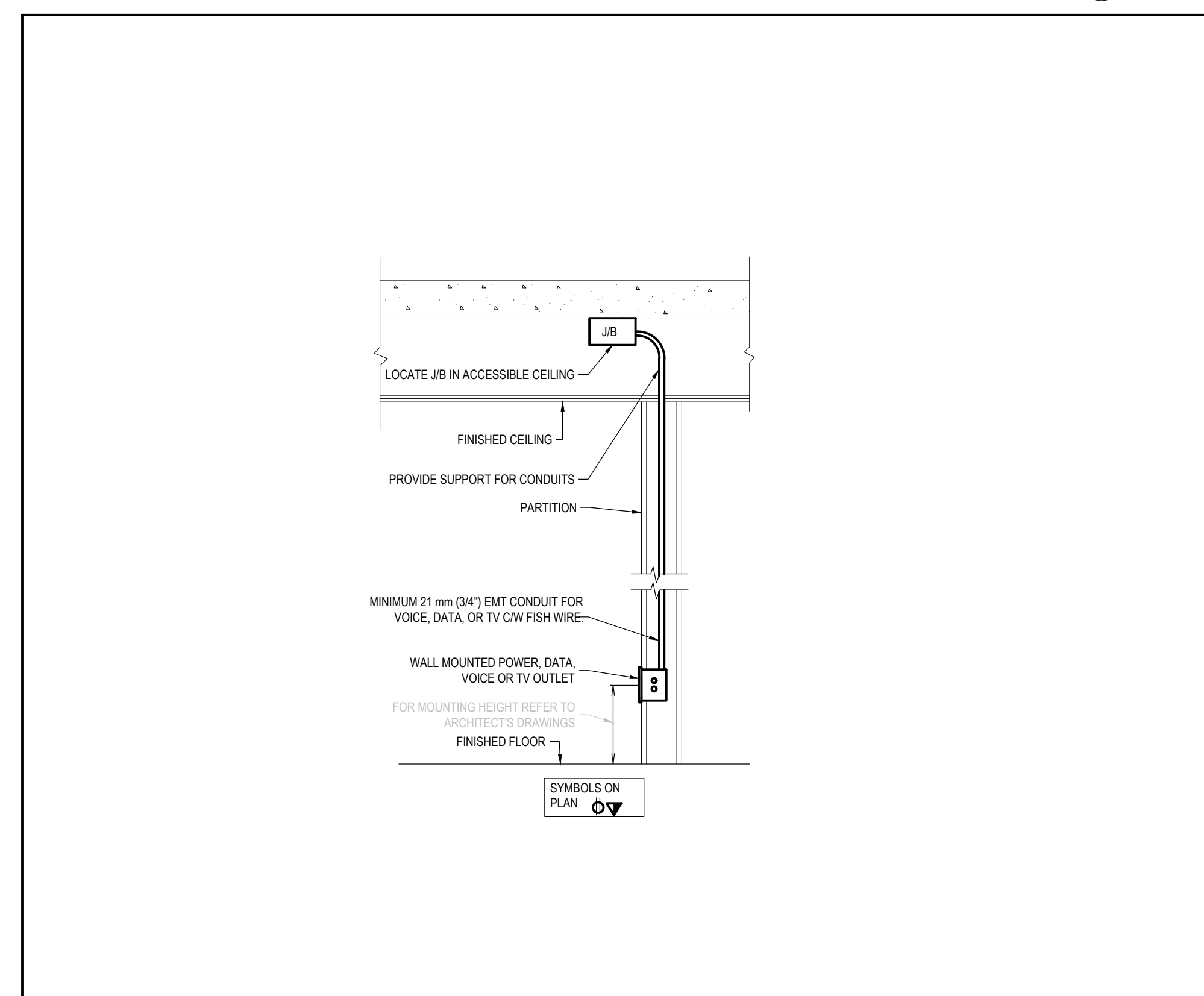

2 DETAIL OF WALL MOUNTED OUTLET BOX
SCALE: NOT TO SCALE

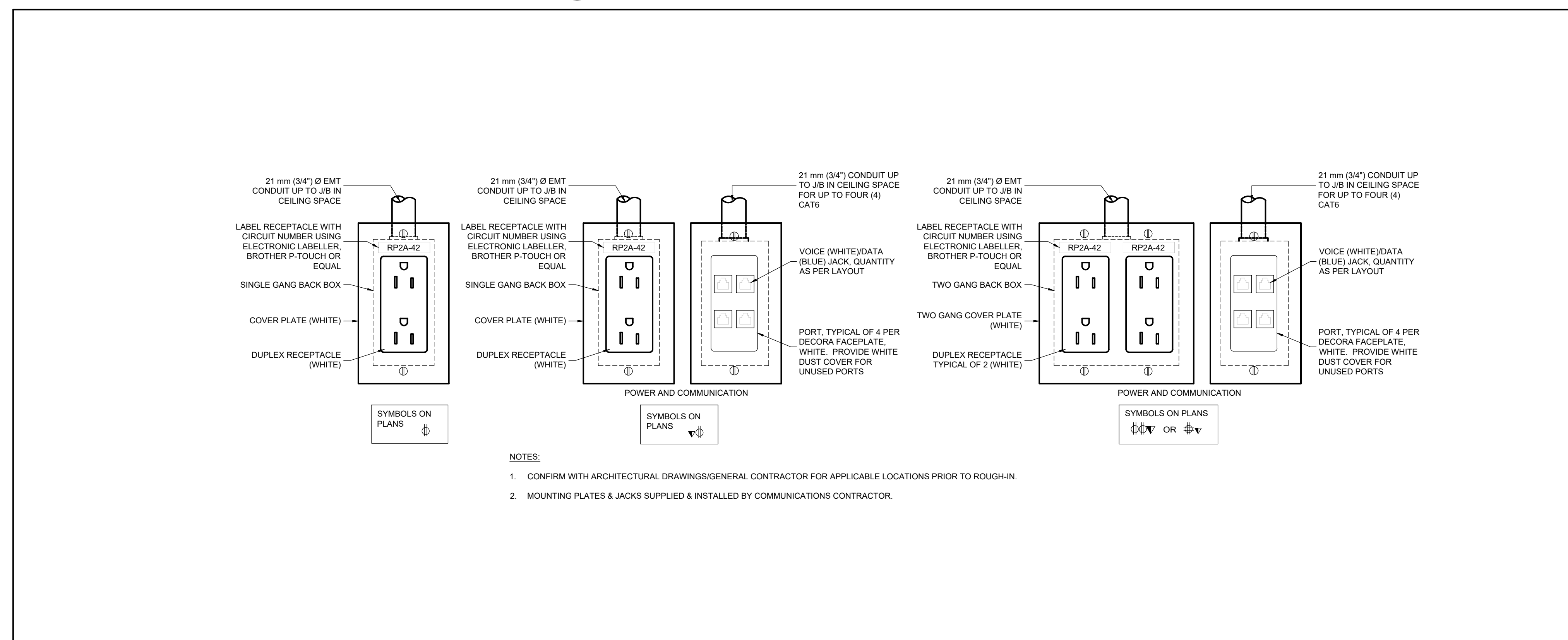

1 DETAIL OF UNGANGED POWER AND COMMUNICATION DEVICES
SCALE: NOT TO SCALE

NOTE: THIS DRAWING IS NOT TO BE SCALED. THE CONTRACTOR IS RESPONSIBLE FOR THE VERIFICATION OF ALL SITE DIMENSIONS AND FOR NOTIFYING THE ARCHITECT OF ANY SITE CONDITIONS AND SITE MEASUREMENTS THAT ARE NOT CONSISTENT WITH THE DRAWINGS.

NO.	DESCRIPTION	DATE
1	ISSUED WITH ADDENDUM E1	2024-MAR-28

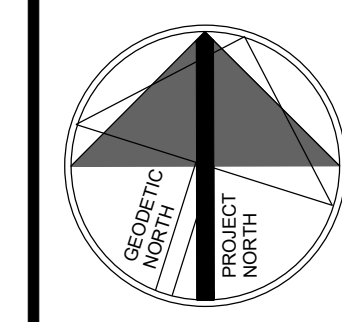

PROJECT
PIONEER PARK PUBLIC SCHOOL INTERIOR RENOVATIONS
 WATERLOO REGION DISTRICT SCHOOL BOARD
 55 UPPER CANADA DRIVE, KITCHENER, ON N2P 1G2
 Drawing
ELECTRICAL DETAIL SHEET NO. 2
 Drawing Scale
 AS SHOWN
 Ward99 project number
 23016 - WRDSB PIONEER PARK

QUASAR
 CONSULTING GROUP
 250 ROWNTREE DAIRY RD., WOODBRIDGE, ON
 TEL: 905-977-0900
 WWW.QUASARGROUP.COM

E303

QUASAR PROJECT No.: ED-20-312