



## **Addendum #2**

### **Bid Opportunity: 22-7352-RFT - Central Public School - Accessibility, HVAC & Window Upgrades** **Closing Date: Tuesday, January 17, 2023 2:00 PM**

---

The following issued by the Board shall form part of the Bid / Proposal Solicitation document. The revisions and additions noted herein along with any attachments shall be read in conjunction with all other related documents. This Addendum shall, take precedence over the previously issued documents where differences occur. Receipt of this addendum must be acknowledged in the Bidding System, bids&tenders.

If you have already submitted a Bid / Proposal, it will be automatically withdrawn as a result of this addendum. You must resubmit the Bid / Proposal acknowledging all addenda and revising your Bid / Proposal to comply with all addenda.

#### **Question 1:**

Please provide a specification for the roller shades.

**Answer 1:**

**Roller shades are covered by the project Cash Allowance. Specifications will be provided at a later date to the successful Bidder.**

**Question 2:**

Please let us know if we need building risk insurance or not?

**Answer 2:**

**Builder's Rick Insurance is required.**

**Question 3:**

Is there a preferred list of sub contractors list to be followed for this project?

**Answer 3:**

**Refer to specification 00 21 14 Vender of Record, section 3.0 Subcontractors.**

**See revision to specification section 00 21 14 Vendors of Record, below.**

**Question 4:**

Finishing Hardware Schedule – Section 00 00 10 - Table of Contents – pg 2 of 7 notes section 08 71 15 – Finishing Hardware Schedule (1+68 pages). Is this hardware schedule available? We'll need to know what hardware is to be prepped for on the aluminum door(s). Please advise.

**Answer 4:**

**Finish Hardware is covered by the project Cash Allowance**

**Question 5:**

100 mm Deep Exterior Snap Cap – Section 08 44 13 – 2.1.4 notes 'Provide 100 mm extended pressure cap where noted on drawings.' I cannot find any such extended snap caps on the architectural drawing elevations or details. Are they required on any of the curtain wall frames? Please review and advise.

**Answer 5:**

**Extended pressure caps are not required on this project.**

**Question 6:**

Exterior Infill Panels – Section 08 44 13 – 2.1.15 notes infill panels in (3) additional colours other than anodized. Are these infill panels required? I cannot

locate them on any of the drawings. Please advise.

**Answer 6:**

**Item 2.1.15 is not applicable to this project.**

**Question 7:**

Exterior Sunshades – Section 08 44 13 – 2.1.16 notes sunshades at the exterior curtain wall frames. None are shown on the drawings. Are they required at any of the exterior openings? Please advise.

**Answer 7:**

**Item 2.1.16 is not applicable to this project.**

**Question 8:**

Display Cases – Section 08 80 50 – 2.1.14 notes display cases with glass shelves and doors. I cannot find any such glazing on the drawing plans or details. Are there display cases required? Please advise.

**Answer 8:**

**Item 2.1.14 is not applicable to this project.**

**Question 9:**

'W5' Exterior Window – There is no 'W5' window shown on the drawing A01 – Aluminum Windows Schedule nor is it shown on the drawing plans / elevations. Not required? Please review and confirm.

**Answer 9:**

**There is no 'W5' window on this project.**

**Question 10:**

Interior Framing at Library 117 – Construction note #13 on drawing A04 'new wiremold' framing. Is the framing / glazing to be included in our scope of work? I cannot find any further information for this interior framing. Please review and advise.

**Answer 10:**

**New electrical wiremold is to be installed on existing hollow metal glazing frames.**

**Question 11:**

In the subcontractor list in the bidding summation forms in the website mentioned that :

Bidders shall select Subcontractors that are members of GVCA (Grand Valley Construction Association) and/or OGCA (Ontario General Contractors Association)

It is a little confusing for us and the sub- Contractor, Please let us know if they all needed to be a part of that organizations or some of the subs should be in the category. If that is the case which subs needed to be in those organizations?

**Answer 11:**

**See revision to specification section 00 21 14 Vendors of Record, below.**

**Question 12:**

Can we use Saafien's Reynaers Aluminium Concept Wall 50, Model CS 77 as an alternate for curtain wall? As bids & tenders doesn't have the provision to upload documents, specifications and drawings for the same can be provided upon request.

**Answer 12:**

**The Owner is not able to fully vet the proposed alternate product based on information provided at this time. For future consideration, please contact the Procurement department at the School Board for further review.**

**Question 13:**

The finish legend speaks of carpet in library 117 but the finish drawings do not show anything nor is there any specifications. Please clarify.

**Answer 13:**

**The existing carpet in the library is to remain.**

**Question 14:**

Please confirm if there are to be new window sills at all window types i.e. W1, W2, W3, W4, W6?

**Answer 14:**

**All windows, except W4, require a window sill. Refer to wall sections.**

**Question 15:**

Please clarify if window sills are to be post-formed or square self-edged?

**Answer 15:**

**Windows sills to have post-formed edge.**

**Question 16:**

There are multiple openings on the Door Schedule with a note of New HM Door and Frame size to match existing opening. Can you please advise of the existing opening sizes? This applies to the following openings: 101BA, 102AA, 102CB, 106A, 108A (height only), 109A, 201BA, 202AA, 202BA, 203BA (width only), X205B, X209B, and 211A

**Answer 16:**

**Refer to attached Door Schedule.**

**AMENDMENTS TO SPECIFICATIONS**

**Item 1 – Section 00 00 10 Table of Contents**

.1 DELETE item “08 71 15 Finish Hardware Schedule”.

**Item 2 – Section 00 21 14 Vendors of Record**

.1 DELETE item 3.1  
“~~Bidders shall select Subcontractor that are a member of GVCA (Grand Valley Construction Association) and/or OGCA (Ontario General Contractors Association)~~”

**Item 3 – Section 08 11 15 Door Schedule**

.1 REPLACE Door Schedule with attached.

**Item 4 – Section 08 44 13 Glazed Aluminum Curtian Walls**

.1 REVISE item 2.1.4 to read:  
“Standard pressure cap for most all locations. ~~Provide 100mm extended pressure cap where noted on drawings.~~”

- .2 DELETE item 2.1.15  
“Allow for three (3) additional colours of exterior infill panels other than anodized. Enamel finish shall be PPG Duranar finish (Kynar 500), 10,000 series or approved alternate.”
- .3 DELETE item 2.1.16  
“Curtain wall sunshades designated ‘SS’ to be 36” deep Kawneer Versoleil Sunshade, CRL 3600 or similar profile by McGill. Confirm compatibility of sunshade with curtainwall to be supplied. Sunshades must be supplied and installed by the installer of the curtain wall system as an integral component of framing.”

## **MECHANICAL & ELECTRICAL**

### **Item 5: Electrical**

- .1 Please find attached one (1) typed page of instructions, and one (1) full size drawing, Mechanical and Electrical Addendum 01, issued by DEI Consulting Engineers, dated January 9, 2023.

**End of Addendum No. 2**

**GENERAL NOTES**

- 1 This schedule MUST be read in conjunction with a complete set of drawings and a complete Hardware Schedule.
- 2 Refer to Drawing A-01 Series for door, frame & jamb types and details.

**ABBREVIATION CODES**

The following abbreviations are used in the Door Schedule

<u>Code</u>	<u>Reference</u>
DC	Door Contact
PT	Paint
ANNO.	Anodized Finish
HT	Heavy Traffic - See specs for welded seams, special reinforcing
20 MIN	20 minute Fire Rating
45 MIN	45 minute Fire Rating
HM	Hollow Metal
TG	Tempered Glass
B/F	Barrier-Free
ALUM.	Aluminum
FR	Fire Rated Glass
LG	Laminated Glass
FDG	Door Grille
IGU	Insulated glass unit
CW	Curtain wall
PDO	Power door Operator
SC	SCREEN
EX	Existing to Remain

**REMARK NOTES**

DOOR		DOOR								FRAME					REMARKS
#	ROOM	WIDTH	HEIGHT	FIRE	H.T.	TYPE	MAT'L	FIN	GLASS	TYPE	MAT'L	FIN	DC	GLASS	
<b>LOWER FLOOR</b>															
101AA	CLASSROOM 10 - 101A	950	+/-2085	45 MIN.	-	C	HM	PT	FR	1	HM	PT	-	-	
101BA	RESOURCE ROOM 101B	+/-815	+/-2085	45 MIN.	-	C	HM	PT	FR	1	HM	PT	-	-	NEW HM DOOR AND FRAME SIZE TO MATCH EXISTING OPENING. B/F DOOR OPERATOR TO BE INSTALLED ON ROOM SIDE
101CB	CLASSROOM 11 - 101C	950	+/-2085	45 MIN.	-	C	HM	PT	FR	1	HM	PT	-	-	
101DA	STORAGE 101D	EXISTING DOOR AND FRAME TO REMAIN													
X101EA	ALCOVE 101E	EXISTING DOOR AND FRAME TO REMAIN													
X101EB	ALCOVE 101E	EXISTING DOOR AND FRAME TO REMAIN													
102AA	CLASSROOM 12 - 102A	+/-815	+/-2085	45 MIN.	-	C	HM	PT	FR	1	HM	PT	-	-	NEW HM DOOR AND FRAME SIZE TO MATCH EXISTING OPENING. B/F DOOR OPERATOR TO BE INSTALLED ON ROOM SIDE
102CB	CLASSROOM 13 - 102C	+/-815	+/-2085	45 MIN.	-	C	HM	PT	FR	1	HM	PT	-	-	NEW HM DOOR AND FRAME SIZE TO MATCH EXISTING. B/F DOOR OPERATOR TO BE INSTALLED ON ROOM SIDE
X102CC	CLASSROOM 13 - 102C	EX.	EX.	EX.	EX.	EX.	EX.	PT	EX.	EX.	EX.	PT	-	-	
X102CD	CLASSROOM 13 - 102C	EX.	EX.	EX.	EX.	EX.	EX.	PT	EX.	EX.	EX.	PT	-	-	
X102DA	COATS 102D	EXISTING DOOR AND FRAME TO REMAIN													
X102DB	COATS 102D	EXISTING DOOR AND FRAME TO REMAIN													
X102EA	WASHROOM 102E	EXISTING DOOR AND FRAME TO REMAIN													
X102FA	WASHROOM 102F	EX.	EX.	EX.	EX.	EX.	EX.	PT	EX.	EX.	EX.	PT	-	-	
X104A	CUSTODIAN 104	EXISTING DOOR AND FRAME TO REMAIN													
X104B	CUSTODIAN 104	EXISTING DOOR AND FRAME TO REMAIN													
X105A	MECHANICAL 105	EXISTING DOOR AND FRAME TO REMAIN													



DOOR # ROOM		DOOR								FRAME					REMARKS
		WIDTH	HEIGHT	FIRE	H.T.	TYPE	MAT'L	FIN	GLASS	TYPE	MAT'L	FIN	DC	GLASS	
X105B	MECHANICAL 105	EXISTING DOOR AND FRAME TO REMAIN													
106A	BOY'S WASHROOM 106	+/-915	+/-2085	45 MIN.	-	A	HM	PT	-	1	HM	PT	-	-	NEW HM DOOR AND FRAME SIZE TO MATCH EXISTING. ELECTROMAGNETIC HOLD OPEN
X107A	STAFF WR107	EXISTING DOOR AND FRAME TO REMAIN													
108A	BF WR 108	950	+/-2085	45 MIN.	-	A	HM	PT	-	1	HM	PT	-	-	<b>NEW HM DOOR AND FRAME HEIGHT TO MATCH EXISTING.</b> B/F DOOR OPERATOR TO BE INSTALLED ON WASHROOM SIDE
109A	GIRL'S WASHROOM 109	+/-915	+/-2085	45 MIN.	-	A	HM	PT	-	1	HM	PT	-	-	NEW HM DOOR AND FRAME SIZE TO MATCH EXISTING. ELECTROMAGNETIC HOLD OPEN
X115A	TRANSFORMER 115	EXISTING DOOR AND FRAME TO REMAIN													
X116A	SPRINKLER ROOM 116	EXISTING DOOR AND FRAME TO REMAIN													
117A	LIBRARY 117	1000	2150	45 MIN.	-	D	HM	PT	FR	4	HM	PT	-	FR	B/F DOOR OPERATOR TO BE INSTALLED ON LIBRARY SIDE
117B	LIBRARY 117	1000	2150	45 MIN.	-	D	HM	PT	FR	4	HM	PT	-	FR	B/F DOOR OPERATOR TO BE INSTALLED ON LIBRARY SIDE
X119A	WORK ROOM 119	EXISTING DOOR AND FRAME TO REMAIN													
X119B	WORK ROOM 119	EXISTING DOOR AND FRAME TO REMAIN													
A131A	SEMINAR A131	1000	+/-2085	-	-	E	ALUM.	ANNO.	TG	CW1	ALUM.	ANNO.	-	TG	WEATHER STRIPPING. REFER TO STOREFRONT SCHEDULE.
A131B	SEMINAR A131	1000	+/-2085	45 MIN.	-	D	HM	PT	FR	1	HM	PT	-	-	B/F DOOR OPERATOR TO BE INSTALLED ON SEMINAR ROOM SIDE <b>NO LOCK - EXIT DOOR</b>
A132A	MACHINE ROOM A132	950	+/-2085	45 MIN.	-	A	HM	PT	-	1	HM	PT	-	-	
A133A	SUMP PIT ROOM A133	950	+/-2085	45 MIN.	-	A	HM	PT	-	1	HM	PT	-	-	
X805A	VESTIBULE 805	EXISTING DOOR AND FRAME TO REMAIN													
X805B	VESTIBULE 805	EXISTING DOOR AND FRAME TO REMAIN													
X806A	VESTIBULE 806	EX.	EX.	EX.	EX.	EX.	EX.	PT	EX.	EX.	EX.	PT	-	-	EXISTING DOOR AND FRAME TO BE PAINTED. NEW B/F DOOR OPERATOR TO BE INSTALLED ON VESTIBULE SIDE.

DOOR		DOOR								FRAME					REMARKS
#	ROOM	WIDTH	HEIGHT	FIRE	H.T.	TYPE	MAT'L	FIN	GLASS	TYPE	MAT'L	FIN	DC	GLASS	
X806B	VESTIBULE 806	EX.	EX.	EX.	EX.	EX.	EX.	PT	EX.	EX.	EX.	PT	-	-	EXISTING DOOR AND FRAME TO BE PAINTED. NEW B/F DOOR OPERATOR TO BE INSTALLED ON CORRIDOR SIDE.
<b>SECOND FLOOR</b>															
201AA	CLASSROOM 9 - 201A	950	+/-2085	45 MIN.	-	C	HM	PT	FR	1	HM	PT	-	-	
201BA	RESOURCE ROOM 201B	+/-815	+/-2085	45 MIN.	-	C	HM	PT	FR	1	HM	PT	-	-	NEW HM DOOR AND FRAME SIZE TO MATCH EXISTING OPENING. B/F DOOR OPERATOR TO BE INSTALLED ON ROOM SIDE
201CB	CLASSROOM 2 - 201C	950	+/-2085	45 MIN.	-	C	HM	PT	FR	1	HM	PT	-	-	
X201DA	NURSE 201D	EXISTING DOOR AND FRAME TO REMAIN													
X201EA	ALCOVE 201E	EXISTING DOOR AND FRAME TO REMAIN													
X201EB	ALCOVE 201E	EXISTING DOOR AND FRAME TO REMAIN													
202AA	CLASSROOM 7 - 202A	+/-815	+/-2085	45 MIN.	-	C	HM	PT	FR	1	HM	PT	-	-	NEW HM DOOR AND FRAME SIZE TO MATCH EXISTING OPENING. B/F DOOR OPERATOR TO BE INSTALLED ON ROOM SIDE
202BA	RESOURCE ROOM - 202B	+/-815	+/-2085	45 MIN.	-	C	HM	PT	FR	1	HM	PT	-	-	NEW HM DOOR AND FRAME SIZE TO MATCH EXISTING OPENING. B/F DOOR OPERATOR TO BE INSTALLED ON ROOM SIDE
202CA	CLASSROOM 6 - 202C	950	+/-2085	45 MIN.	-	C	HM	PT	FR	1	HM	PT	-	-	DOOR SWING TO BE TOWARDS CLASSROOM
202DA	SEMINAR 202D	950	+/-2085	45 MIN.	-	C	HM	PT	FR	3	HM	PT	-	FR	
X202EA	ALCOVE 202E	EXISTING DOOR AND FRAME TO REMAIN													
X202EB	ALCOVE 202E	EXISTING DOOR AND FRAME TO REMAIN													
203AA	CLASSROOM 5 - 203A	950	+/-2085	45 MIN.	-	C	HM	PT	FR	1	HM	PT	-	-	DOOR SWING TO BE TOWARDS CLASSROOM
203BA	SPECIAL EDUCATION 203B	+/-815	+/-2085	45 min.	-	C	HM	PT	FR	1	HM	PT	-	-	NEW HM DOOR AND FRAME SIZE TO MATCH EXISTING OPENING. B/F DOOR OPERATOR TO BE INSTALLED ON ROOM SIDE

DOOR # ROOM		DOOR								FRAME					REMARKS
		WIDTH	HEIGHT	FIRE	H.T.	TYPE	MAT'L	FIN	GLASS	TYPE	MAT'L	FIN	DC	GLASS	
203CA	CLASSROOM 4 - 203C	950	+/-2085	45 min.	-	C	HM	PT	FR	1	HM	PT	-	-	DOOR SWING TO BE TOWARDS CLASSROOM.
203DA	RESOURCE ROOM 203D	950	+/-2085	45 min.	-	C	HM	PT	FR	3	HM	PT	-	FR	
X203EA	ALCOVE 203E	EXISTING DOOR AND FRAME TO REMAIN													
X203EB	ALCOVE 203E	EXISTING DOOR AND FRAME TO REMAIN													
X205B	BOY'S WASHROOM 205	+/-915	+/-2085	45 MIN.	-	A	HM	PT	-	1	HM	PT	-	-	NEW HM DOOR AND FRAME SIZE TO MATCH EXISTING. ELECTROMAGNETIC HOLD OPEN
X206A	STAFF WR 206	EXISTING DOOR AND FRAME TO REMAIN													
X207A	STAFF WR 207	EXISTING DOOR AND FRAME TO REMAIN													
X208A	CUSTODIAN 208	EXISTING DOOR AND FRAME TO REMAIN													
X208B	CUSTODIAN 208	EXISTING DOOR AND FRAME TO REMAIN													
X209B	GIRL'S WASHROOM 209	+/-915	+/-2085	45 MIN.	-	A	HM	PT	-	1	HM	PT	-	-	NEW HM DOOR AND FRAME SIZE TO MATCH EXISTING. ELECTROMAGNETIC HOLD OPEN
211A	GENERAL PURPOSE ROOM	2X +/-915	+/-2085	45 MIN.	-	D	HM	PT	FR	2	HM	PT	-	-	NEW HM DOOR AND FRAME SIZE TO MATCH EXISTING OPENING. B/F DOOR OPERATOR TO BE INSTALLED ON GYM SIDE, 180° DEGREE SWING
X211B	GENERAL PURPOSE ROOM	EXISTING DOOR AND FRAME TO REMAIN													
X211C	GENERAL PURPOSE ROOM	EXISTING DOOR AND FRAME TO REMAIN													
X211D	GENERAL PURPOSE ROOM	EXISTING DOOR AND FRAME TO REMAIN													
X214A	SUPPLY ROOM 214	EXISTING DOOR AND FRAME TO REMAIN													
X214AA	KILN 214A	EXISTING DOOR AND FRAME TO REMAIN													
X215A	PRINCIPAL 215	EXISTING DOOR AND FRAME TO REMAIN													
X215B	PRINCIPAL 215	EXISTING DOOR AND FRAME TO REMAIN													
216A	MAIN OFFICE 216	EXISTING DOOR AND FRAME TO REMAIN													
X218A	STAFF ROOM 218	EXISTING DOOR AND FRAME TO REMAIN													

DOOR		DOOR								FRAME					REMARKS
		WIDTH	HEIGHT	FIRE	H.T.	TYPE	MAT'L	FIN	GLASS	TYPE	MAT'L	FIN	DC	GLASS	
#	ROOM														
X218B	STAFF ROOM 218	EXISTING DOOR AND FRAME TO REMAIN													
X219A	FRENCH ROOM	EXISTING DOOR AND FRAME TO REMAIN													
X220A	GYM STORAGE 220	EXISTING DOOR AND FRAME TO REMAIN													
221A	BF WASHROOM	EXISTING DOOR AND FRAME TO REMAIN													NEW B/F DOOR OPERATOR TO BE INSTALLED ON WASHROOM SIDE.
X221AA	STORAGE 221A	EXISTING DOOR AND FRAME TO REMAIN													
X222	CUSTODIAN 222	EXISTING DOOR AND FRAME TO REMAIN													
X223	KINDERGARTEN 3 - 223	EXISTING DOOR AND FRAME TO REMAIN													
X223AA	WASHROOM 223A	EXISTING DOOR AND FRAME TO REMAIN													
X224A	KINDERGARTEN 2 - 224	EXISTING DOOR AND FRAME TO REMAIN													
X224AA	WASHROOM 224A	EXISTING DOOR AND FRAME TO REMAIN													
X225A	KINDERGARTEN 1 - 225	EXISTING DOOR AND FRAME TO REMAIN													
X225AA	WASHROOM 225A	EXISTING DOOR AND FRAME TO REMAIN													
X816A	CORRIDOR 816	EXISTING DOOR AND FRAME TO REMAIN													
X817A	CORRIDOR 817	EXISTING DOOR AND FRAME TO REMAIN													
X818A	CORRIDOR 818	EXISTING DOOR AND FRAME TO REMAIN													
X818B	CORRIDOR 818	EXISTING DOOR AND FRAME TO REMAIN													
X820A	CORRIDOR 820	EXISTING DOOR AND FRAME TO REMAIN													
X820B	CORRIDOR 820	EXISTING DOOR AND FRAME TO REMAIN													
X822B	VESTIBULE 822	EXISTING DOOR AND FRAME TO REMAIN													
X822A	VESTIBULE 822	EXISTING DOOR AND FRAME TO REMAIN													
X901A	STAIR 901	EXISTING DOOR AND FRAME TO REMAIN													

DOOR		DOOR							FRAME					REMARKS
		WIDTH	HEIGHT	FIRE	H.T.	TYPE	MAT'L	FIN	GLASS	TYPE	MAT'L	FIN	DC	
#	ROOM													
X902A	STAIR 902	EXISTING DOOR AND FRAME TO REMAIN												
X902B	STAIR 902	EXISTING DOOR AND FRAME TO REMAIN												

January 9, 2023

Client: Hossack & Associates Architect Inc.  
2150 Dunwin Drive, Unit 4  
Mississauga, Ontario L5L 5M8

RE: Central Public School – Accessibility Upgrades  
Cambridge, Ontario

Job #: 21378

Attn: Shauna Coates, B.Arch.Sc., LEED Green Assoc, OAAS/Gabriela Betancourt/  
Priscilla Ladouceur, B.E.S., B.Arch., OAA, MRAIC

## ADDENDUM 01

### MECHANICAL

No mechanical content.

### ELECTRICAL

#### Item 1

#### 1.0 Light Fixture Schedule Updates

- .1 In the light fixture schedule the following updates have been made as per attached re-issued drawing E01:
1. Type L1 – Signify cat. # has been revised.
  2. Type L2 – Signify cat. # revised to Liteline.
  3. Type L3 – Signify cat. # revised to Liteline.
  4. Type L6 – Lightolier and Halo cat. Numbers added and track length shown in description.
  5. Emerg Battery – Aimlite cat. # revised.

Kevin Fox, C.Tech.

21378 Addendum 01 (E-Light Fixture Schedule Updates)(reissued dwg E01) Jan 9 23  
kf/sad



Item	Manufacturer/Catalog Number	Voltage	Lamp	Mounting	Description
L	COOPER CAT. #H610010-HM60525-840-61MDHWF LITHONIA CAT. #LDNG SERIES SIGNIFY CAT. #RNRN SERIES	120V	LED 1000 LUMENS 4000K 10W	RECESSED	RECESSED 6" (150mm) DIAMETER LED DOWNLIGHT C/W SELF-FLANGED 60 DEGREE BEAM REFLECTOR, SEMI-SPECULAR CLEAR LENS, AND 1% 0-10V DIMMING DRIVER. ARCHITECT TO CONFIRM FLANGE FINISH.
L1	METALLUX CAT. #24C22-55-S-UNV-L840-CD-1 LITHONIA CAT. #LDNG SERIES SIGNIFY CAT. #RNRN SERIES	120	51W LED 557lm 4000K	RECESSED	2'x4' (610mmx1220mm) RECESSED SHALLOW VOLUMETRIC LED FIXTURE C/W SMOOTH FROSTED ACRYLIC LENS AND 0-10V DIMMING DRIVER. FIXTURE MUST HAVE A FIRE RATED TROFFER COVER INSTALLED AS NOTED ON RENOVATION DRAWING AND FIXTURE MUST BE IC (INSULATION CONTACT) RATED (DUE TO THE FIRE RATED COVER).
L2	COOPER CAT. #24F4740C LITHONIA CAT. #LDNG SERIES SIGNIFY CAT. #RNRN SERIES	120V	LED 4556 LUMENS 4000K 41W	SURFACE	2'x4' (610mmx1220mm) LED FLAT PANEL FIXTURE C/W WHITE FROSTED LENS, 10% 0-10V DIMMING DRIVER, STANDARD WHITE FINISH AND SURFACE MOUNTING KIT.
L3	COOPER CAT. #14F4240C LITHONIA CAT. #LDNG SERIES SIGNIFY CAT. #RNRN SERIES	120V	LED 4226 LUMENS 4000K 39W	SURFACE	1'x4' (305mmx1220mm) LED FLAT PANEL FIXTURE C/W WHITE FROSTED LENS, 10% 0-10V DIMMING DRIVER, STANDARD WHITE FINISH AND SURFACE MOUNTING KIT.
L4	COOPER CAT. #4NED-105-4H5-LN-UNV-L840-CD-1-1C-W/SNF-4T LITHONIA CAT. #SSS-148-400LM-MQLT-40K-80CR/MQSS SIGNIFY CAT. #SSS448L840-LN-DM C/W FSNM64 & FRR-126	120	38W LED 4500lm 4000K	SURFACE	4' (1220mm) SURFACE LED STRIP LIGHT C/W WIDE LENSED OPTICAL DISTRIBUTION, CHAIN SUSPENSION KIT WHERE REQUIRED, 10% 0-10V DIMMING DRIVER, AND WIRE GUARD.
L5	3D LIGHTING CAT. #304PJ-DI-1750-1250-SB0-40K-UNV-DM-FL-60-10-C-8 ALIGHT LIGHTING CAT. #LD2ST SERIES AXIS CAT. #TBD4LED SERIES	120V	120W LED 2500lm UP PER FT 750m DN PER FT 4000K	SUSPENDED	8'x3.8" (2440mmx889mm) DIRECT/INDIRECT SUSPENDED LED FIXTURE C/W EXTRUDED ALUMINUM HOUSING, FLUSH SATIN ACRYLIC DIFFUSER LENS AND AIRCRAFT CABLE SUSPENSION. COLOUR TO BE SELECTED BY ARCHITECT.
L6	JUNO CAT. (TRACK) #TRAC-LITES R SERIES LUMACELL CAT. #LUMACELL-POW-FL-COL LIGHTOLIER (HEADS) #LIT08WPB32X30X LIGHTOLIER (TRACK) #R000N SERIES HALO (HEADS) #H012 SERIES HALO (TRACK) #HALO TRAC	120V	LED 800 LUMENS 3500K 10W PER HEAD CONTINUOUS RUN	SURFACE	LED TRACK LIGHTING FIXTURE C/W DIE CAST ALUMINUM CONSTRUCTION, ADJUSTABLE ARM AND FLOOD DISTRIBUTION C/W LOW PROFILE SINGLE CIRCUIT TRACK SYSTEM WITH ALL CONNECTORS/FITTINGS/COMPONENTS FOR A COMPLETE INSTALLATION. STANDARD COLOUR TO BE SELECTED BY ARCHITECT. MAXIMUM 4.88M (16FT) LENGTH OF TRACK REQUIRED. INCLUDE JOINERS.
EXIT LIGHTS (SELF- POWERED)	BEGHELLI QRMSPLUMWOLR LUMACELL CAT. #LUMACELL-POW-FL-COL AMULTE CAT. #PALUMMHTBAT	12V/120V	LED 2.5 WATT (MAX.) 2 WATT (MAX.)DC	SURFACE	LED EXTRUDED ALUMINUM PICTOGRAM FIXTURE C/W GREEN FACE AND WHITE LEGEND. UNIVERSAL MOUNTING TO SUIT WALL, END OR CEILING, MAXIMUM 63mm (2.5") THICKNESS AND 12V INTERNAL SEALED RECHARGEABLE BATTERY PROVIDING MINIMUM 30 MINUTES OF EMERGENCY POWER
EMERG. BATT. (SELF- POWERED TROFFER)	BEGHELLI TEMPESTA SERIES: EM-1 #1A-LED-EM-120-S-90SP (SURFACE CEILING MOUNT) OR APPROVED EQUALS BY: LUMACELL STANPRO AMULTE CAT. #EMUL SERIES	120V	17W	SURFACE	VANDAL RESISTANT LONG LIFE, SEALED BATTERY, C/W 17W LED MODULES, POLYCARBONATE BODY AND 90 MINUTE BATTERY DURATION

NOTES:  
 ① LED LUMEN VALUES QUOTED FOR FIXTURES ARE TO BE CONSIDERED MINIMUM, AND AS ABSOLUTE OR DELIVERED LUMENS. LUMEN VALUES SHOULD NOT EXCEED MORE THAN 10% OF SPECIFIED OUTPUT.  
 ② EQUAL MANUFACTURERS/SUPPLIERS MUST CONFIRM THE PROPOSED FIXTURE BY EMAIL WITH CONSULTANTS OFFICE A MINIMUM OF 10 DAYS PRIOR TO TENDER CLOSE.  
 ③ FIXTURE MUST HAVE A FIRE RATED TROFFER COVER INSTALLED AS NOTED ON RENOVATION DRAWING AND FIXTURE MUST BE IC (INSULATION CONTACT) RATED (DUE TO THE FIRE RATED COVER).

EQUIPMENT WIRING SCHEDULE										E-ELECTRICAL M-MECHANICAL O-OTHERS	
Electrical Item	Description	Provided By	Voltage	Size	Phase	Starter	Control Device	Isolating Device	Remote Items	Interlock	Remarks
1	HORIZONTAL UNIT VENTILATOR (UV-1)	M	120	6.3 MCA	1						CLASSROOM 10
2	CEILING MTD. UNIT VENTILATOR (UV-2)	M	120	6.3 MCA	1						ALCOVE 101E
3	HORIZONTAL UNIT VENTILATOR (UV-3)	M	120	6.3 MCA	1						CLASSROOM 11
4	HORIZONTAL UNIT VENTILATOR (UV-4)	M	120	6.3 MCA	1						CLASSROOM 12
5	CEILING MTD. UNIT VENTILATOR (UV-5)	M	120	6.3 MCA	1						CLASSROOM 13
6	HORIZONTAL UNIT VENTILATOR (UV-6)	M	120	6.3 MCA	1						CLASSROOM 9
7	HORIZONTAL UNIT VENTILATOR (UV-7)	M	120	6.3 MCA	1						ALCOVE 201E
8	CEILING MTD. UNIT VENTILATOR (UV-8)	M	120	6.3 MCA	1						CLASSROOM 8
9	HORIZONTAL UNIT VENTILATOR (UV-9)	M	120	6.3 MCA	1						CLASSROOM 7
10	HORIZONTAL UNIT VENTILATOR (UV-10)	M	120	6.3 MCA	1						ALCOVE 202E
11	CEILING MTD. UNIT VENTILATOR (UV-11)	M	120	6.3 MCA	1						CLASSROOM 6
12	HORIZONTAL UNIT VENTILATOR (UV-12)	M	120	6.3 MCA	1						CLASSROOM 5
13	HORIZONTAL UNIT VENTILATOR (UV-13)	M	120	6.3 MCA	1						ALCOVE 203E
14	CEILING MTD. UNIT VENTILATOR (UV-14)	M	120	6.3 MCA	1						CLASSROOM 4
15	EXHAUST FAN EF-1	M	120	FHP	1			E			
16	EXHAUST FAN EF-2	M	120	FHP	1			E			
17	CEILING CASSETTE (AC-1)	M	120	1.0 MCA	1			E	E	E	18 M SEMINAR A131
18	CONDENSING UNIT (CU-1)	M	120	9.1 MCA	1			E	E	E	17 M
19	URINAL CONTROL PANEL	M	120	FHP	1			E			
20	ELEVATOR SIMPLEX PUMP	M	208	1/2 HP	3			E	E	E	WIRE PUMP AND FLOATS THRU CONTROL PANEL. PROVIDE RECEPTACLE FOR HIGH LEVEL ALARM

NOTES:  
 1. INDICATES REPLACEMENT UV HAVING SIMILAR POWER REQUIREMENTS TO DEMOLISHED UNIT. CONNECT TO EXISTING CIRCUIT OF DEMOLISHED UNIT.

ELECTRICAL SYMBOLS		NOTE: ALL SYMBOLS MAY NOT BE USED	
LIGHTING		POWER	
[Symbol]	LIGHT FIXTURE TYPE AS INDICATED	[Symbol]	WALL MOUNTED RECEPTACLE (15A-120V)
[Symbol]	WALL MOUNTED EXIT LIGHT SHADING INDICATES FACE	[Symbol]	WALL MOUNTED T-SLOT RECEPTACLE (20A-120V)
[Symbol]	CEILING MOUNTED EXIT LIGHT ARROWS DENOTE DIRECTION SHADING INDICATES FACE	[Symbol]	DIRECT CONNECTION
[Symbol]	SINGLE OR TWIN EMERGENCY LIGHTING FIXTURE	[Symbol]	JUNCTION BOX
[Symbol]	BATTERY UNIT WITH INTEGRAL EMERGENCY FIXTURE (DM-X INDICATES BATTERY UNIT TYPE)	[Symbol]	PANEL AS INDICATED
[Symbol]	SINGLE POLE SWITCH (3-3 WAY, 4-4 WAY, PULL/TOGGLE LIGHT, K-W/LED, DM=DIMMER, M=MOTOR RATED)	[Symbol]	DESTRATIFICATION FAN
[Symbol]	OCCUPANCY SENSOR (PASSIVE)	[Symbol]	SURFACE RACEWAY C/W DEVICES AS NOTED (REFER TO SPECIFICATION)
[Symbol]	DIGITAL CEILING MOUNTED MOTION SENSOR	[Symbol]	HAND DRYER
[Symbol]	DIGITAL ROOM CONTROLLER	[Symbol]	EXHAUST FAN
[Symbol]	DIGITAL WALL STATION, 'X' DENOTES NUMBER OF CONTROL BUTTONS IN SINGLE GANG	[Symbol]	TRANSFORMER
[Symbol]	LINE VOLTAGE RELAY PACK	ER	INDICATED EXISTING ITEM TO REMAIN
FIRE ALARM		D	INDICATES EXISTING ITEM TO BE DELETED
[Symbol]	SMOKE DETECTOR (RL=RELAY BASE)	R	INDICATES EXISTING ITEM TO BE RELOCATED/N RELOCATED POSITION
[Symbol]	PULLSTATION	GF	GROUND FAULT
[Symbol]	ALARM BELL (A, B = SIGNAL CIRCUIT)	WP	WEATHERPROOF
COMMUNICATIONS		CLG	CEILING MOUNTED
[Symbol]	SINGLE COMPUTER OUTLET ROUGHIN C/W BLANK FACE PLATE AND 1" (27mm) C TO HANGER SYSTEM IN NEAREST CORRIDOR CEILING SPACE.	[Symbol]	NOTE INDICATOR
[Symbol]	COMBINATION SINGLE VOICE/ SINGLE COMPUTER OUTLET C/W BLANK FACE PLATE AND 1" (27mm) C TO HANGER SYSTEM IN NEAREST CORRIDOR CEILING SPACE.	[Symbol]	MECHANICAL ITEM NO.
[Symbol]	CEILING MOUNTED SPEAKER		
[Symbol]	TOPCAT ASSISTIVE LISTENING WIRELESS AUDIO BASE STATION/SPEAKER		
[Symbol]	HDMI AND 3.5mm AUDIO INPUTS (N SINGLE GANG BOX)		

NEW PANEL 'LPA'		* INDICATES 33mA GROUND FAULT STYLE BREAKER	
VOLTAGE: 120/208 VOLTS PHASE: 3P, 4W MANS: 222A NEUTRAL BUS: FULL MOUNTING: SURFACE			
HEATING PLANT LIGHTS	15A 1	2	15A GIRLS & BOYS WR LIGHTS
CUSTODIAN & STORAGE LIGHTS	15A 3	4	15A PLANNING LIT & LIVE WIRE FOR REC.
CORRIDOR REC. / LIGHTS	15A 5	6	15A 101A LIGHTS
CORRIDOR REC. / LIGHTS	15A 7	8	15A SPARE
CORRIDOR REC. / LIGHTS	15A 9	10	15A SPARE
EXISTING LOAD	15A 11	12	15A 101C LIGHTS
101B/D LIGHTS	15A 13	14	15A 101C SPARE
101A/B REC.	15A 15	16	15A 101C REC.
AIR FAN & REMOTE XFORMER	15A 17	18	15A REFERENCE LIGHTS
REF. LIGHTS & CABLE REC.	15A 19	20	15A STAIR NO.1 LIGHTS
101A REC.	15A 21	22	15A STAIR NO.1 UNIT HEATER
101A REC. & 101C UNIT HEATER	15A 23	24	15A HOT WATER CIRCULATION PUMP
101B UNIT HEATER #10	15A 25	26	15A CORRIDOR REC. / PHONE REC.
101C REC.	15A 27	28	15A BOYS WR POWER SINK/EMERG LIGHT
EMERGENCY LIGHTS	15A 29	30	15A BOYS & GIRLS & STORAGE REC.
LIBRARY COLUMN REC.	15A 31	32	15A GIRLS WR REC/ & POWER SINK
JIFFY POLE ROOM 101B	15A 33	34	15A LIBRARY
SECURITY	15A 35	36	15A LIBRARY
EXISTING LOAD	15A 37	38	15A EXISTING LOAD
LIBRARY DOOR OPERATOR	15A 39	40	2P
LIBRARY DOOR OPERATOR	15A 41	42	15A EF-1 SPRINKLER ROOM
VESTIBULE DOOR OPERATOR	15A 43	44	15A EF-2 ELEVATOR MACHINE ROOM
ELEVATOR CAB LIGHTING DISC.	15A 45	46	15A ELEVATOR SUMP PIT RM REC.
ELEVATOR PIT REC./LIGHT	15A 47	48	15A BF WR 108 DOOR OPERATOR
ELEVATOR MACH./SUMP RM. LIT.	15A 49	50	15A RESOURCE 101B DOOR OPERATOR
JURNAL TANK OP (CUST. 10A)	15A 51	52	15A BOYS/GIRLS WR FSD AT DOOR
SUMP PIT ROOM FSD AT DOOR	15A 53	54	15A PUMP HIGH LEVEL ALARM REC.
EF-1 SUMP PIT RM.	15A 55	56	15A ELEVATOR SIMPLEX PUMP
WASHROOM 106/109 DOOR HOLDERS	15A 57	58	
SPARE	20A 59	60	3P
SPARE	15A 61	62	15A ELEVATOR MACH. RN. REC.
SPARE	15A 63	64	15A SPARE
SPARE	65	66	SPACE
SPARE	67	68	SPACE
SPARE	69	70	SPACE
SPARE	71	72	SPACE

NOTE: THE INDICATED PANEL ASSEMBLY MUST HAVE AN INTERRUPTING CAPACITY OF 10000 A. PROVIDE BY EITHER FULLY RATED BREAKERS OR INTEGRATED EQUIPMENT RATING WITH THE UPSTREAM BREAKER.

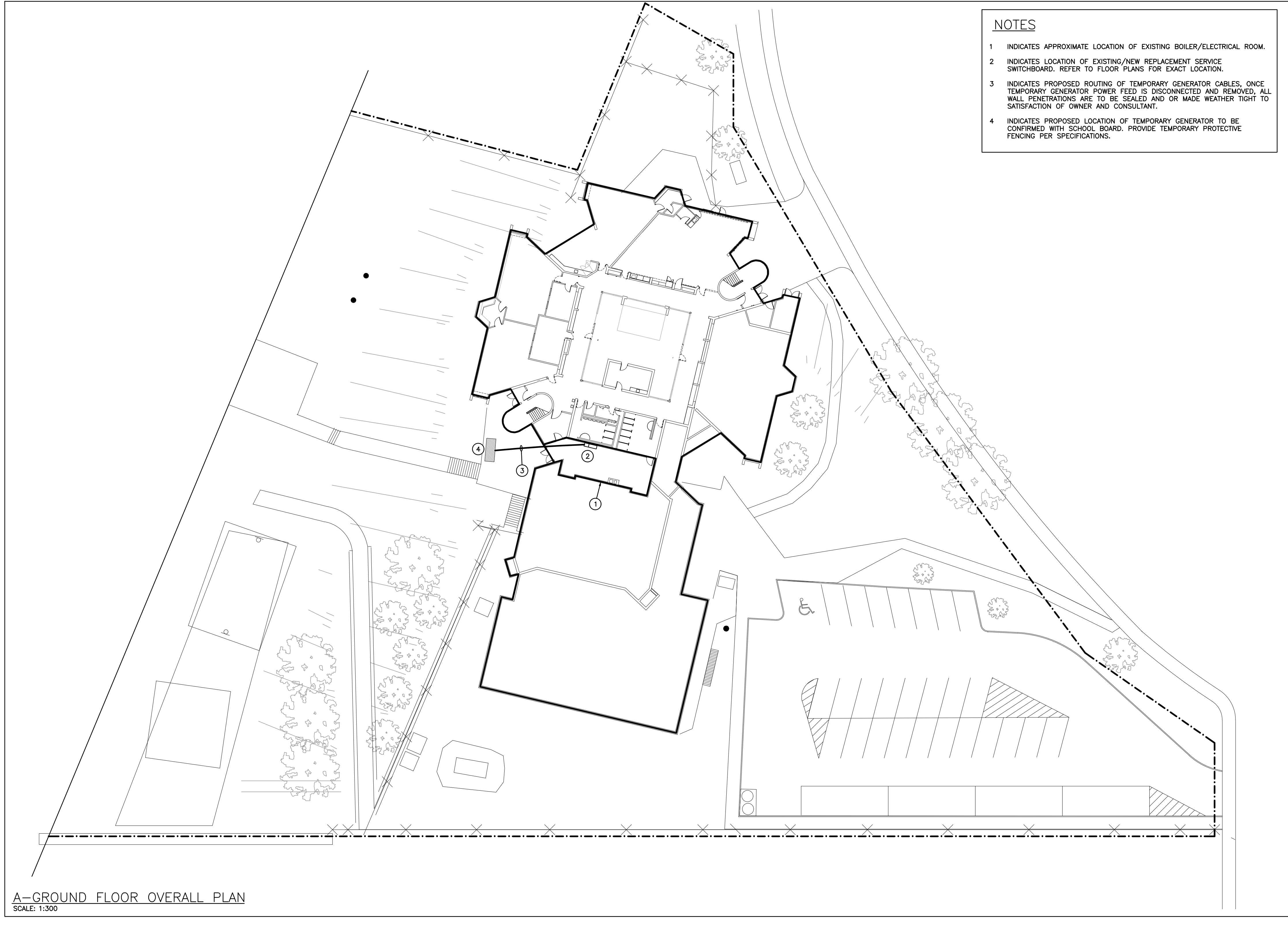

A-GROUND FLOOR OVERALL PLAN  
SCALE: 1:300

NOTES  
 1. INDICATES APPROXIMATE LOCATION OF EXISTING BOILER/ELECTRICAL ROOM.  
 2. INDICATES LOCATION OF EXISTING/NEW REPLACEMENT SERVICE SWITCHBOARD. REFER TO FLOOR PLANS FOR EXACT LOCATION.  
 3. INDICATES PROPOSED ROUTING OF TEMPORARY GENERATOR CABLES. ONCE TEMPORARY GENERATOR POWER FEED IS DISCONNECTED AND REMOVED, ALL WALL PENETRATIONS ARE TO BE SEALED AND OR MADE WEATHER TIGHT TO SATISFACTION OF OWNER AND CONSULTANT.  
 4. INDICATES PROPOSED LOCATION OF TEMPORARY GENERATOR TO BE CONFIRMED WITH SCHOOL BOARD. PROVIDE TEMPORARY PROTECTIVE FENCING PER SPECIFICATIONS.

**DEI**  
Consulting Engineers Inc.  
MECHANICAL, ELECTRICAL & PLUMBING  
55 Northland Road, Waterloo, ON N2V 1Y8  
Phone: 519-755-3555  
Website: deiassociates.ca  
Project Number: 21178

The contractor shall verify all dimensions and report all errors and discrepancies to the Consultant before commencement of the work. The drawings show general arrangement of services. Follow as closely as actual building construction will permit. Obtain approval for relocation of services from Consultant before commencement of the work. The drawings do not indicate all offsets fitting and accessories which may be required. Provide the same to meet the required conditions. Drawings and specifications, etc., prepared and issued by the consultant are the property of the consultant and must be returned at the completion of the project. These documents are not to be duplicated or copied without the consent of the Consultant. © 2022 DEI & Associates Inc.

**HOSSACK & ASSOCIATES ARCHITECTS**

4-210 DUNDAS STREET WEST  
WATERLOO, ONTARIO N2L 2R8  
TEL: (519) 867-8234 FAX: (519) 867-6300

NO.	DESCRIPTION	DATE
3	ADDENDUM	01/09/23
2	ISSUED FOR TENDER	12/12/22
1	ISSUED FOR TENDER REVIEW	11/17/22

Certificate of Practice # 4292

**CENTRAL PUBLIC SCHOOL - ACCESSIBILITY UPGRADE**

175 Main St. Cambridge, ON N1R 1W5

**Waterloo Region District School Board**

**SCHEDULES, LEGEND AND KEY PLAN**

SCALE	PROJECT
As indicated	20118
DATE	DRAWING
DECEMBER 2022	E01
CHECKED	REVISION
	2022-12-12
	T:\2019\1512102\Rev01.rvt